

Outil	Rouleau Lisse				
Date	11/02/2020	Version	1.0		page n° 1 / 3
Feuille	Vue d'ensemble				

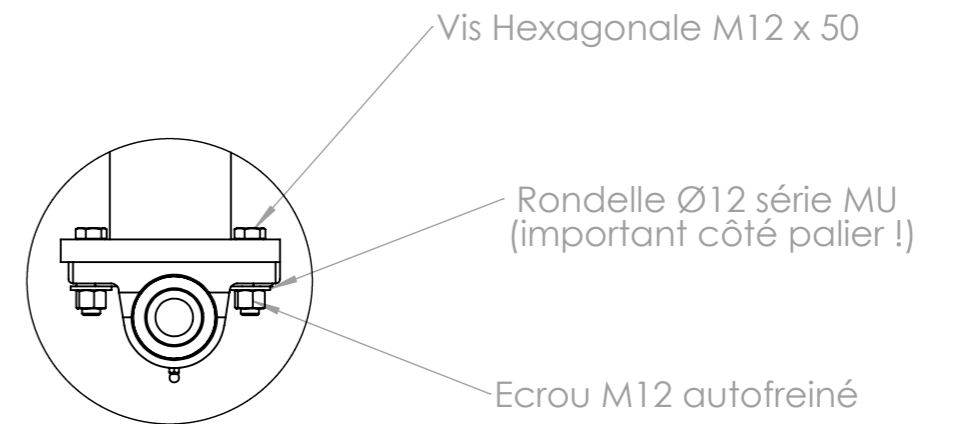

Poids total 112kg

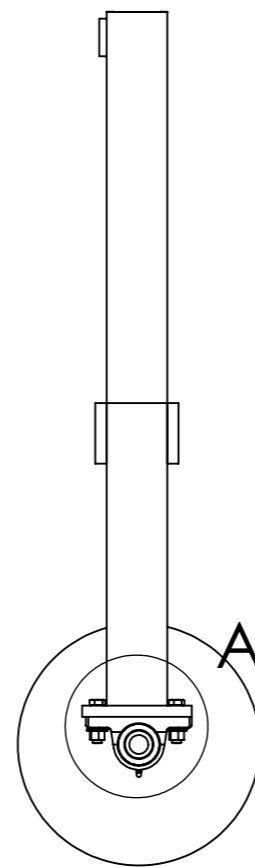
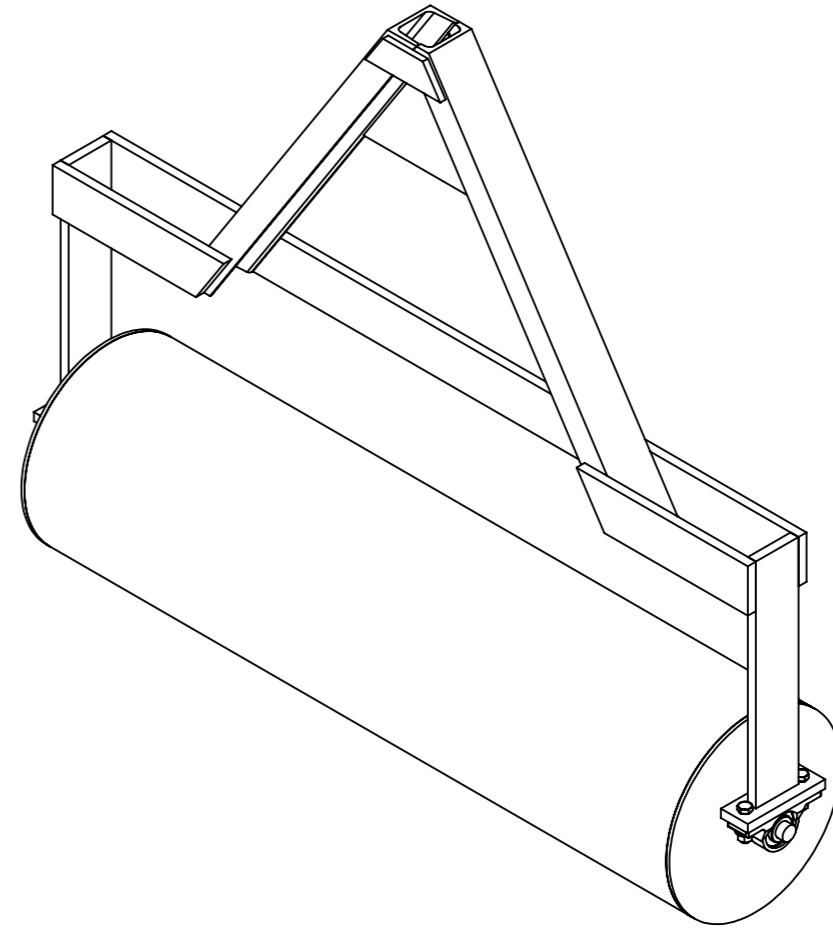
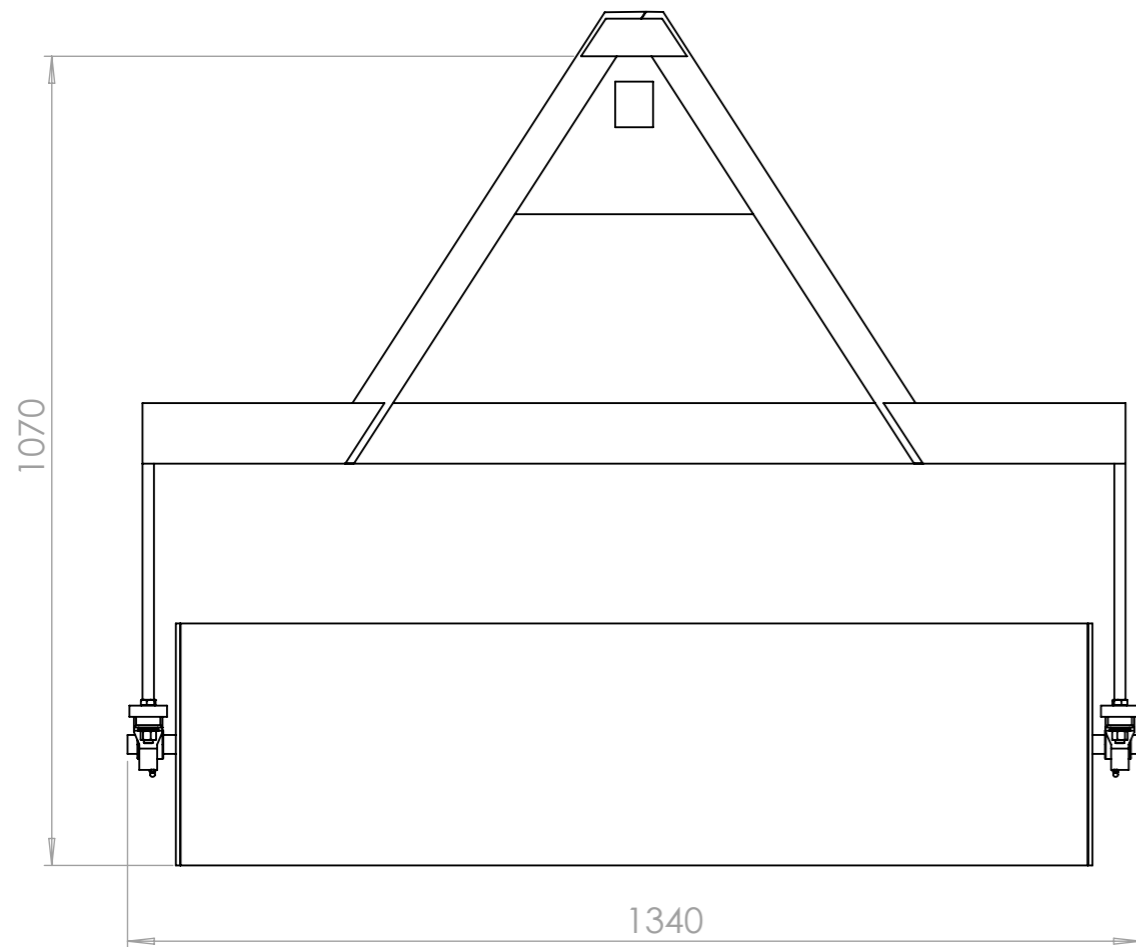

DÉTAIL A  
ECHELLE 1 : 5

rep	Désignation	Qté
A	Châssis (A)	1
Ecou	Ecou M12 autofreiné	4
Vis Hexagonale	Vis Hexagonale M12 x 50	4
Rondelle	Rondelle Ø12 série MU	4
G	Rouleau lisse (G)	1
Palier Ø25	Palier chapeau Ø25	2

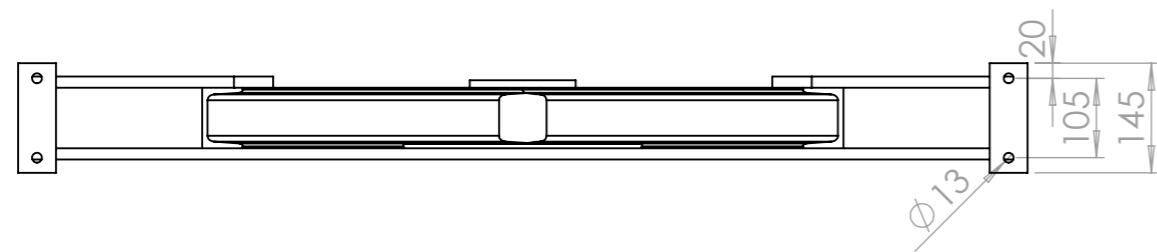
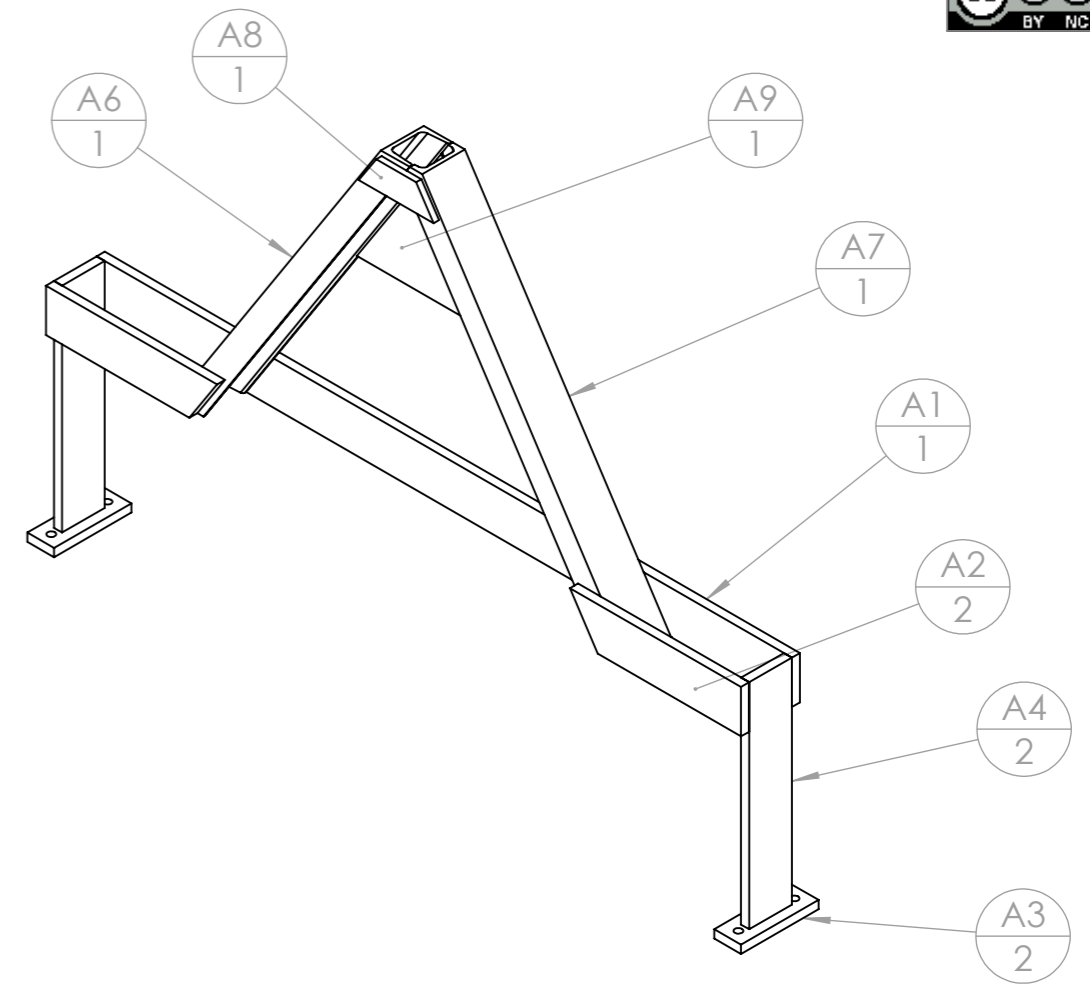
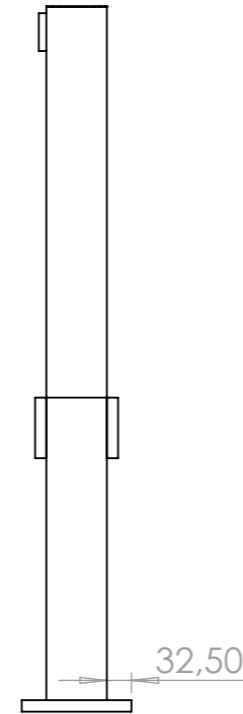
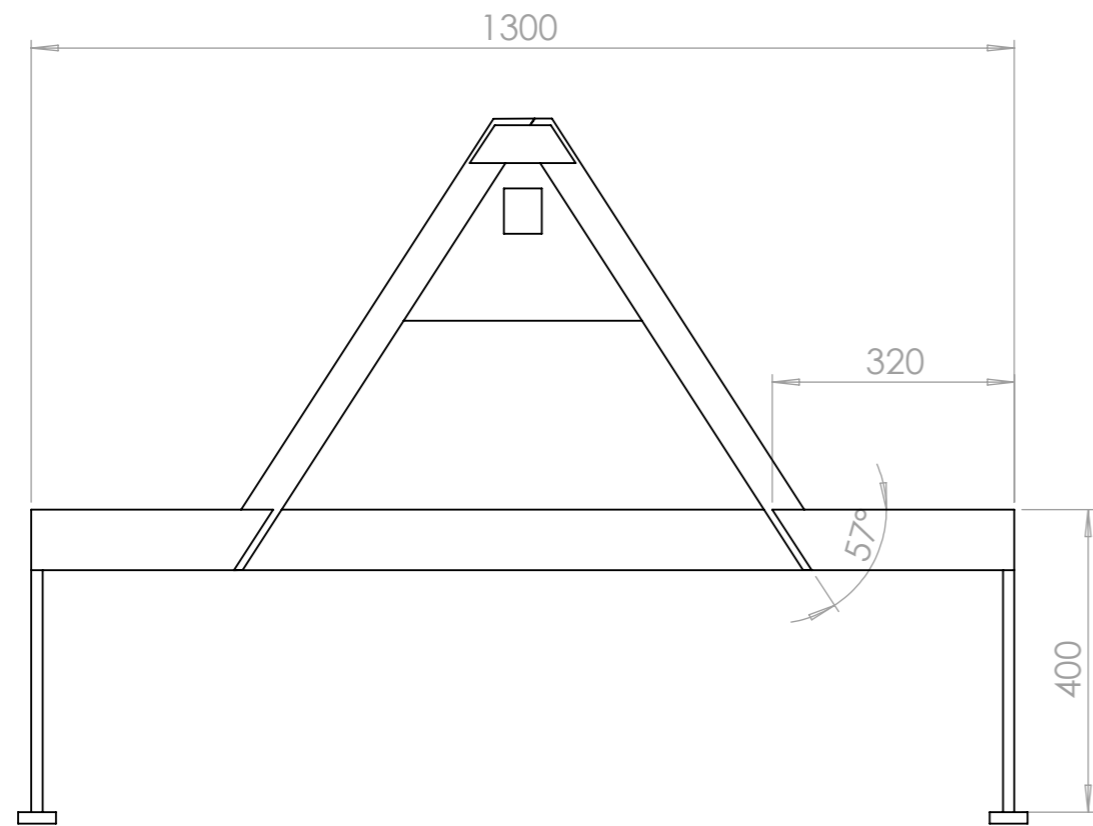

rep	Désignation	ANGLE1	ANGLE2	p	Long.	Qté
A1	Fer plat 80 x 15				1300	1
A2	Fer plat 80 x 15	33°			320	2
A4	Fer plat 80 x 15			17	400	2
A9	Tôle triangle intérieure					1
A8	Fer plat 50 x 10	33.27	33.28		140	1
A3	Fer plat 50 x 15	0.00	0.00		145	2
A6	UPN 80 x 45	33.27	33.00		740	1
A7	UPN 80 x 45	-	-		723	1

Outil	Rouleau Lisse				
Date	11/02/2020	Version	1.0		page n° 3 / 3
Feuille	G - Rouleau				

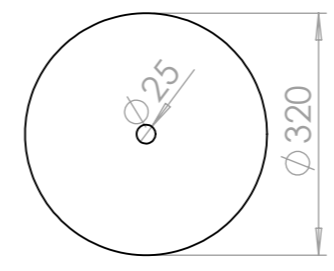
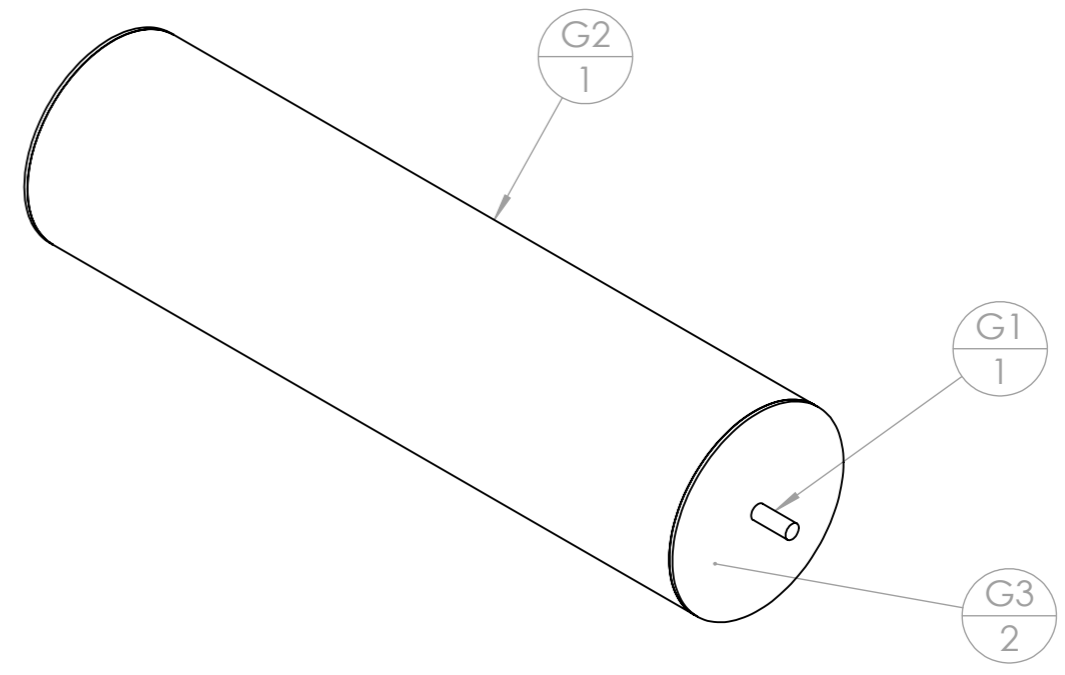

rep	Désignation	ANGLE1	ANGLE2	p	Long.	Qté
G1	étiré rond Ø25				1340	1
G3	Disque Ø320 épaisseur 6					2
G2	tube rond 323.9 x 6	0.00	0.00		1200	1