

| Pièce | Désignation | Qté |
|----------------|----------------------------|-----|
| A | châssis | 1 |
| J | Barre porte disque étroite | 1 |
| K | Etançon porte disque | 2 |
| Vis Hexagonale | Vis hexagonale M16 x 35 | 8 |

DÉTAIL A
 ECHELLE 2:3

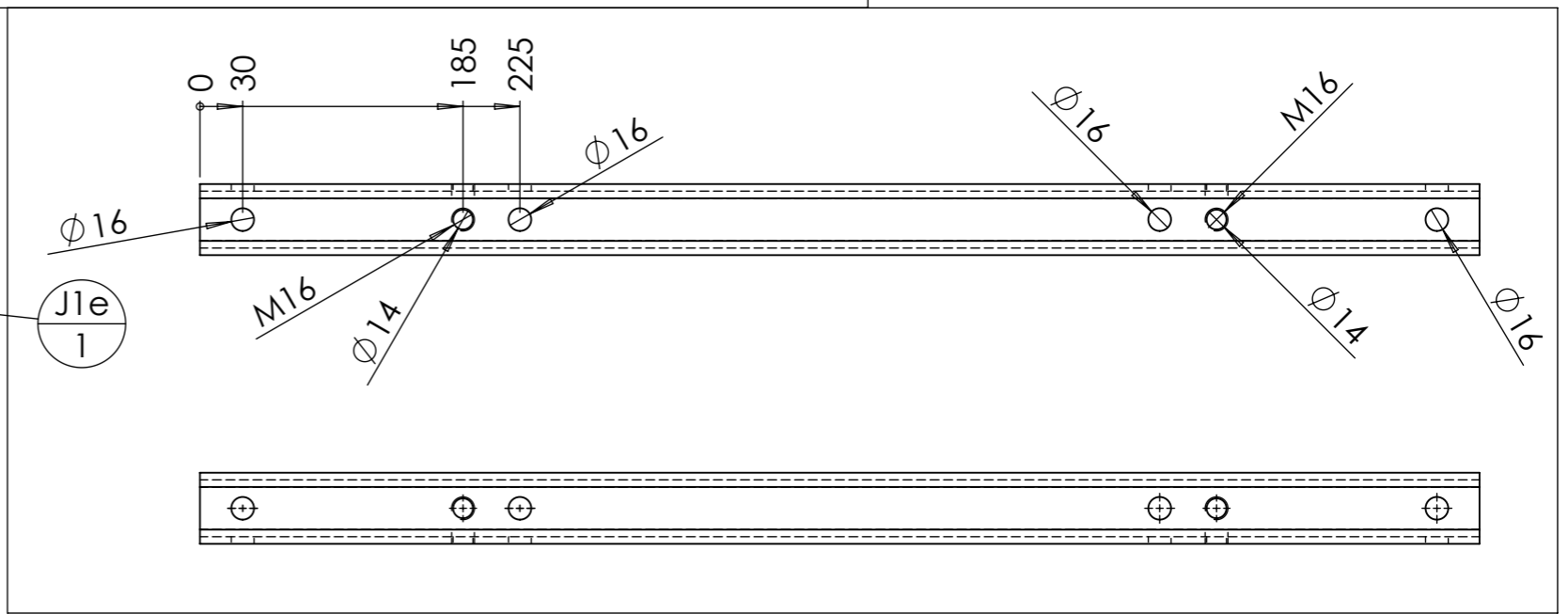

Trous $\varnothing 16$ servent aux soudures bouchons pour le soudage de J2 sur J1
 Procédure :
 - percer les 8 trous $\varnothing 16$ dans J1
 - souder J2
 - percer les trous $\varnothing 14$ dans J1+J2
 - tarauder les trous $\varnothing 14$ en M16.

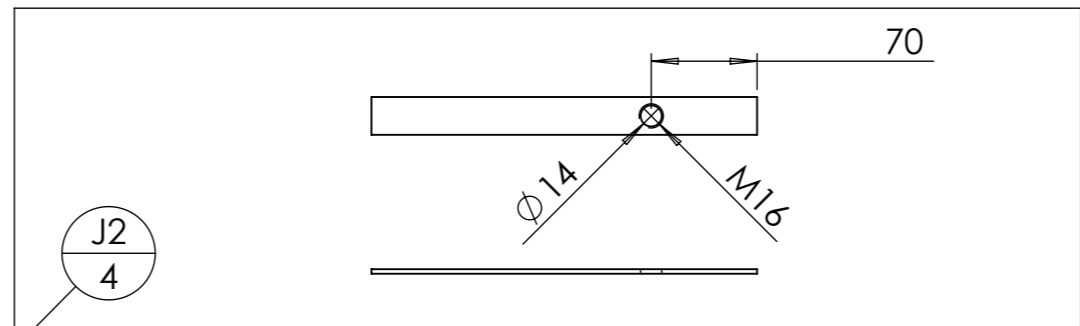
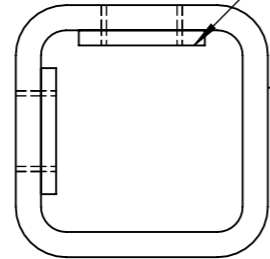
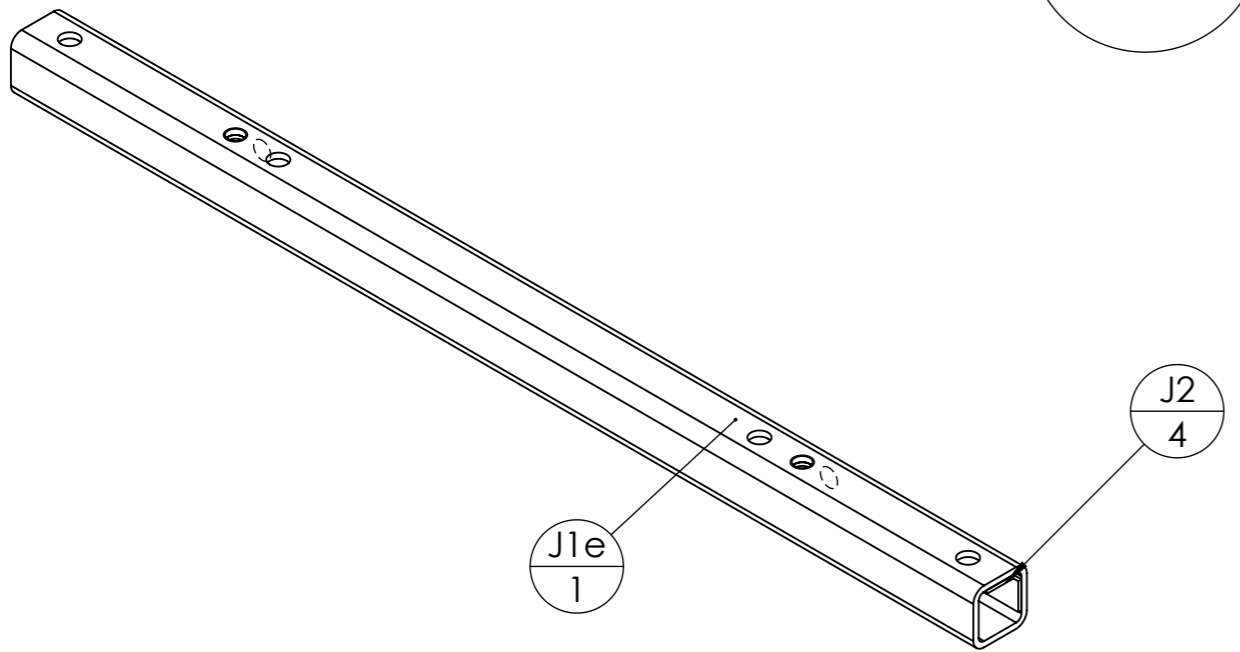
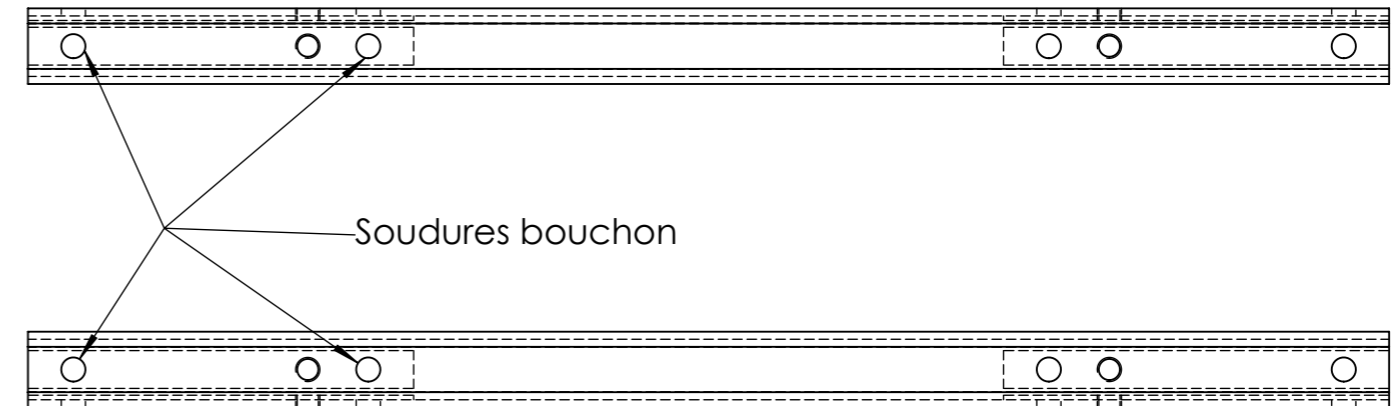
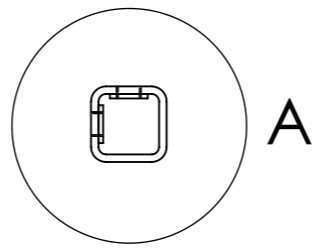

| repère | Désignation | ANGLE1 | ANGLE2 | p | LONGUEUR | Quantité |
|--------|----------------------------|--------|--------|--|----------|----------|
| J | Barre porte disque étroite | | | | | 1 |
| J1e | tube carré 50 x 5 | 0.00 | 0.00 | 8x $\varnothing 16$; 4x $\varnothing 14$; | 900 | 1 |
| J2 | fer plat 25 x 3 | 0.00 | 0.00 | 1x $\varnothing 14$; | 255 | 4 |

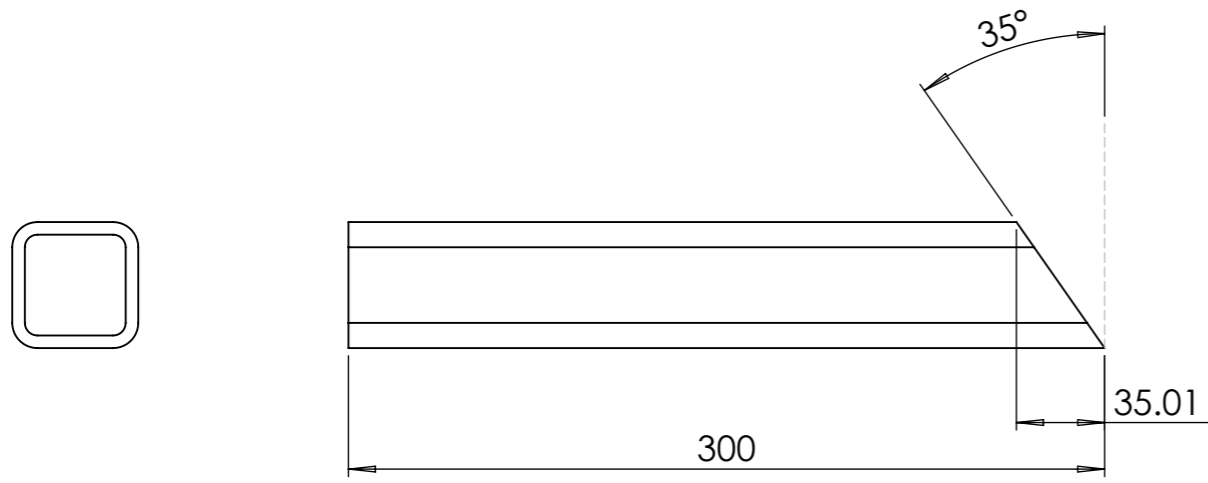

K2
1

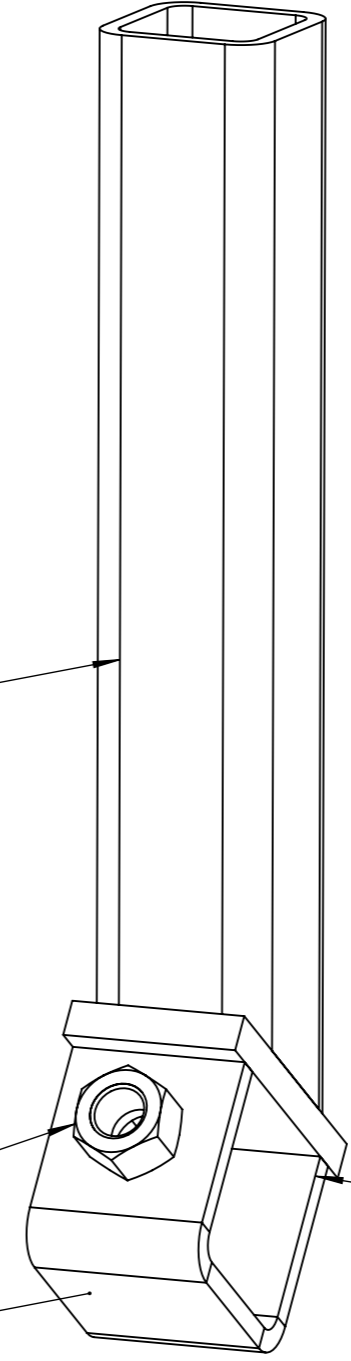

K1
1

K3
1

K4
1

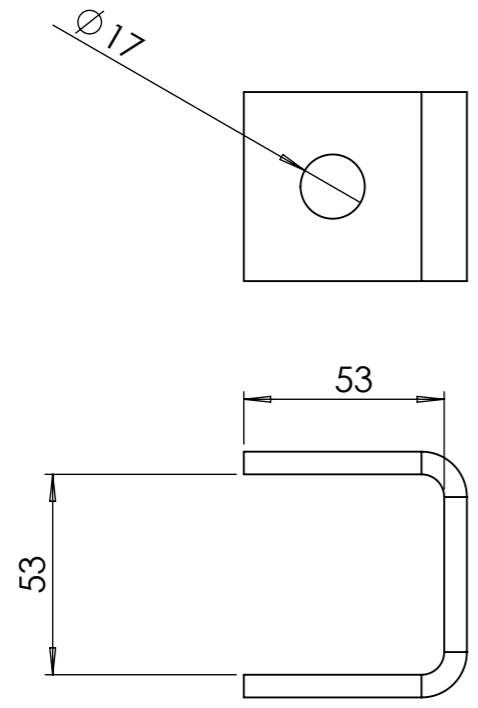
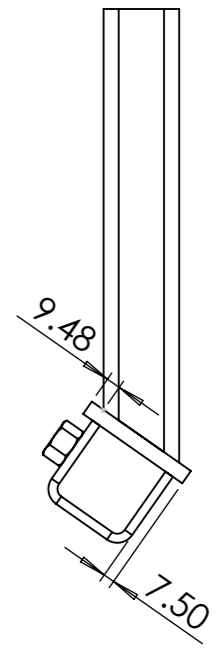

| ID | Description | ANGLE1 | ANGLE2 | p | Longueur | Qté |
|----|---------------------------------------|--------|--------|---|----------|-----|
| K2 | tube carré 50 x 5 | 35.00 | 0.00 | | 300 | 1 |
| K4 | K4 barre porte disque semoir viticole | | | | | 1 |
| K3 | Fer plat 80 x 10 | 0.00 | 0.00 | | 50 | 1 |
| K1 | Ecrou M16 brut | | | | | 1 |

| | | | | | |
|---------|---------------------------|---------|-----|--|---------------|
| Outil | Barre porte disque étroit | | | | |
| Date | 11/01/2023 | Version | 4.1 | | page n° 4 / 4 |
| Feuille | Fournitures étroite | | | | |

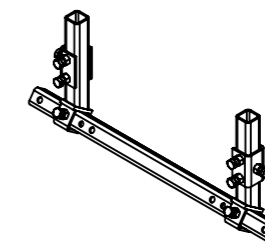

| repère | Désignation | ANGLE1 | ANGLE2 | p | LONGUEUR | Quantité |
|----------------|---|--------|--------|----------------------|----------|----------|
| Vis Hexagonale | Vis hexagonale M16 x 35 | | | | | 8 |
| A10 | Ecrou M16 brut | | | | | 6 |
| A23 | A23 descente barre porte disque semoir viticole | | | | | 2 |
| K2 | tube carré 50 x 5 | 35.00 | 0.00 | | 300 | 2 |
| K3 | Fer plat 80 x 10 | 0.00 | 0.00 | | 50 | 2 |
| K1 | Ecrou M16 brut | | | | | 2 |
| K4 | K4 barre porte disque semoir viticole | | | | | 2 |
| J1e | tube carré 50 x 5 | 0.00 | 0.00 | 8x Ø16 ; 4x Ø14 ; | 900 | 1 |
| J2 | fer plat 25 x 3 | 0.00 | 0.00 | 1x Ø14 ; | 255 | 4 |