

Version 2.2 Qté 1

Date 20/05/2015

Outil Presse à Typha

Pièce Nomenclature générale

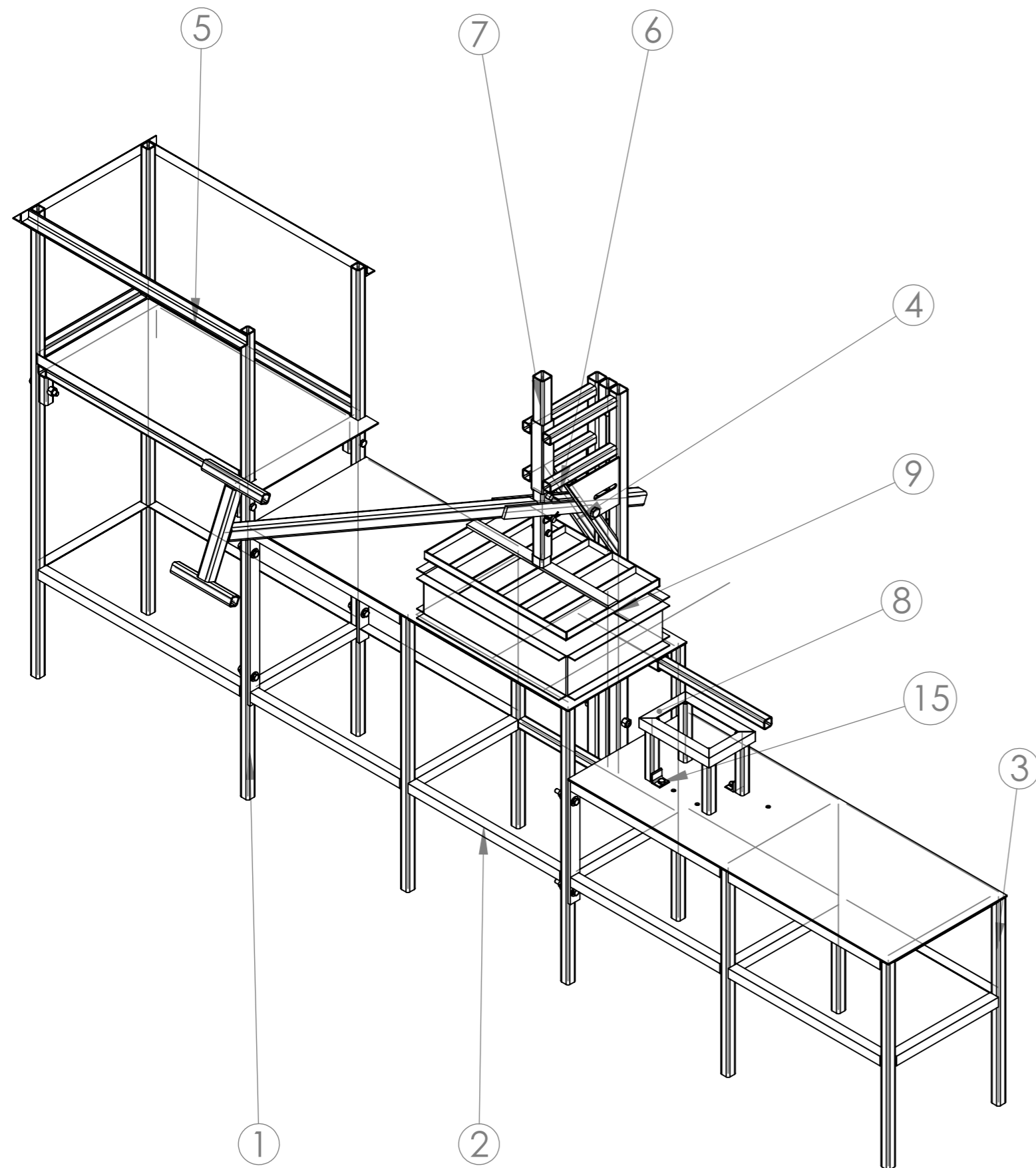

N°	Désignation	Qté
1	AA - Socle stockage mélange	1
2	AB - Table presse	1
3	AC - Table démoulage	1
4	AD - Potence Presse	1
5	AE - Plateau stockage mélange	1
6	B - Bras levier presse	1
7	C - Support de compression	1
8	D - Support Démoulage	1
9	P - Plateau de compression panneaux	1
10	étiré rond Ø16	1
11	tube carré 35 x 4	1
12	Pm - Moule Panneaux	1
13	Ecrou M12	12
14	Ecrou M14	6
15	Vis hexagonale M12 x 30	2
16	Vis Hexagonale M12 x 60	5
17	Vis Hexagonale M14 x 100	4
18	Tôle 3mm 596x396	1
19	Vis Hexagonale M16 x 160	3
20	Ecrou M16 (NON AUTOBLOQUANT)	1
21	Goupille épingle d'axe, 15x70 Ø4	2
22	rondelle Ø int 14 / Ø ext 30 / ep 2	16
23	Vis hexagonale M12 x 80	5
24	rondelle Ø int 17 / Ø ext 40 / ep 3	2
25	vis hexagonale M10 x 100	1
26	Ecrou M10	1

Version	2.2	Qté	1
Date	20/05/2015		
Outil	Presse à Typha		
Pièce	AA - Socle à mélange		

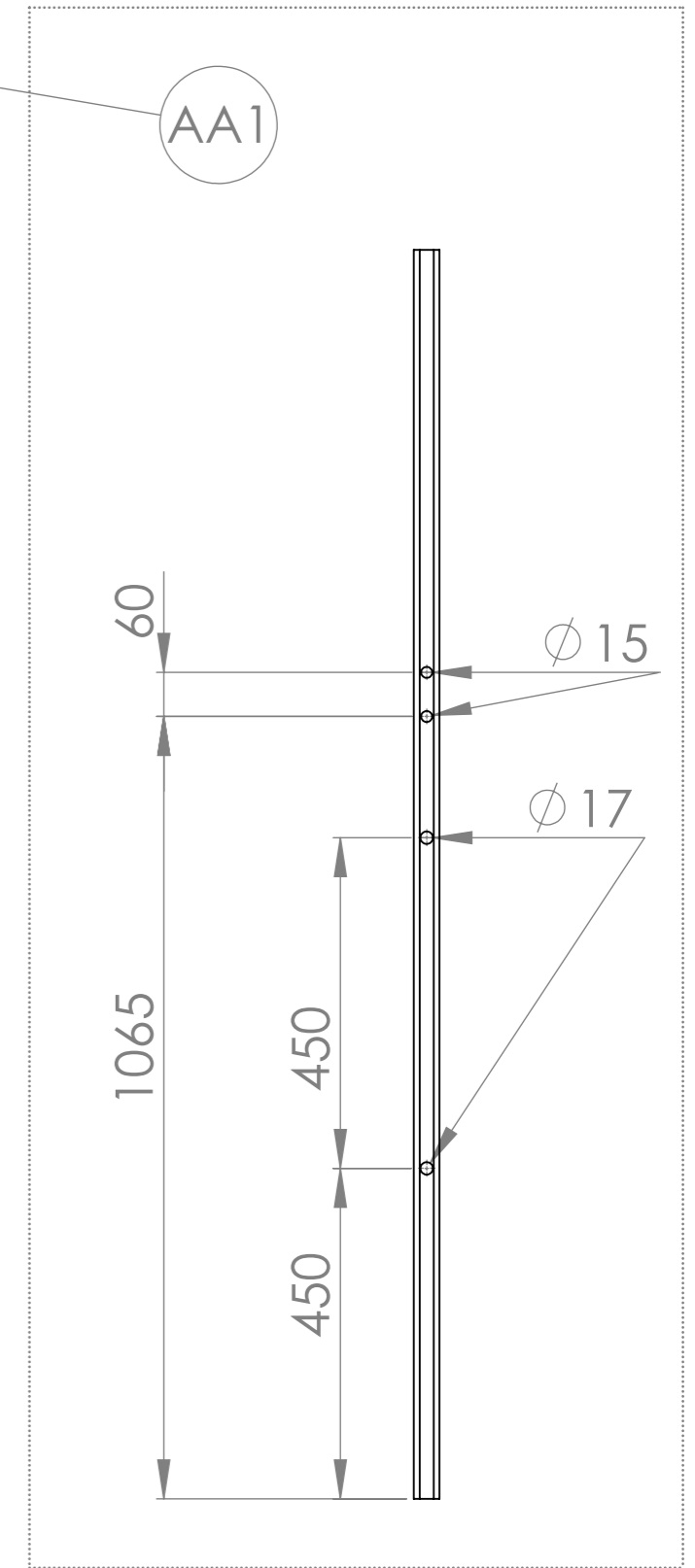
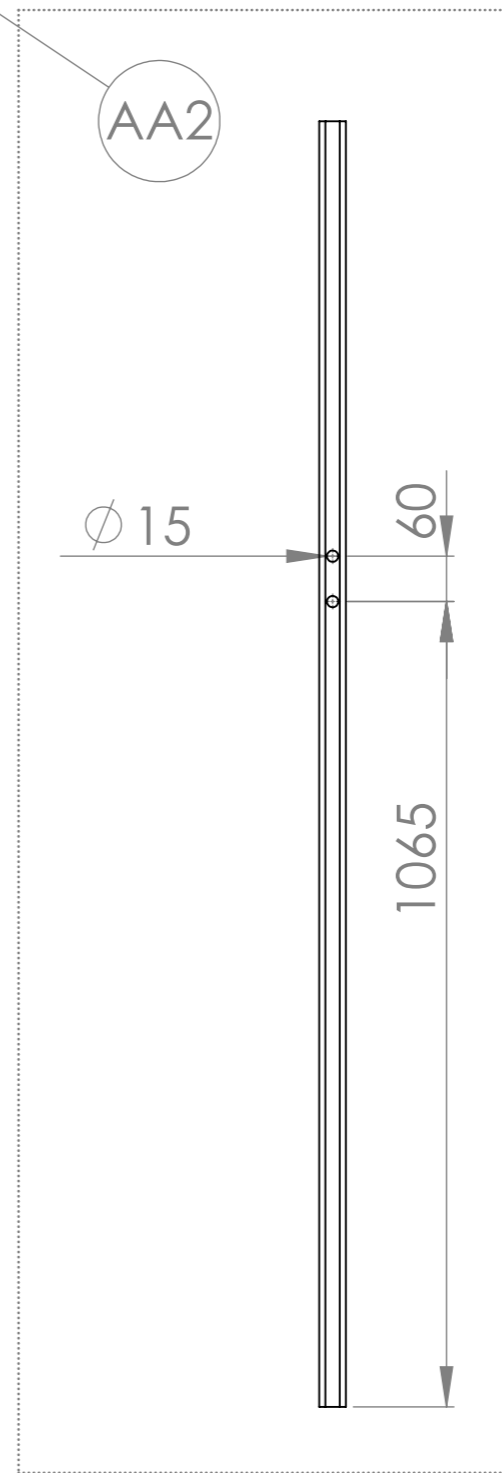
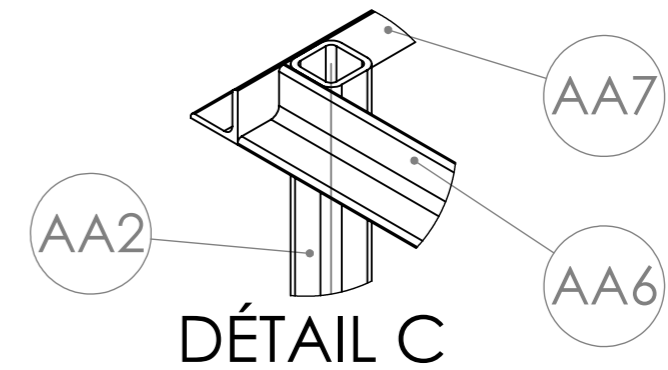
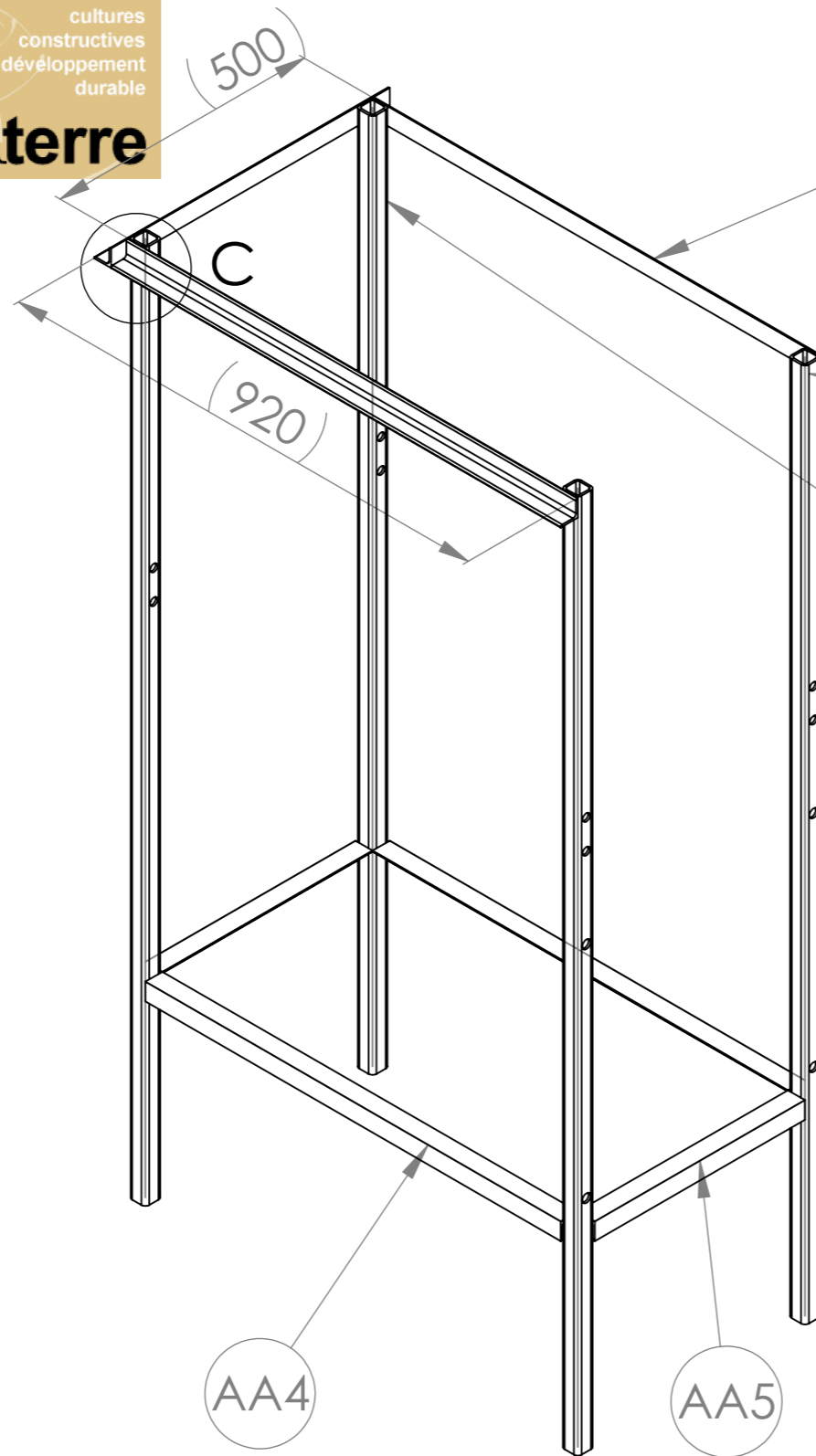
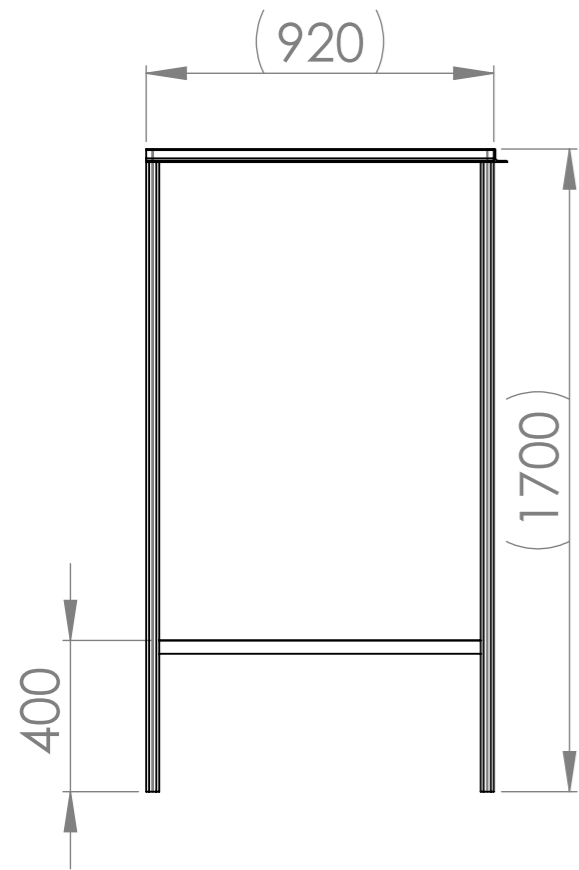

N°	Désignation	Longueur	Qté
AA1	tube carré 35 x 4	1700	2
AA2	tube carré 35 x 4	1700	2
AA4	Cornière 35 x 35 x 4	850	2
AA5	Cornière 35 x 35 x 4	430	2
AA6	Cornière 35 x 35 x 4	920	2
AA7	Cornière 35 x 35 x 4	570	1

Version	2.2	Qté	1
Date	20/05/2015		
Outil	Presse à Typha		
Pièce	AB - Table presse		

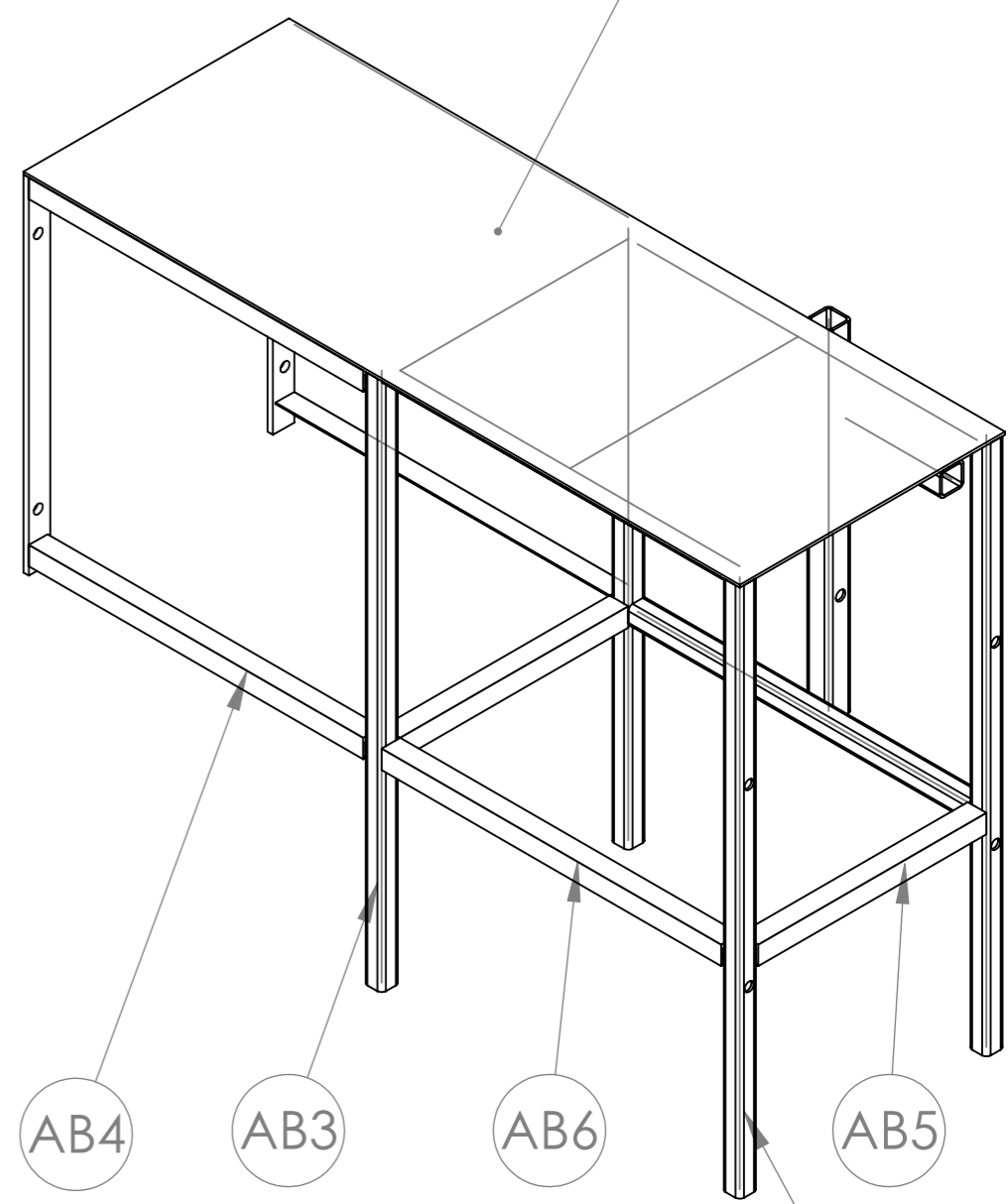
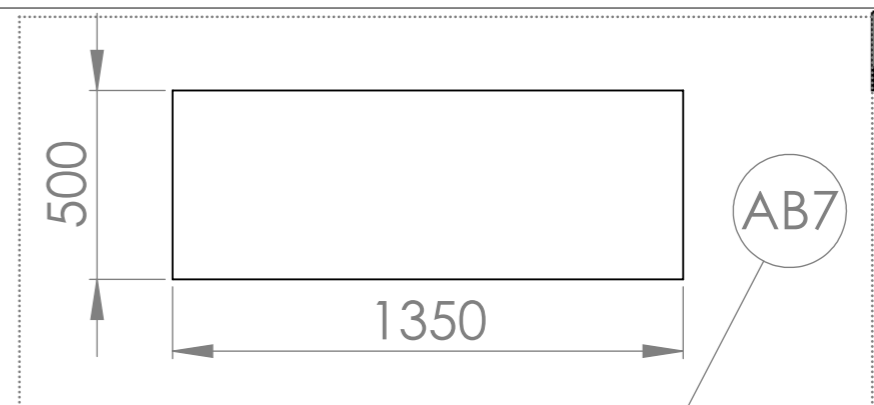
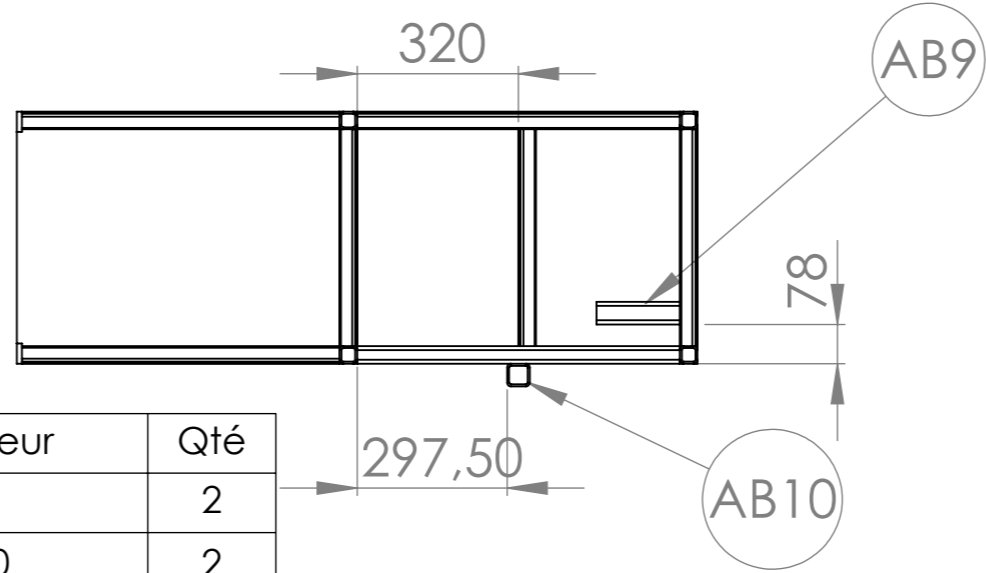
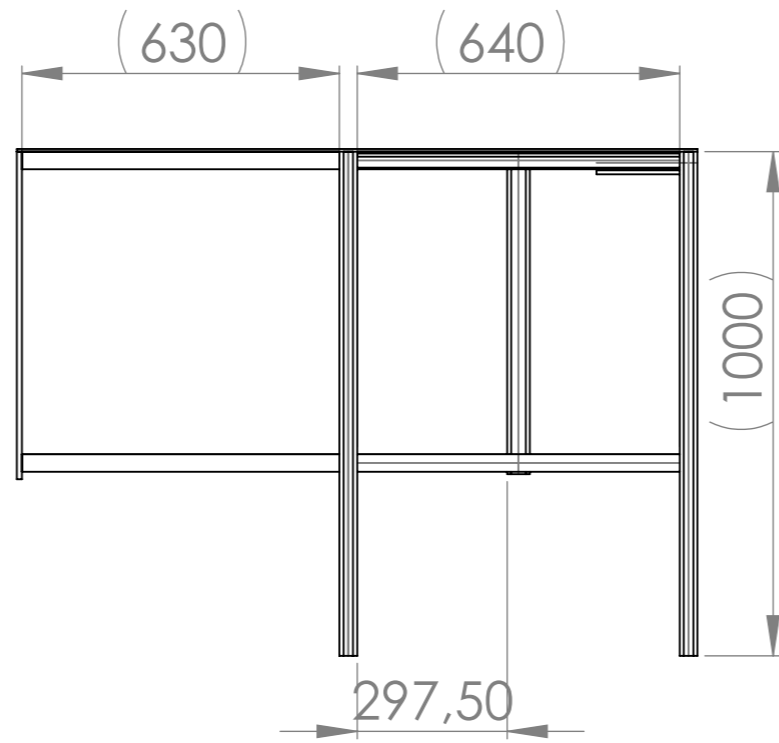
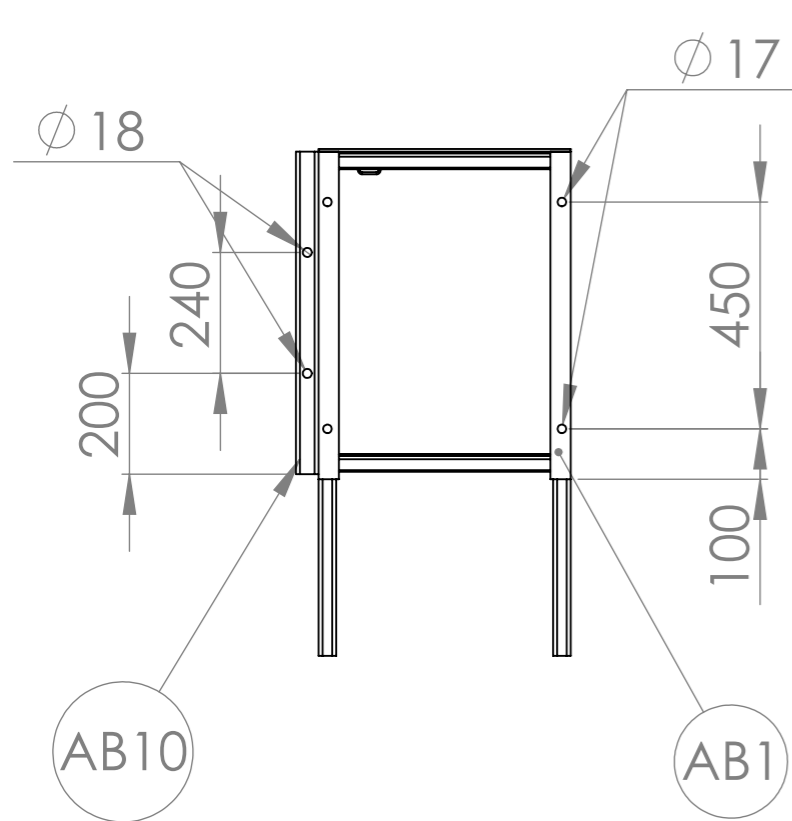

N°	Désignation	Longueur	Qté
AB1	Fer plat 40 x 10	650	2
AB2	tube carré 35 x 4	1000	2
AB3	tube carré 35 x 4	1000	2
AB4	Cornière 35 x 35 x 4	630	4
AB5	Cornière 35 x 35 x 4	430	4
AB6	Cornière 35 x 35 x 4	640	2
AB7	Tôle 5mm		1
AB8	tube carré 35 x 4	640	2
AB9	tube carré 45 x 4	200	1
AB10	tube carré 45 x 4	640	1

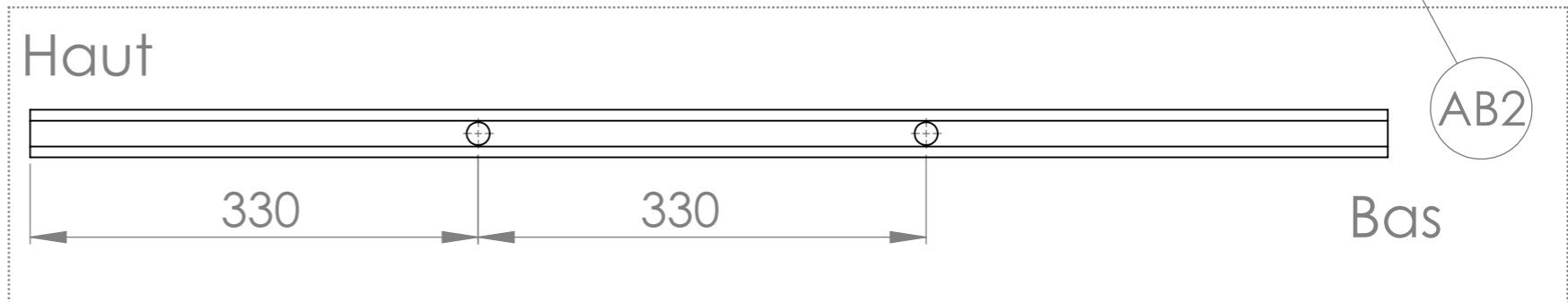

Version	2.2	Qté	1
Date	20/05/2015		
Outil	Presse à Typha		
Pièce	AC - Table démoulage		

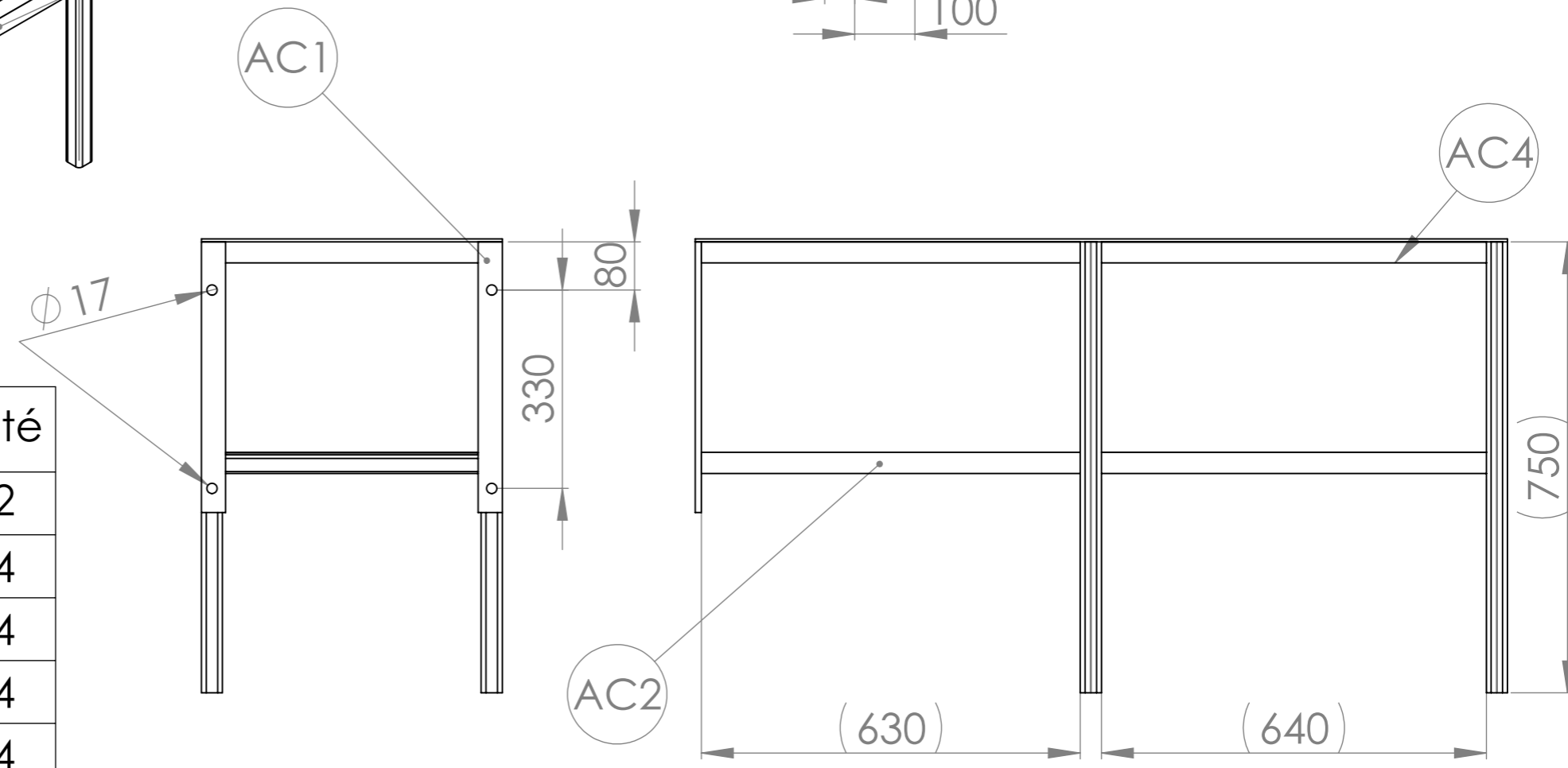
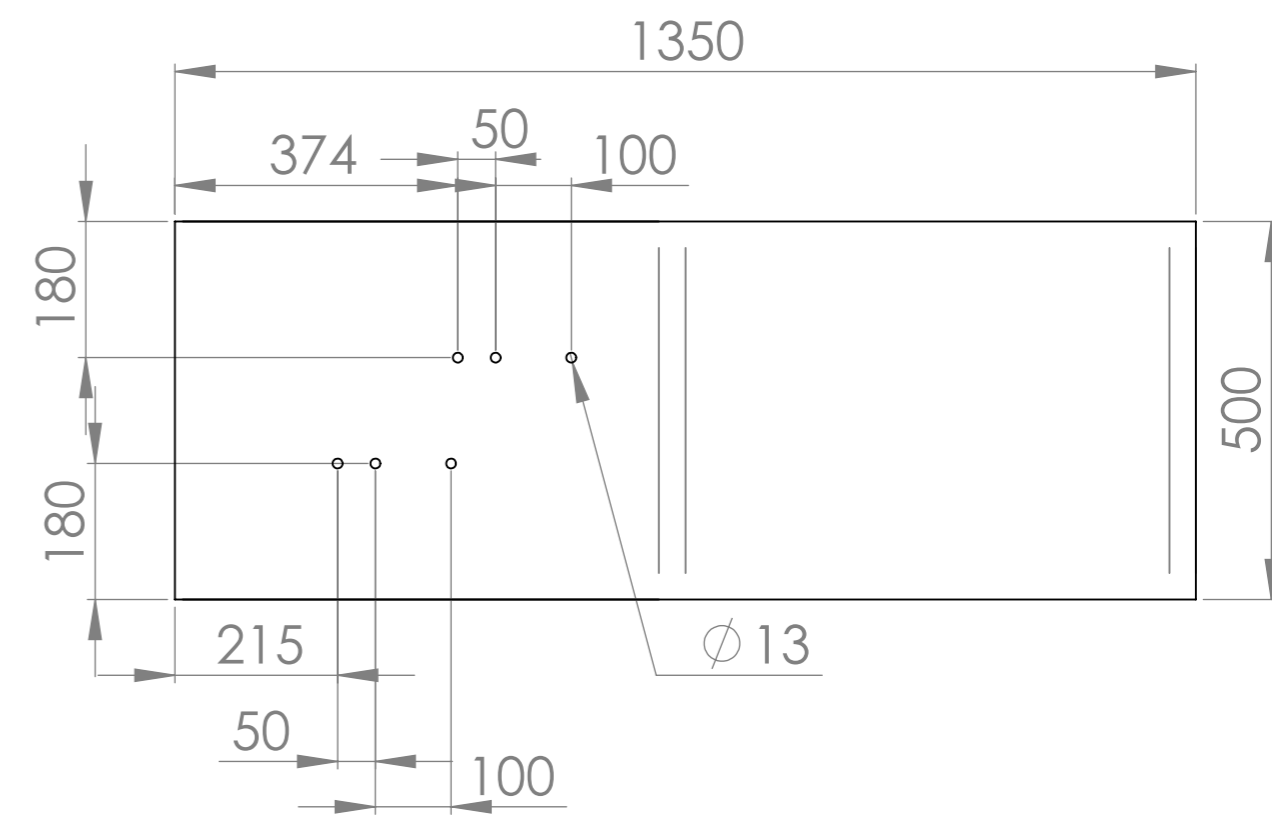
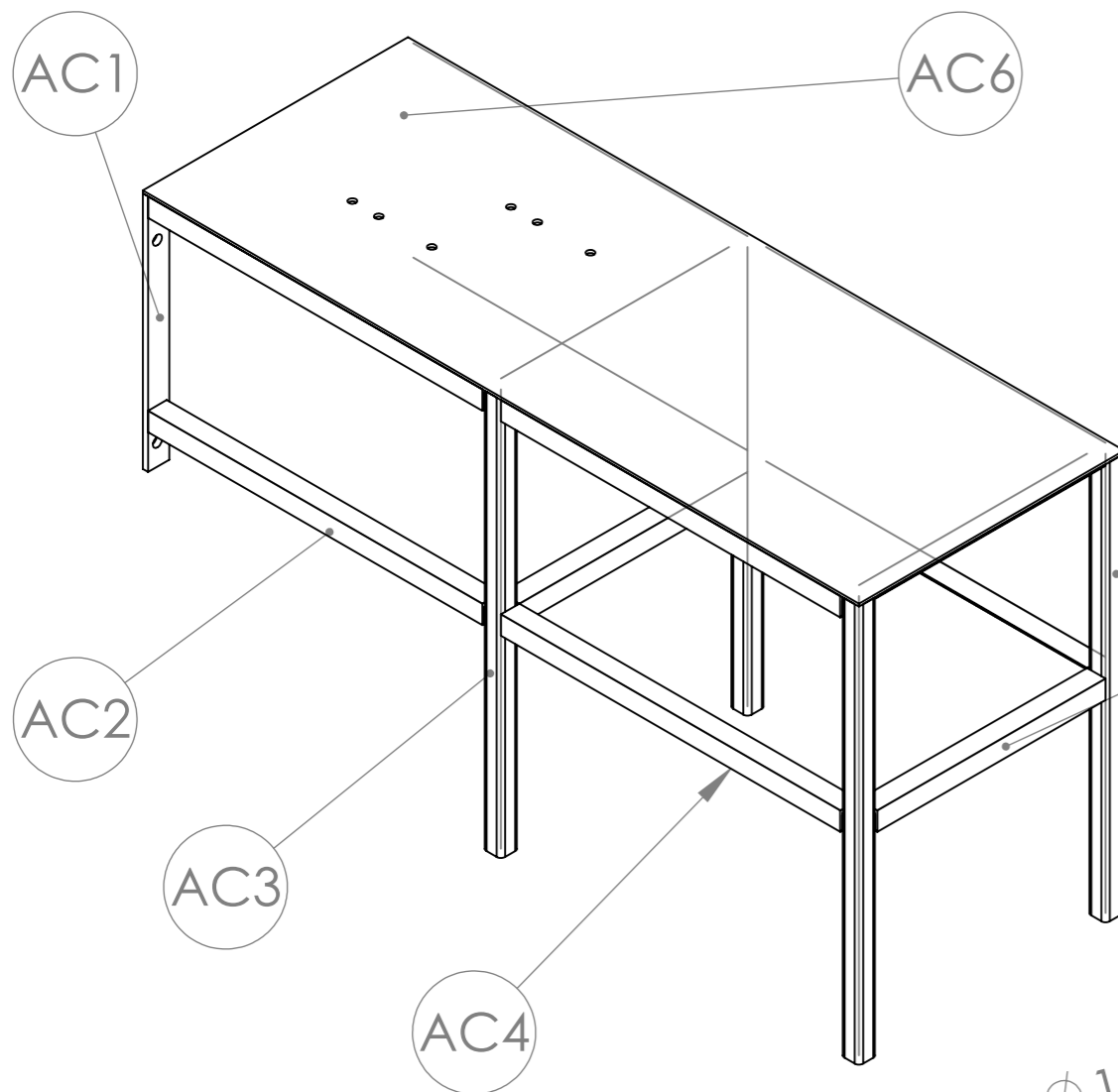

N°	Désignation	Longueur	Qté
AC1	Fer plat 40 x 10	450	2
AC2	Cornière 35 x 35 x 4	630	4
AC3	tube carré 35 x 4	750	4
AC4	Cornière 35 x 35 x 4	640	4
AC5	Cornière 35 x 35 x 4	430	4
AC6	Tôle 5mm		1

Version	2.2	Qté	1
Date	20/05/2015		
Outil	Presse à Typha		
Pièce	AD - Potence presse		

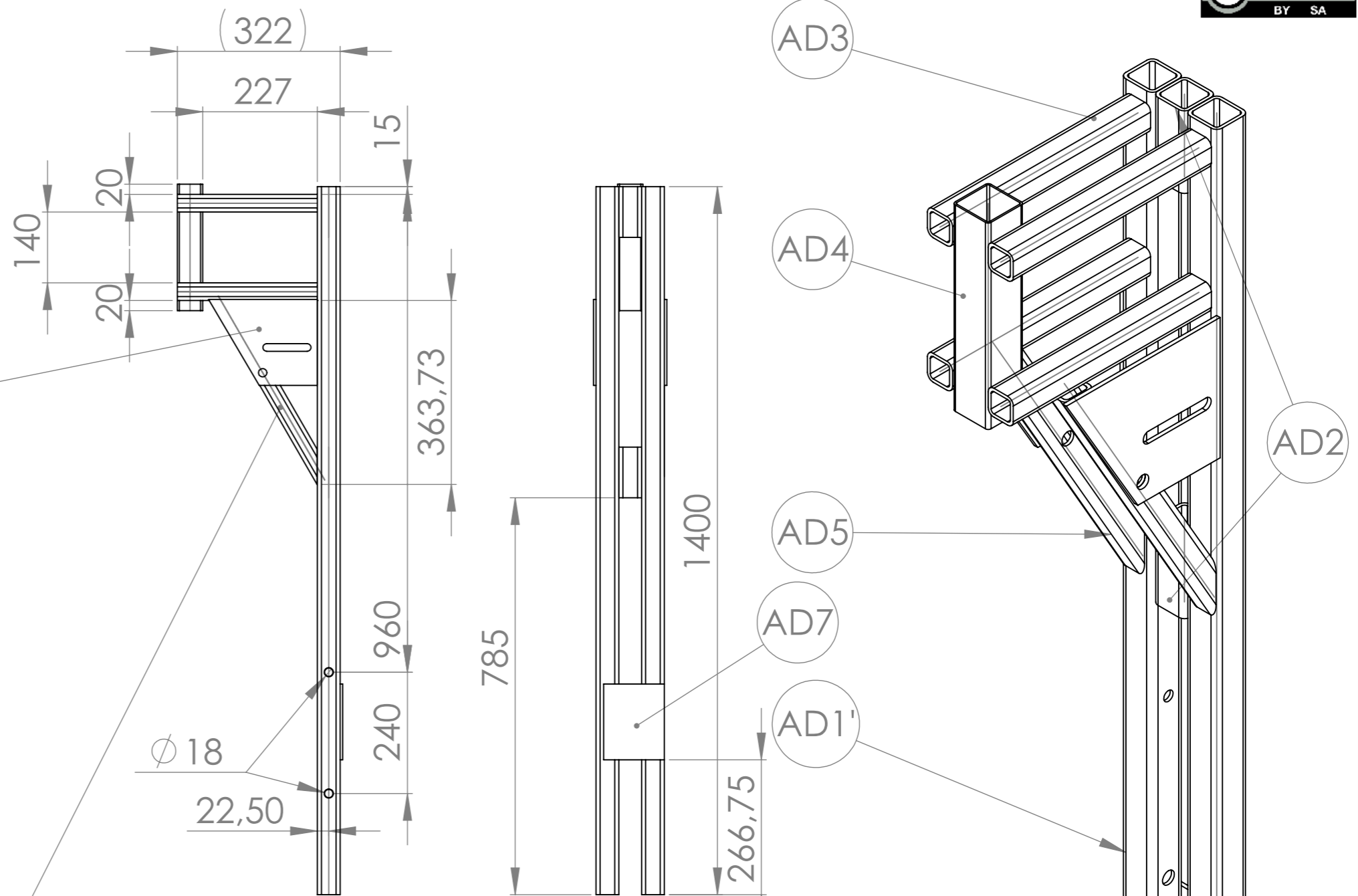
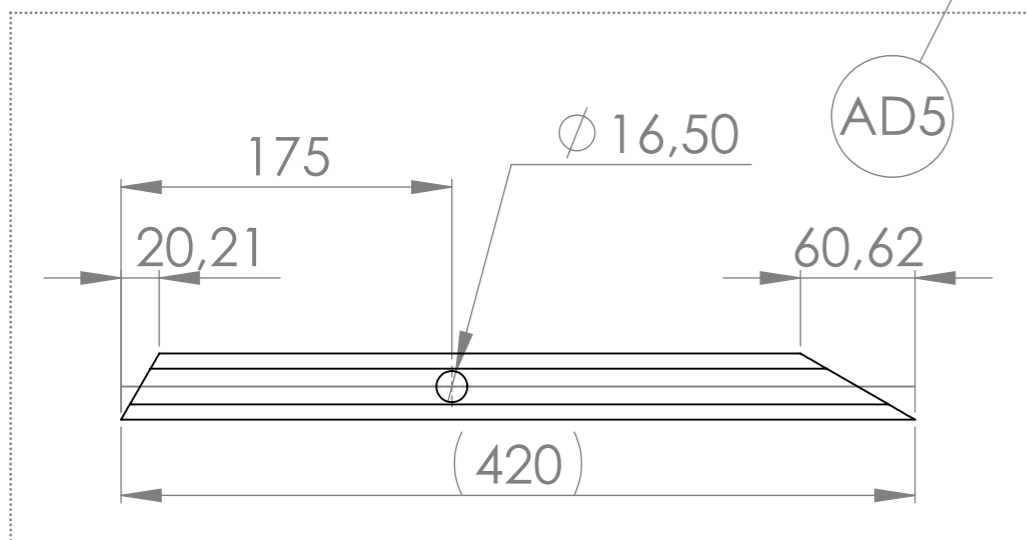
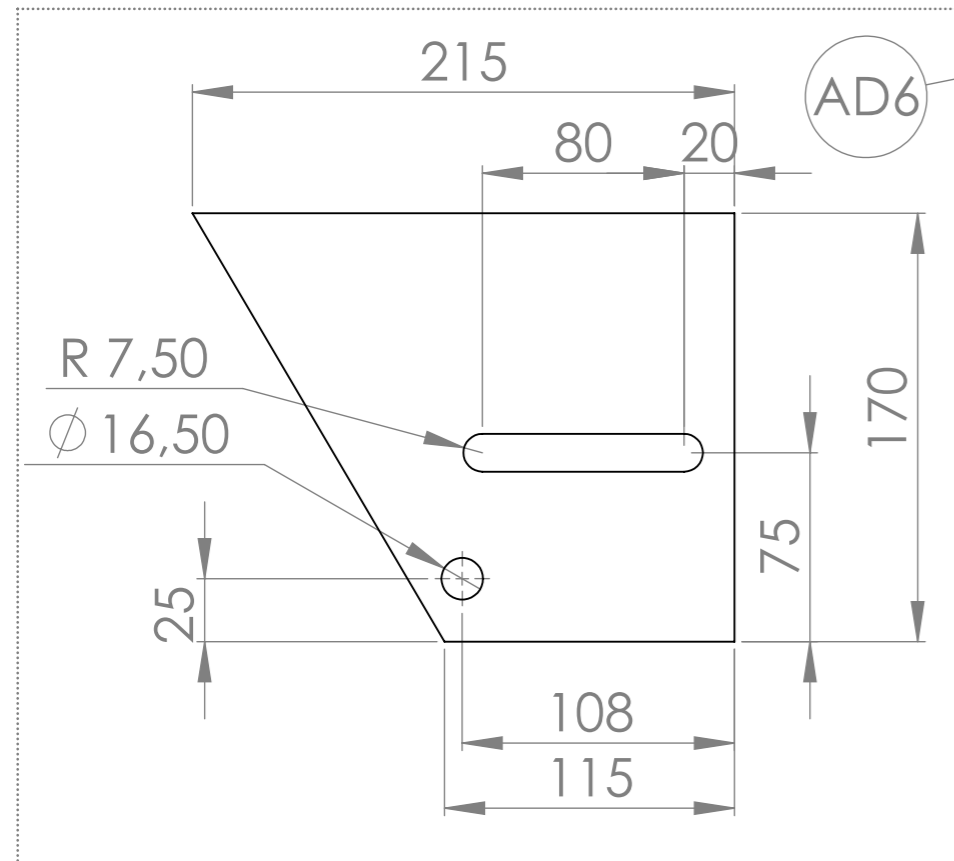

N°	Désignation	Longueur	Qté
AD1	tube carré 45 x 4	1400	1
AD1'	tube carré 45 x 4	1400	1
AD2	tube carré 45 x 4	100	2
AD3	tube carré 35 x 4	277	4
AD4	tube carré 50 x 2	250	1
AD5	tube carré 35 x 4	420	2
AD6	Tôle 5mm		2
AD7	Tole 5mm : 120*150		1

Version	2.2	Qté	1
Date	20/05/2015		
Outil	Presse à Typha		
Pièce	AE - Plateau mélange		

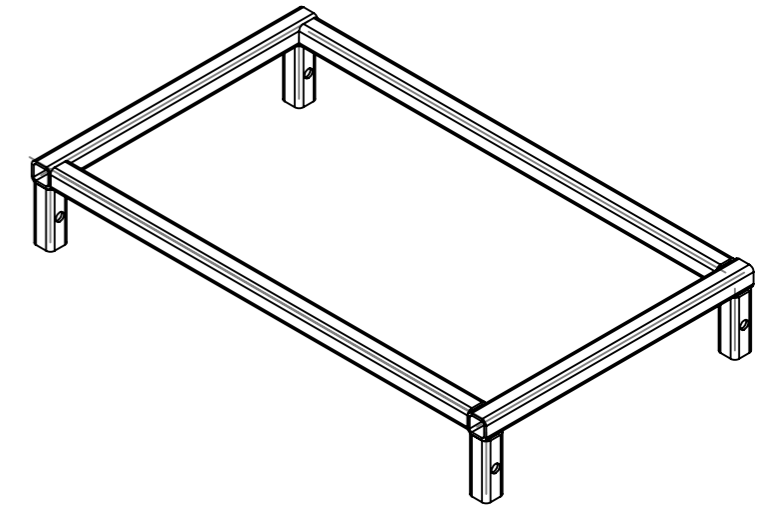
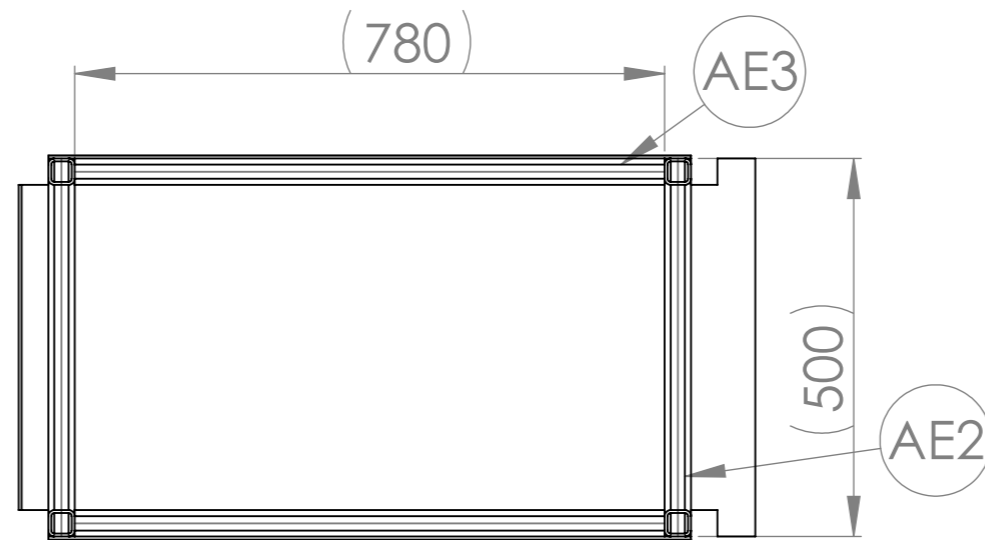
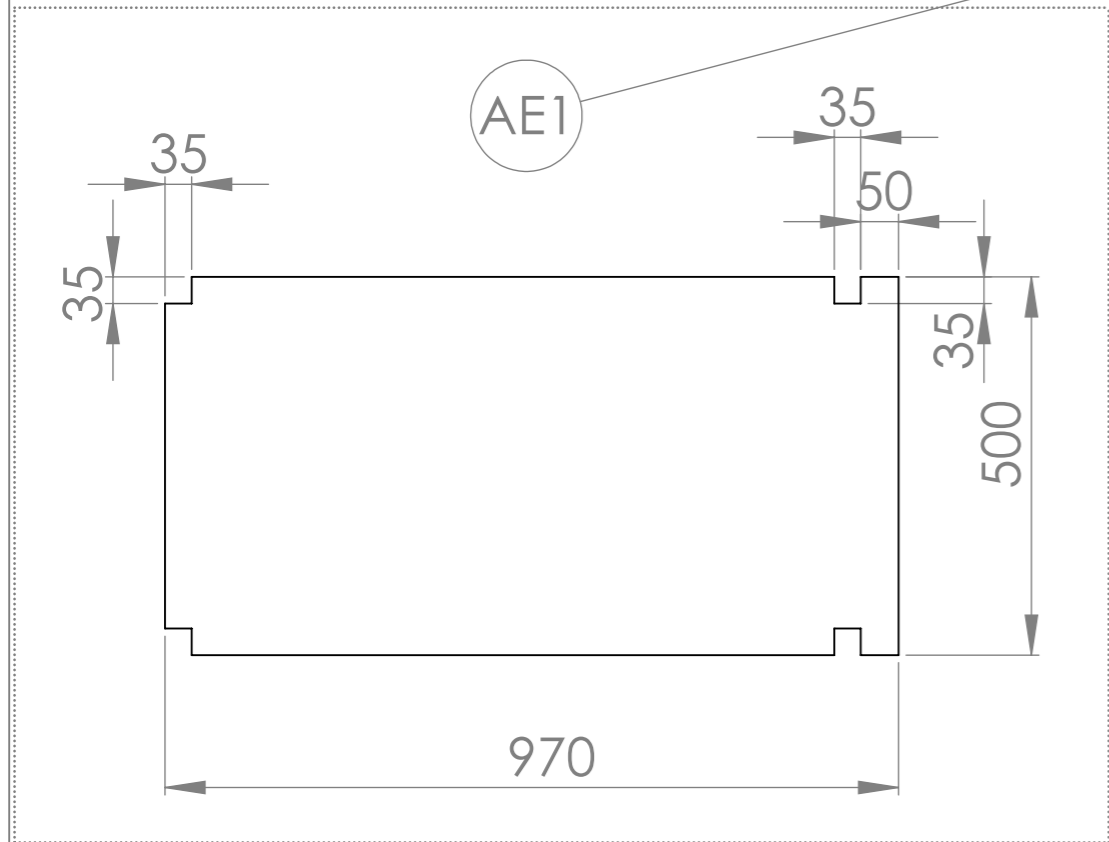
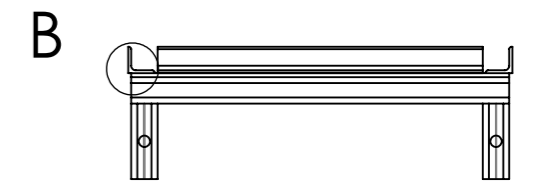
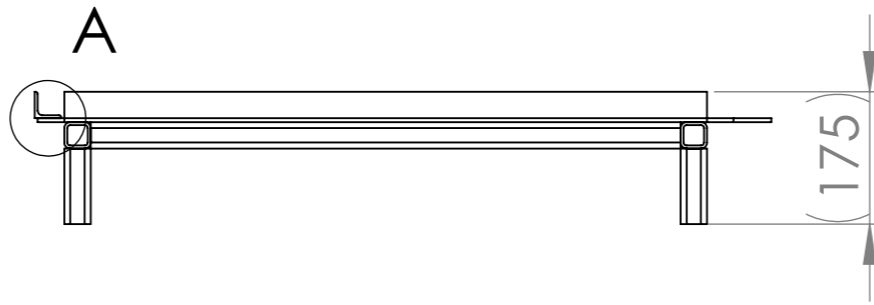
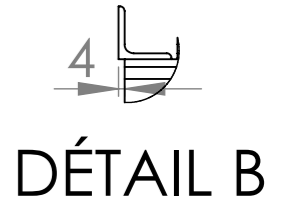
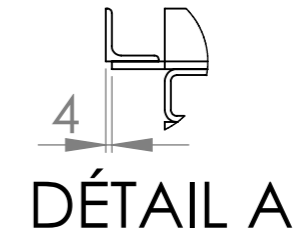
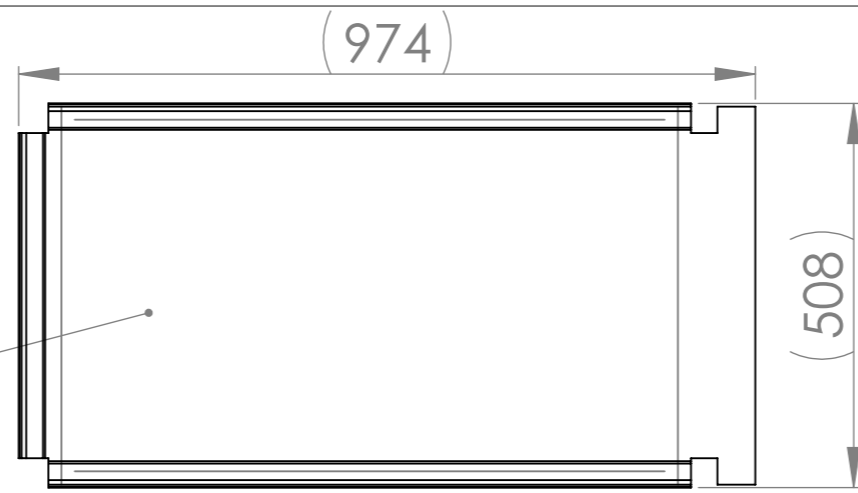

Assemblage AE2-3-4

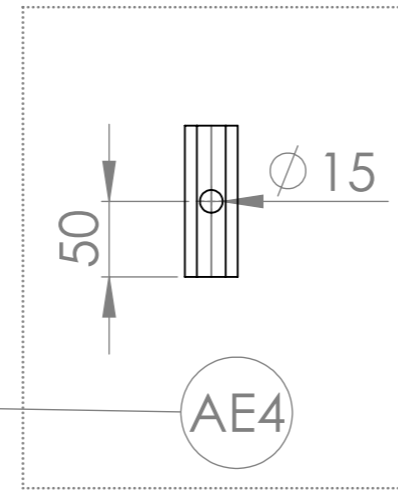
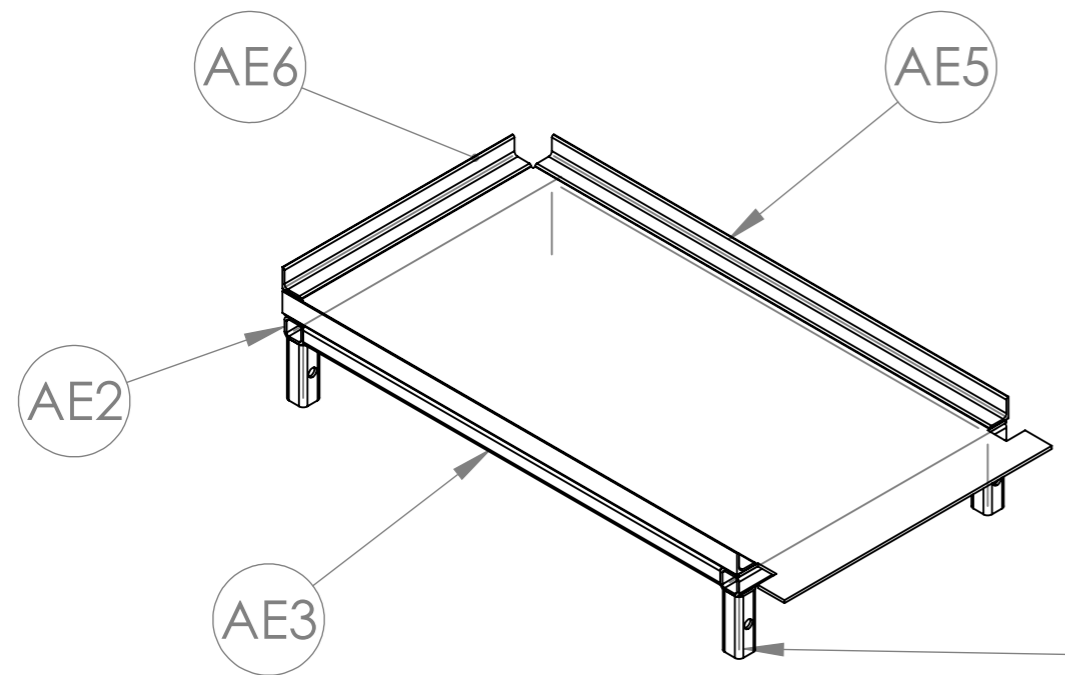

N°	Désignation	Longueur	Qté
AE1	Tôle 5mm		1
AE2	tube carré 35 x 4	500	2
AE3	tube carré 35 x 4	780	2
AE4	tube carré 35 x 4	100	4
AE5	Cornière 35 x 35 x 4	850	2
AE6	Cornière 35 x 35 x 4	430	1

Version	2.2	Qté	1
Date	20/05/2015		
Outil	Presse à Typha		
Pièce	B - Bras levier presse		

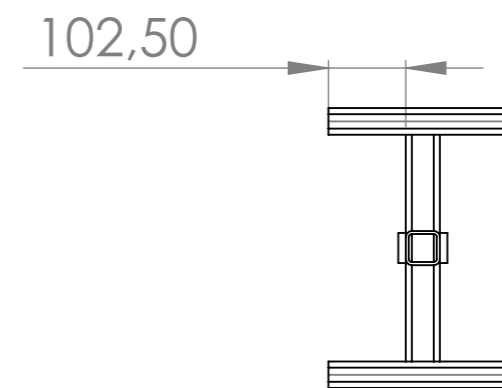
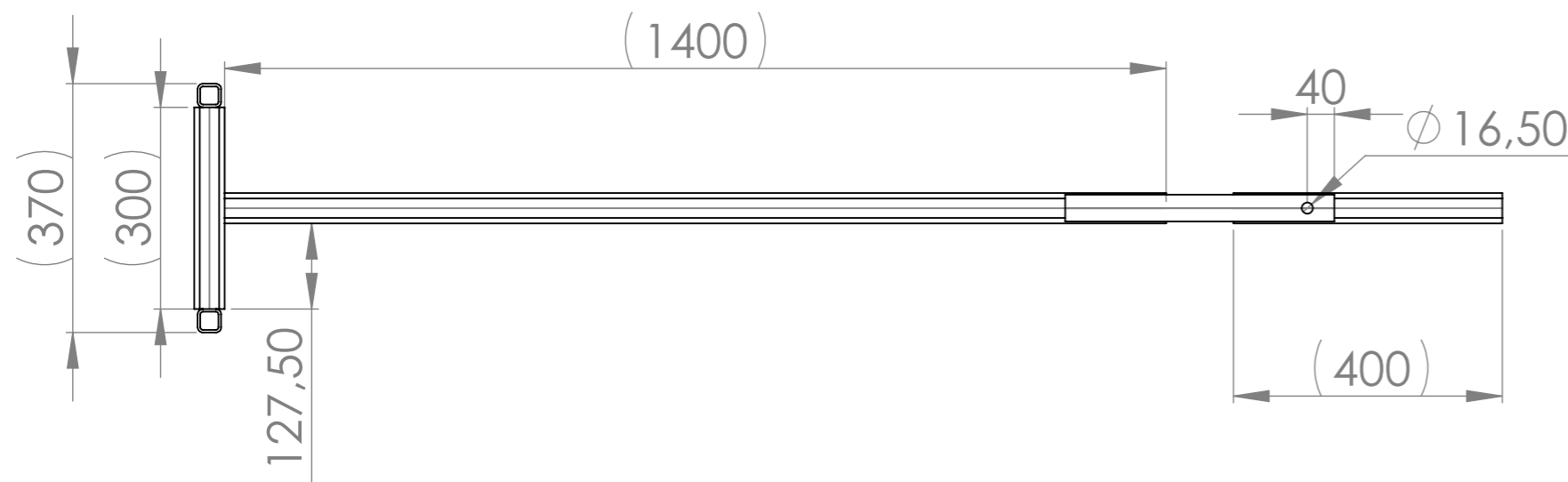
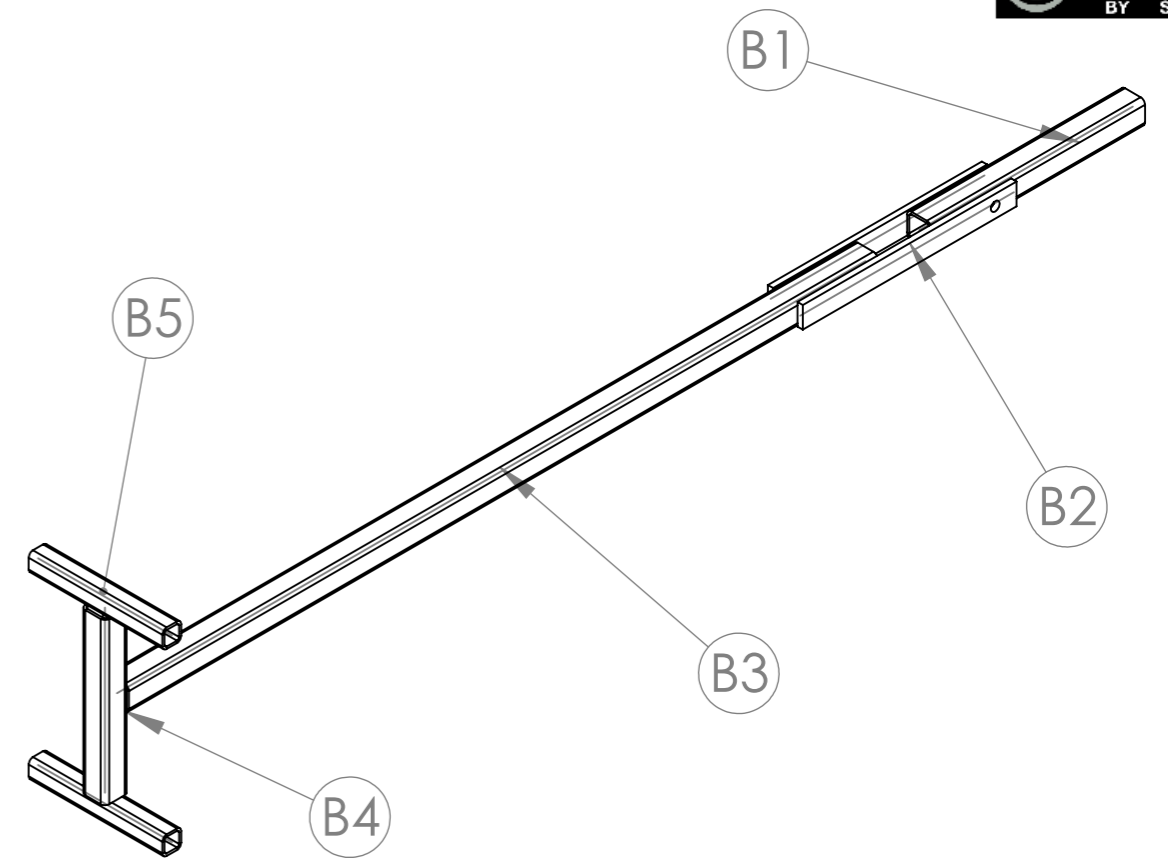
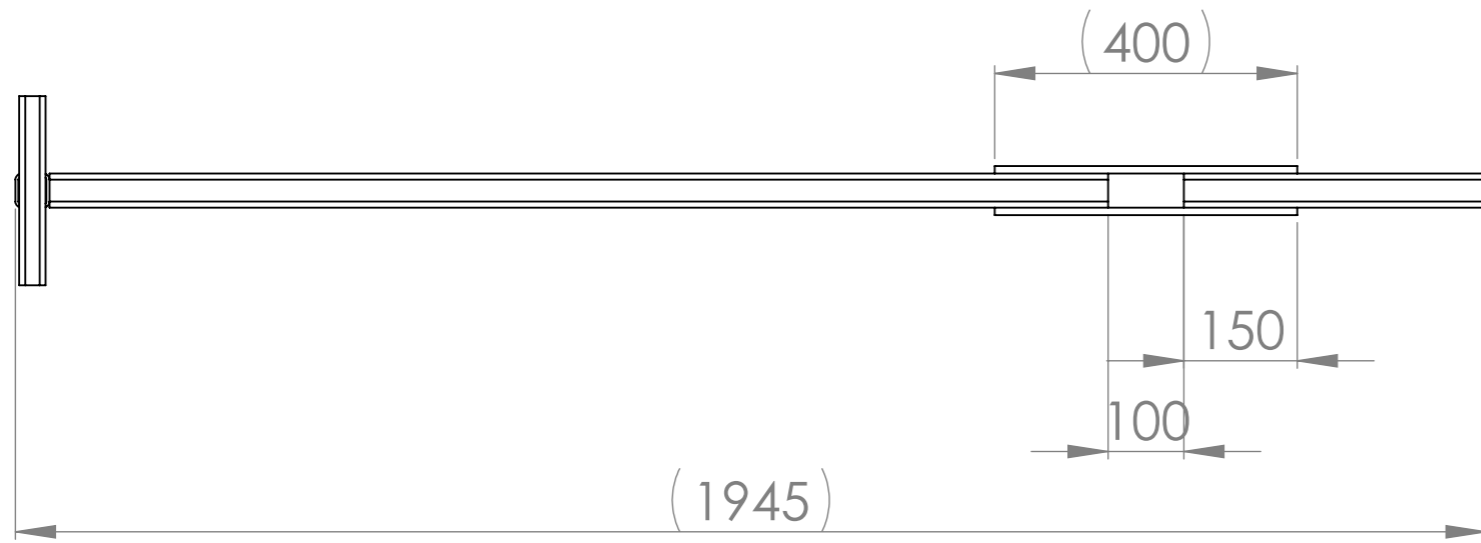

N°	Désignation	Longueur	Qté
B1	tube carré 45 x 4	400	1
B2	Fer plat 40 x 10	400	2
B3	tube carré 45 x 4	1400	1
B4	tube carré 45 x 4	300	1
B5	tube carré 35 x 4	250	2

Version	2.2	Qté	1
Date	20/05/2015		
Outil	Presse à Typha		
Pièce	C - Support de compression		

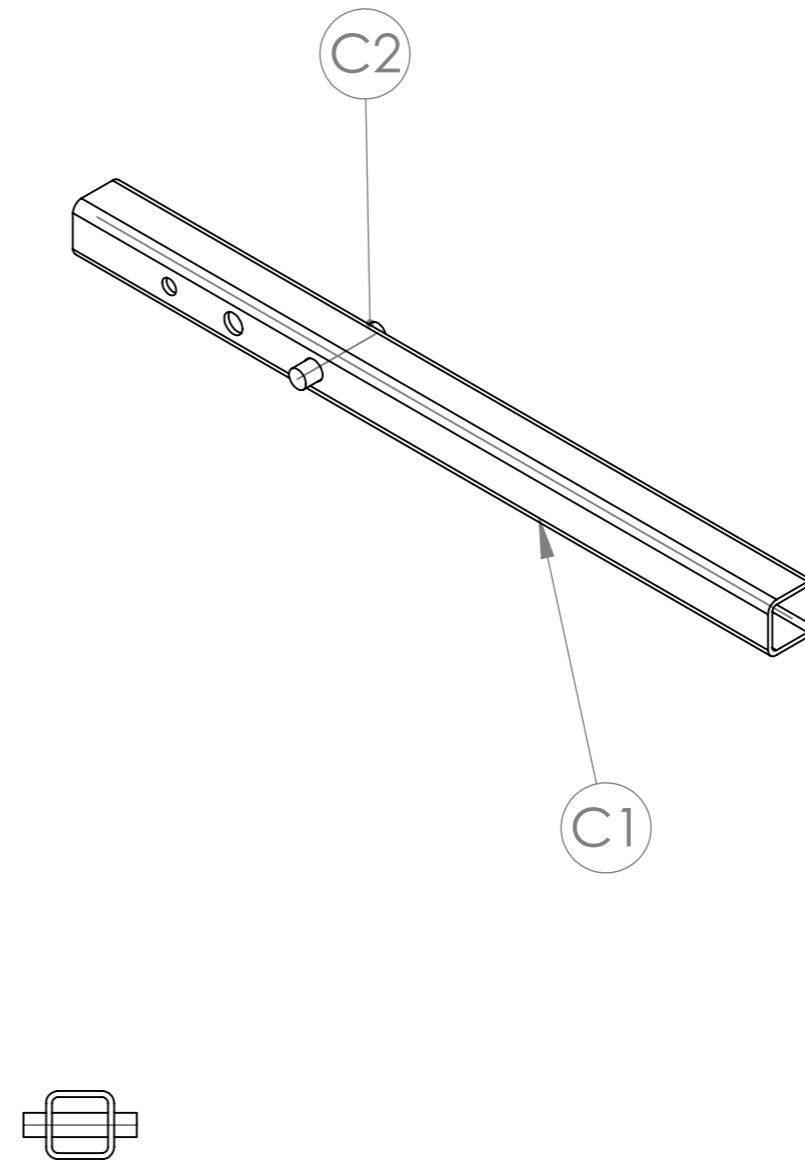
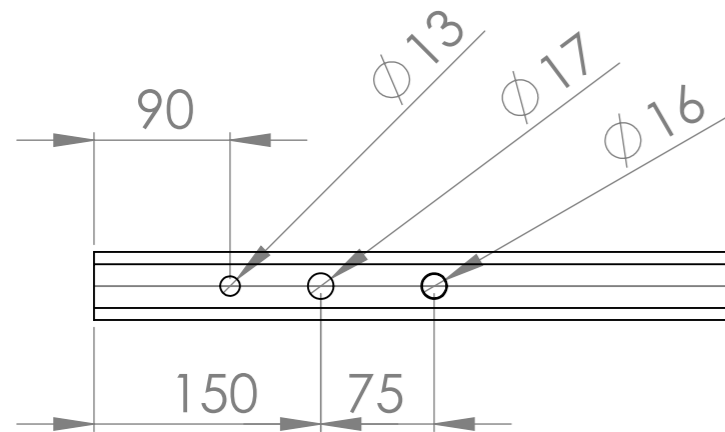
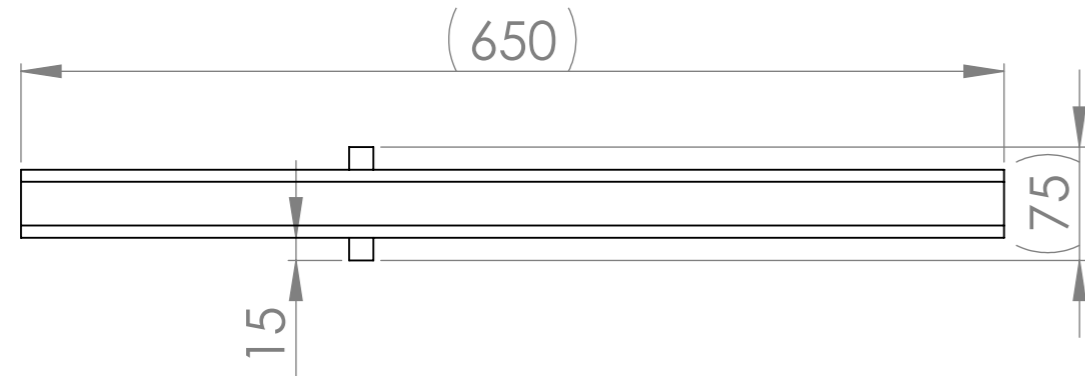

N°	Désignation	Longueur	Qté
C1	tube carré 45 x 4	650	1
C2	étiré rond $\phi 16$	75	1

Version	2.2	Qté	1
Date	20/05/2015		
Outil	Presse à Typha		
Pièce	D - Support Démoulage		

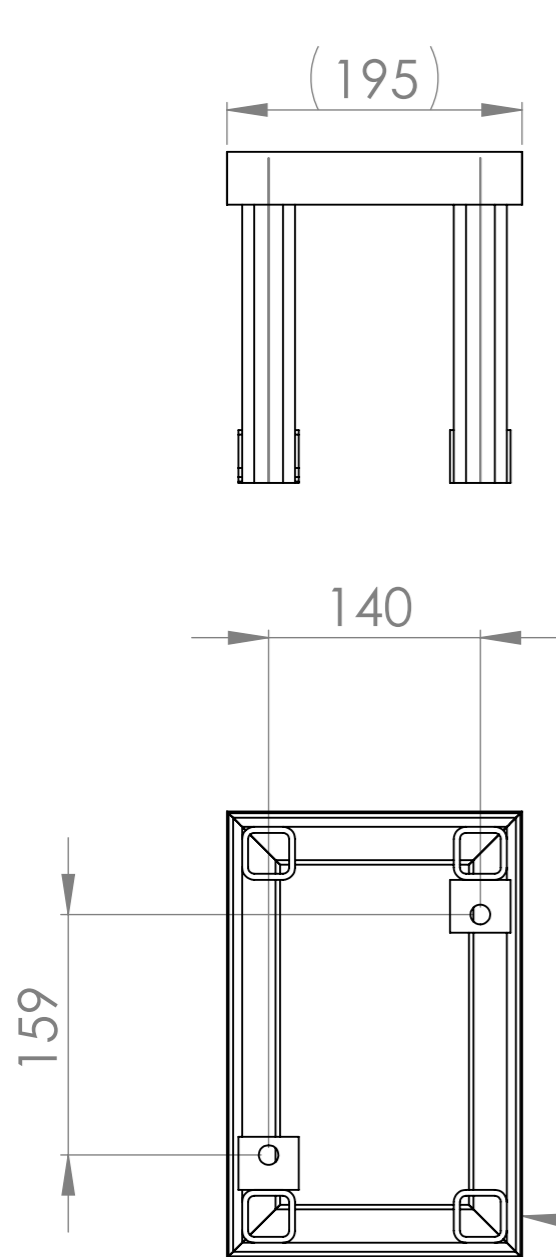

Souder D4 en dernier lieu en vérifiant bien les côtes d'entraxe.

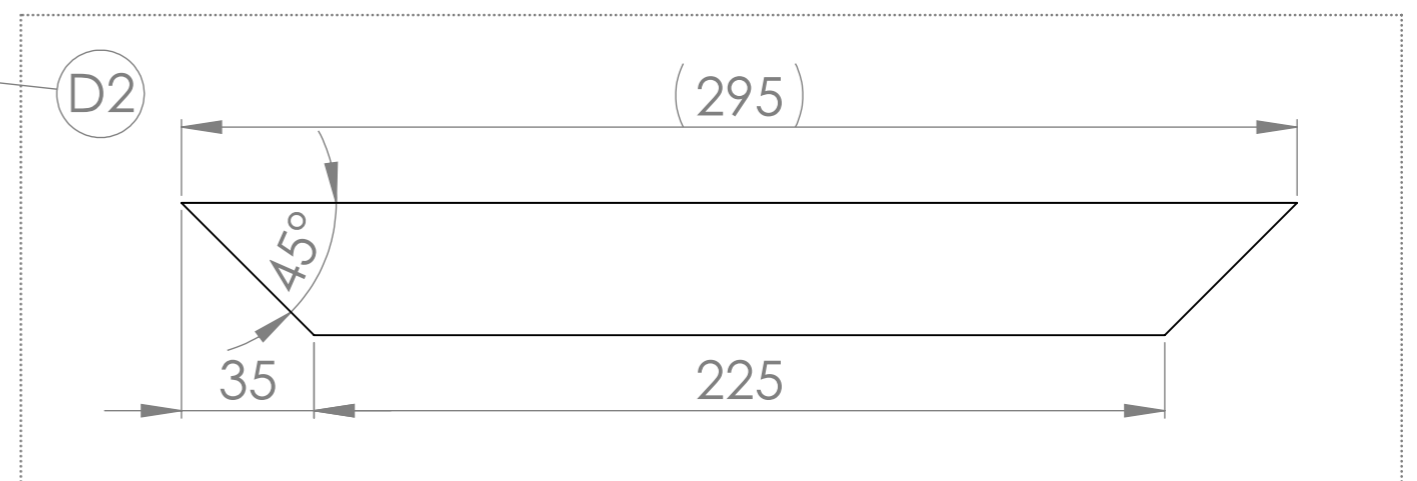
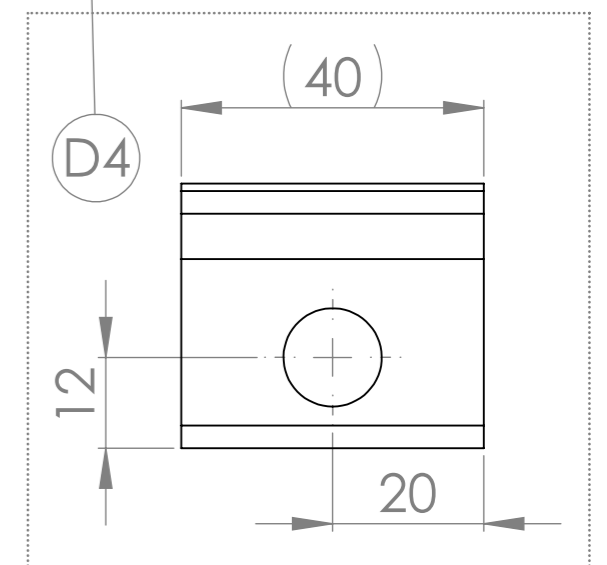
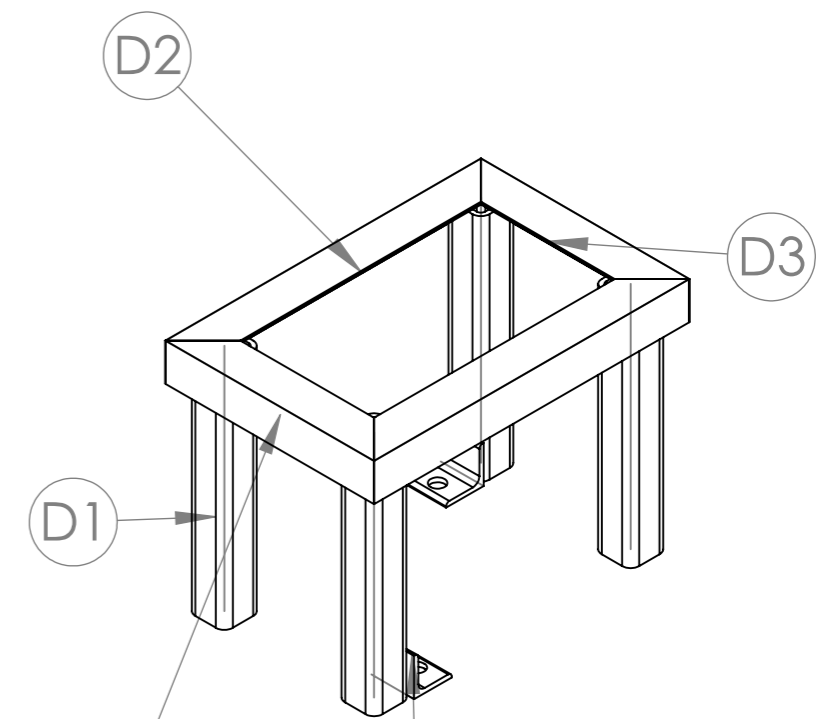
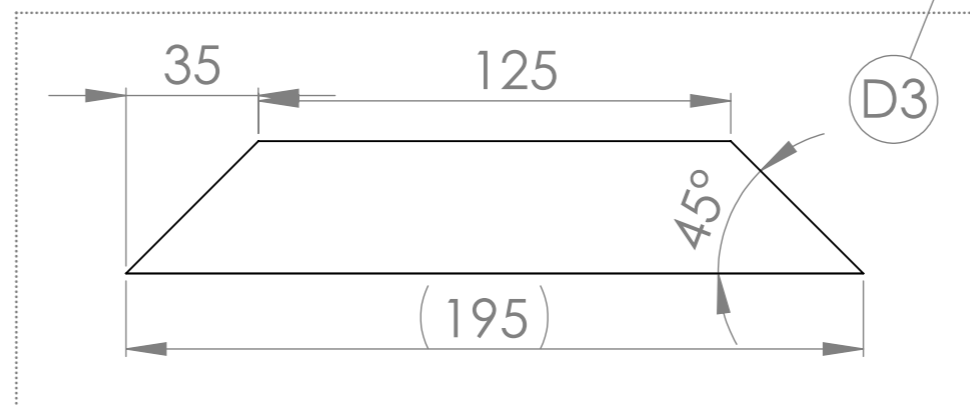
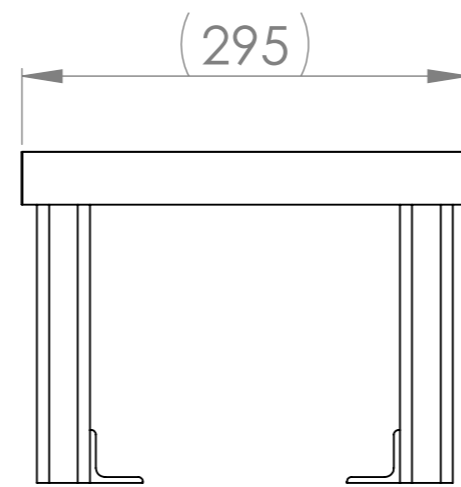

N°	Désignation	Longueur	Qté
D1	tube carré 35 x 4	215	4
D2	Cornière 35 x 35 x 4	295	2
D3	Cornière 35 x 35 x 4	195	2
D4	Cornière 35 x 35 x 4	40	2

Version	2.2	Qté	1
Date	20/05/2015		
Outil	Presse à Typha		
Pièce	BG - PC grosse brique		

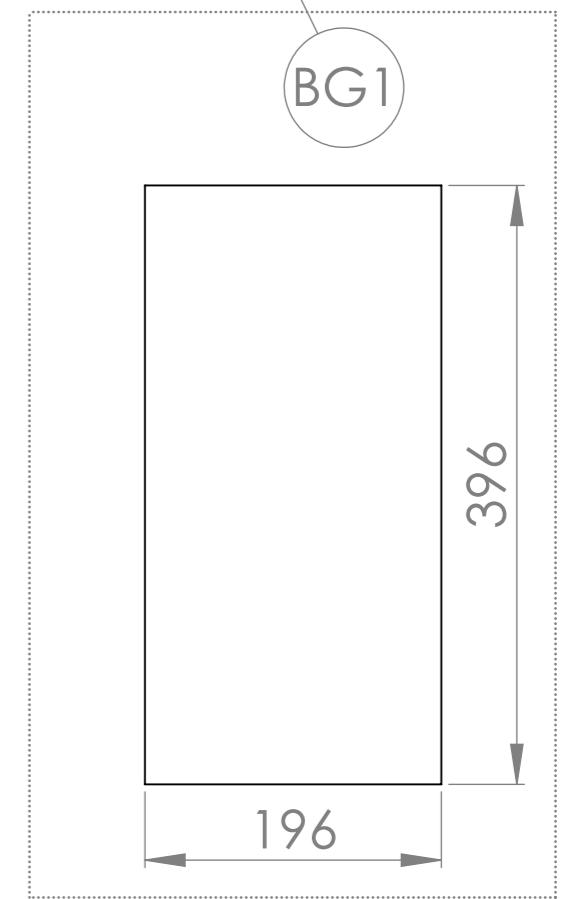
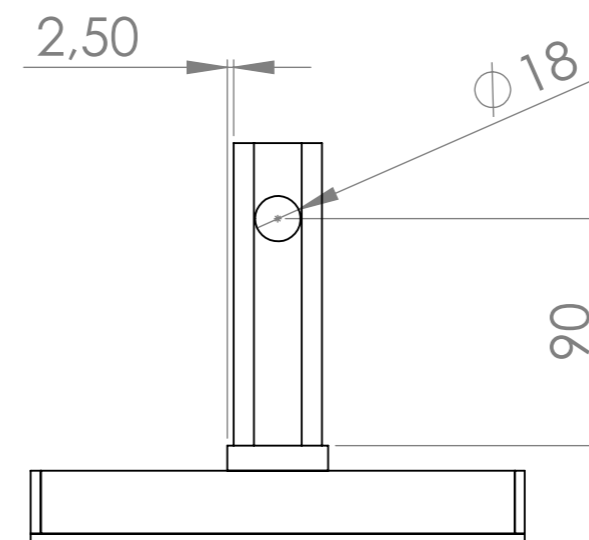
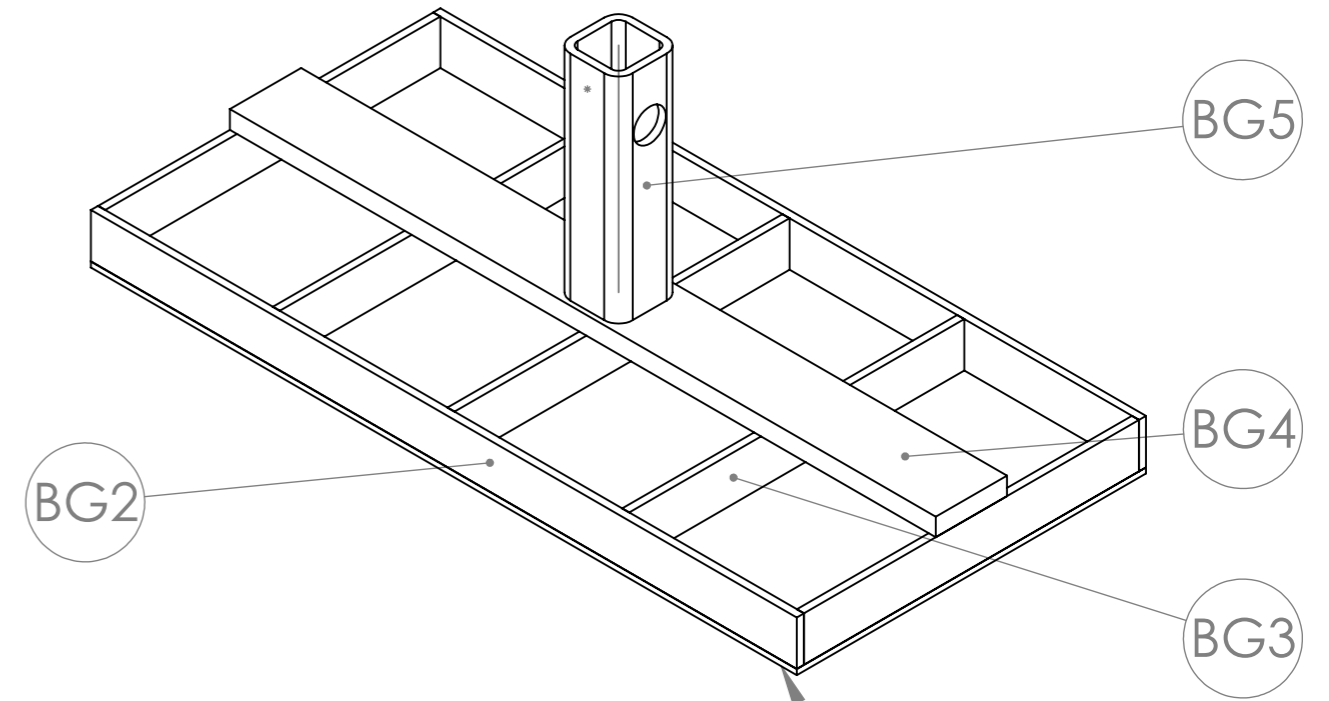
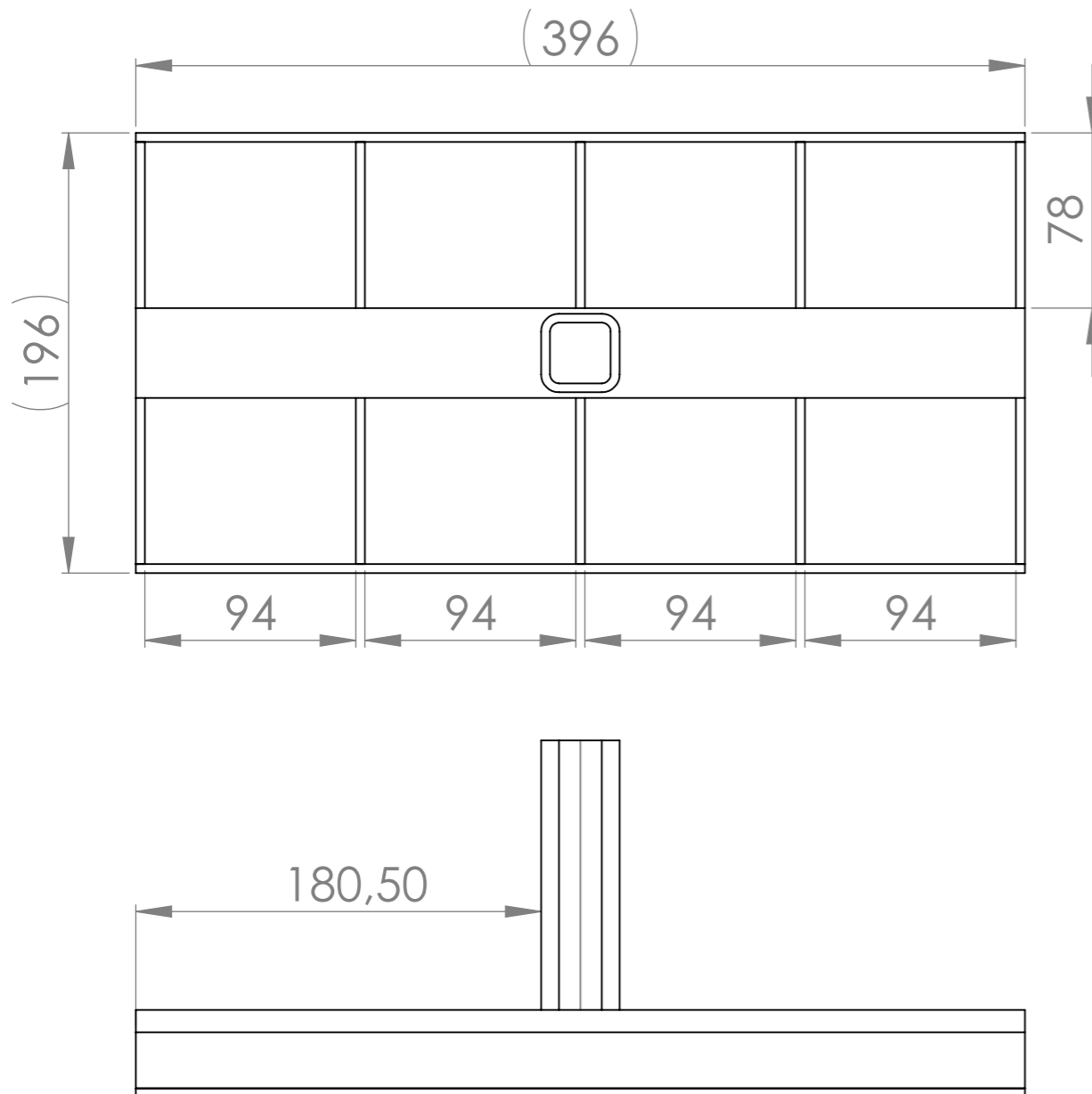

N°	Désignation	Longueur	Qté
BG1	Tôle 3mm		1
BG2	Fer plat 25 x 4	396	2
BG3	Fer plat 25 x 4	188	5
BG4	Fer plat 40 x 10	396	1
BG5	tube carré 35 x 4	120	1

Version	2.2	Qté	1
Date	20/05/2015		
Outil	Presse à Typha		
Pièce	BGm - Moule grosse brique		



N°	Désignation	Longueur	Qté
BGm	Tôle 3mm pliée		1
BGm1	Fer plat 25 x 4	456	2
BGm2	Fer plat 25 x 4	266	2

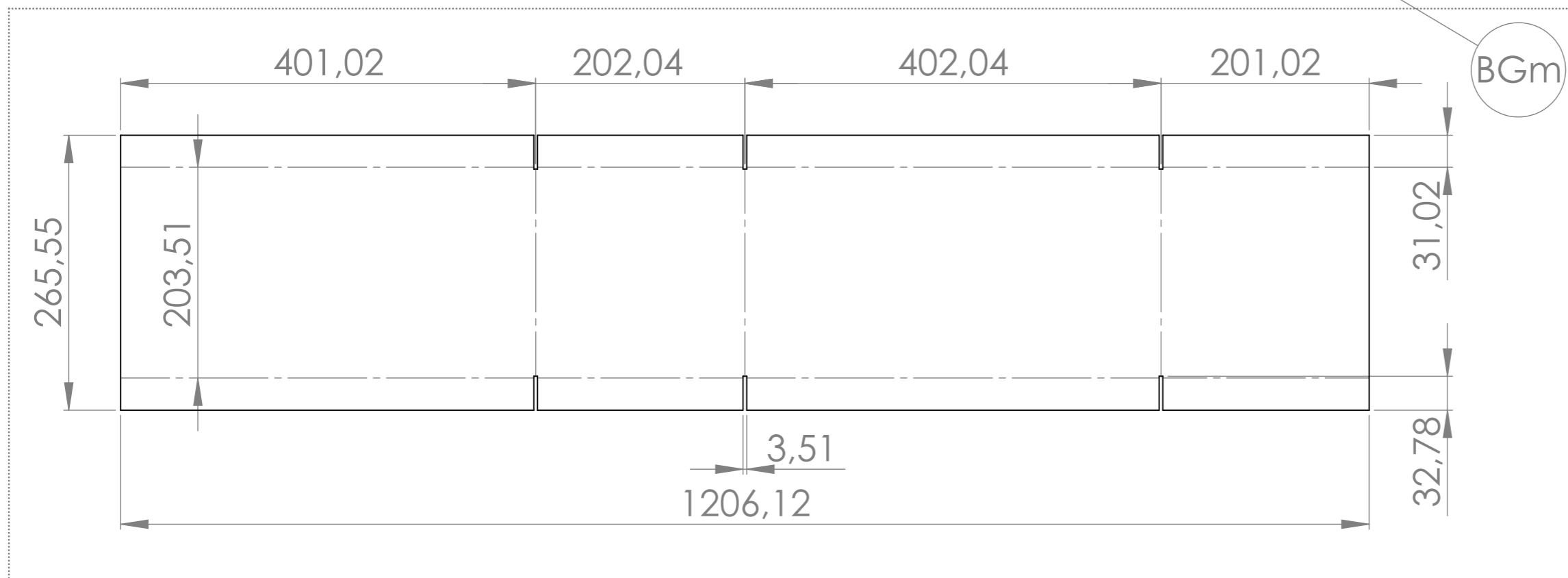
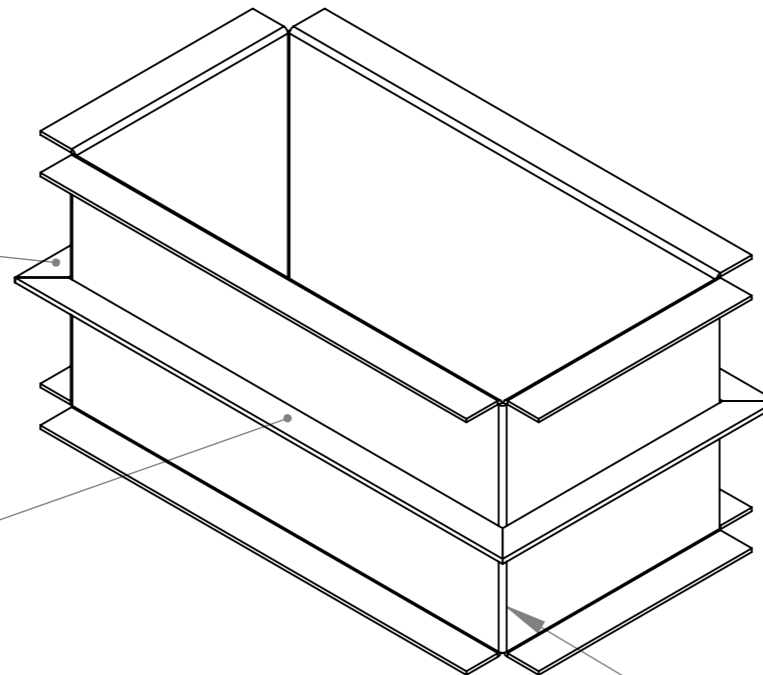
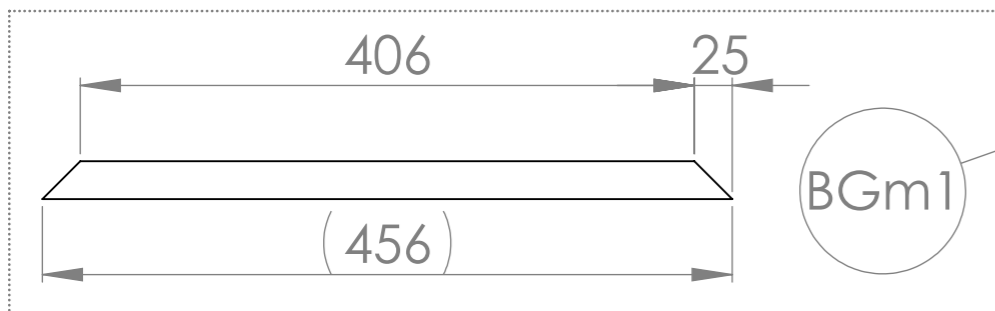
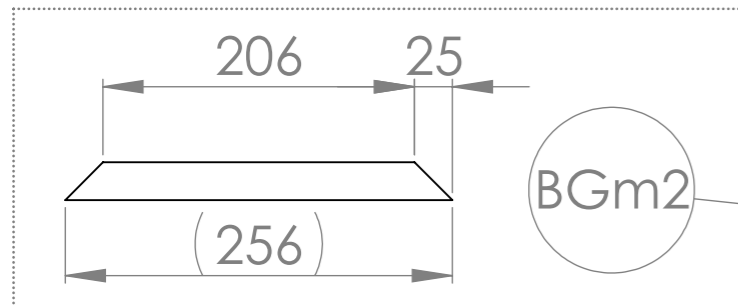

Version	2.2	Qté	1
Date	20/05/2015		
Outil	Presse à Typha		
Pièce	BP - PC petite brique		

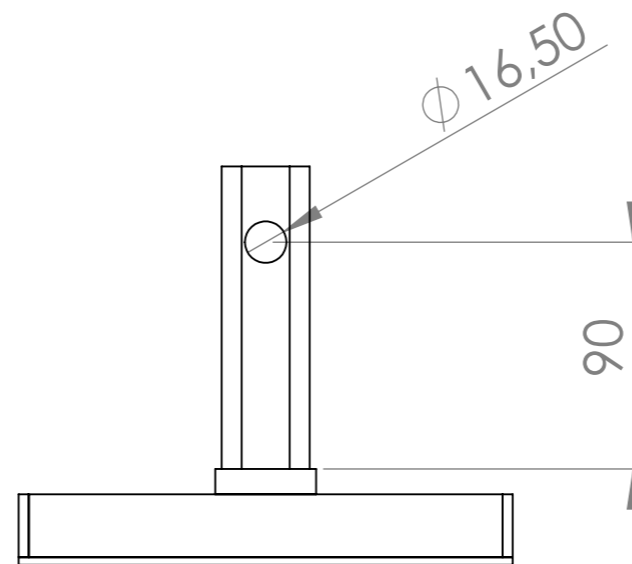
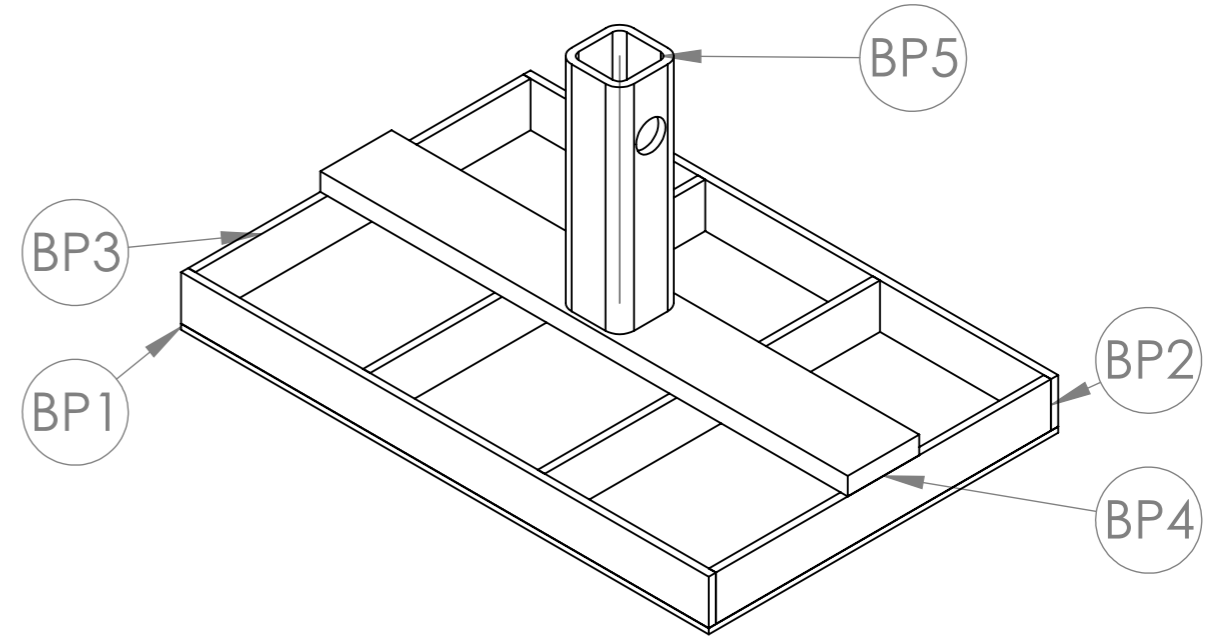
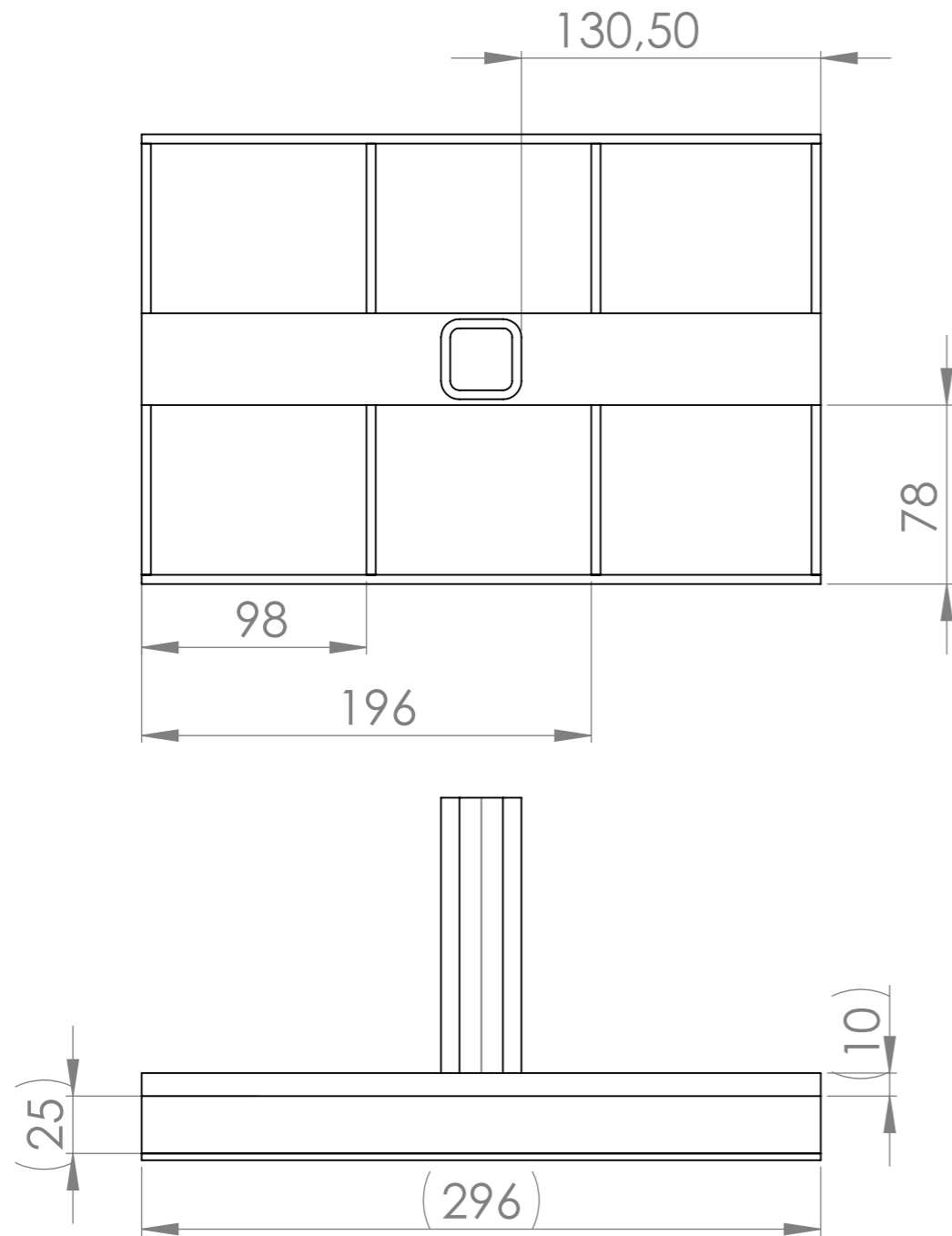

N°	Désignation	Longueur	Qté
BP1	Tôle 5mm 196x296		1
BP2	Fer plat 25 x 4	296	2
BP3	Fer plat 25 x 4	188	4
BP4	Fer plat 40 x 10	296	1
BP5	tube carré 35 x 4	120	1

Version	2.2	Qté	1
Date	20/05/2015		
Outil	Presse à Typha		
Pièce	BPm - moule petite brique		

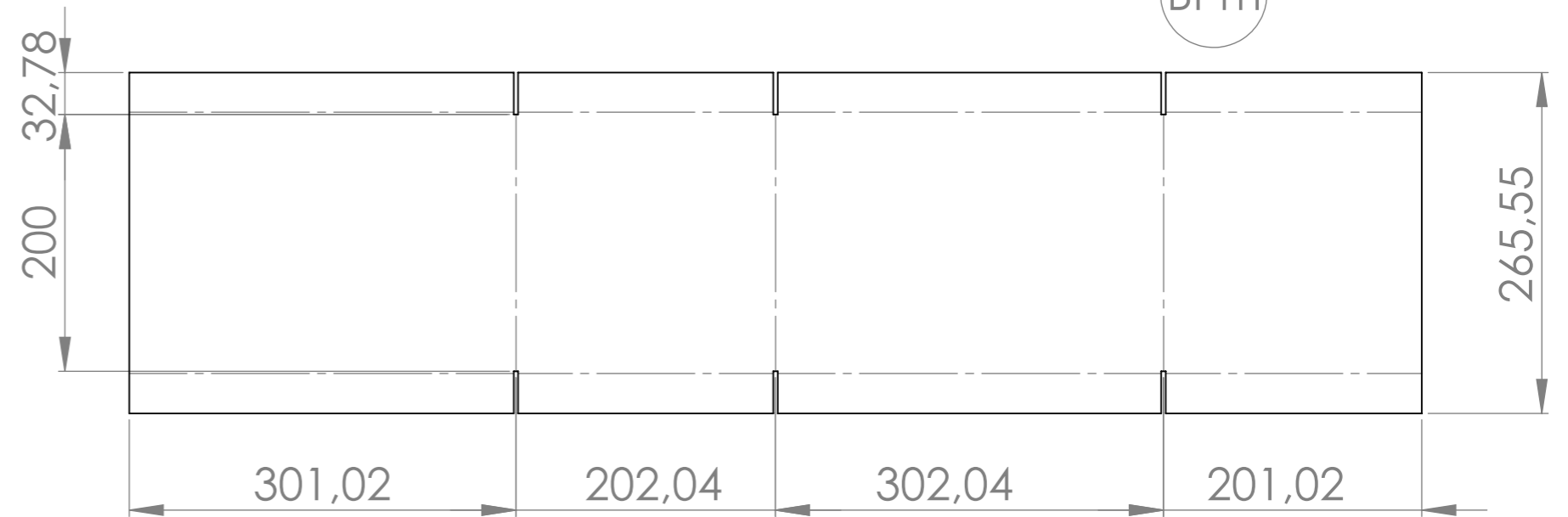
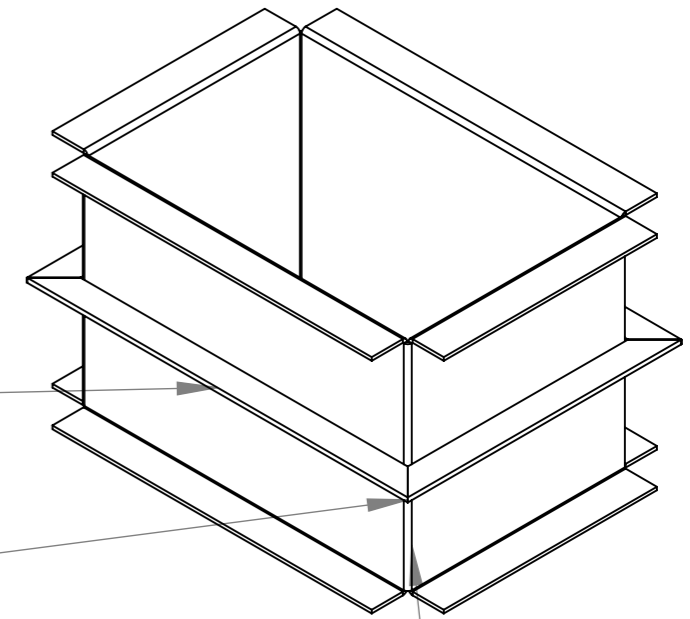
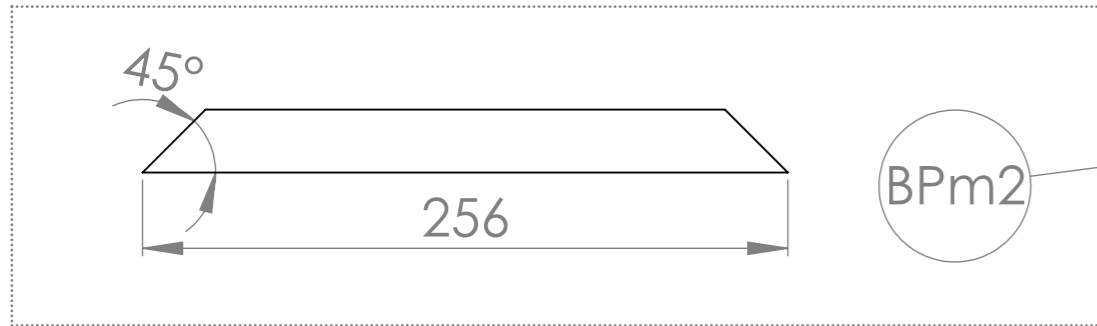
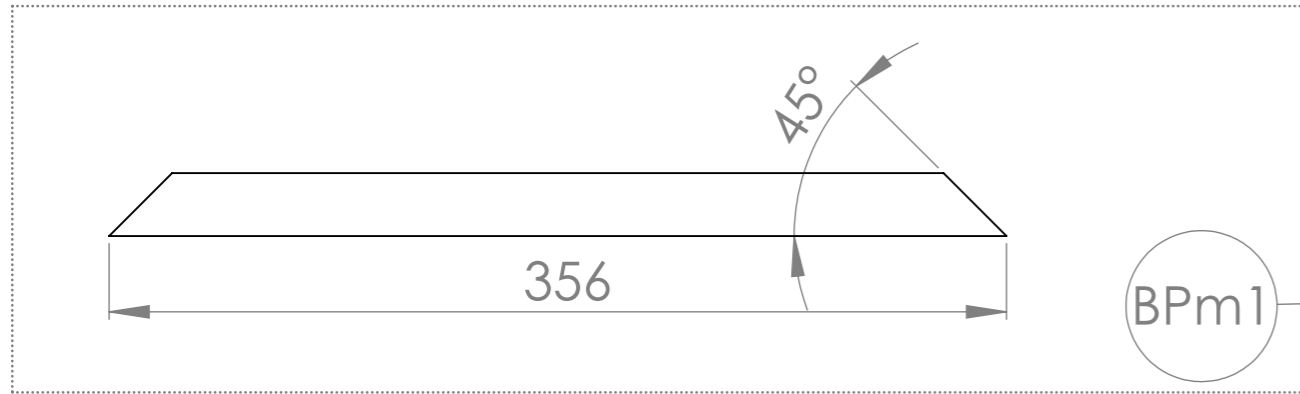

N°	Désignation	Longueur	Qté
BPm	Tôle 3mm		1
BPm1	Fer plat 25 x 4	356	2
BPm2	Fer plat 25 x 4	266	2

Version	2.2	Qté	1
Date	20/05/2015		
Outil	Presse à Typha		
Pièce	P - PC panneau 297		

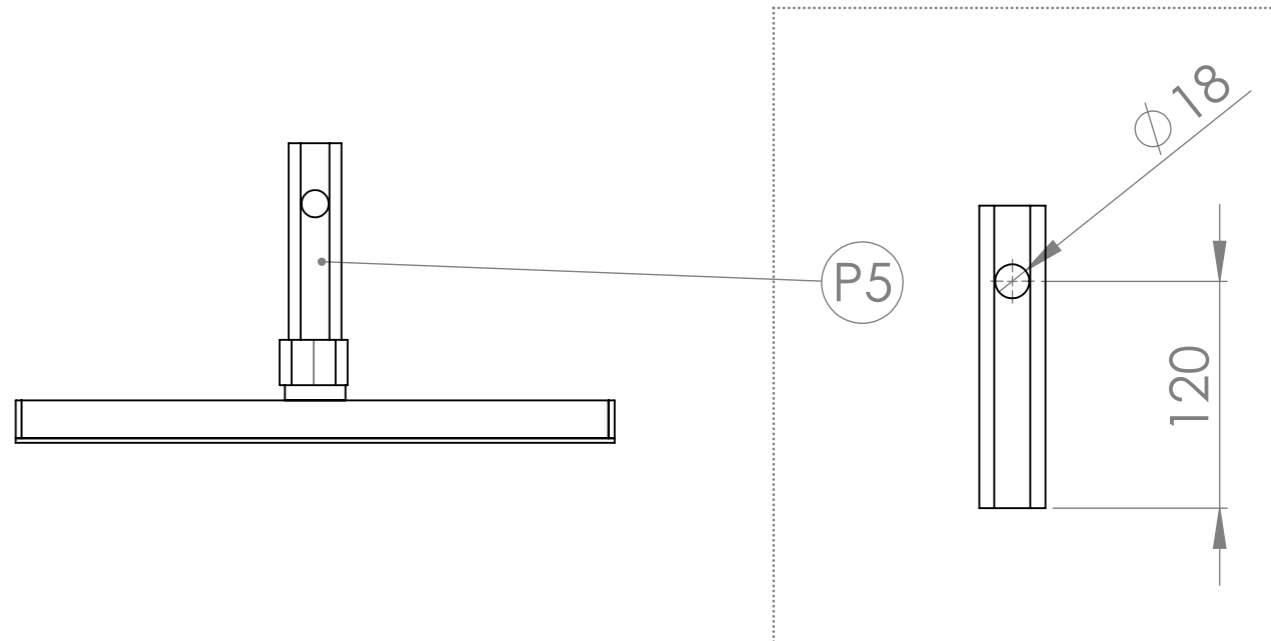
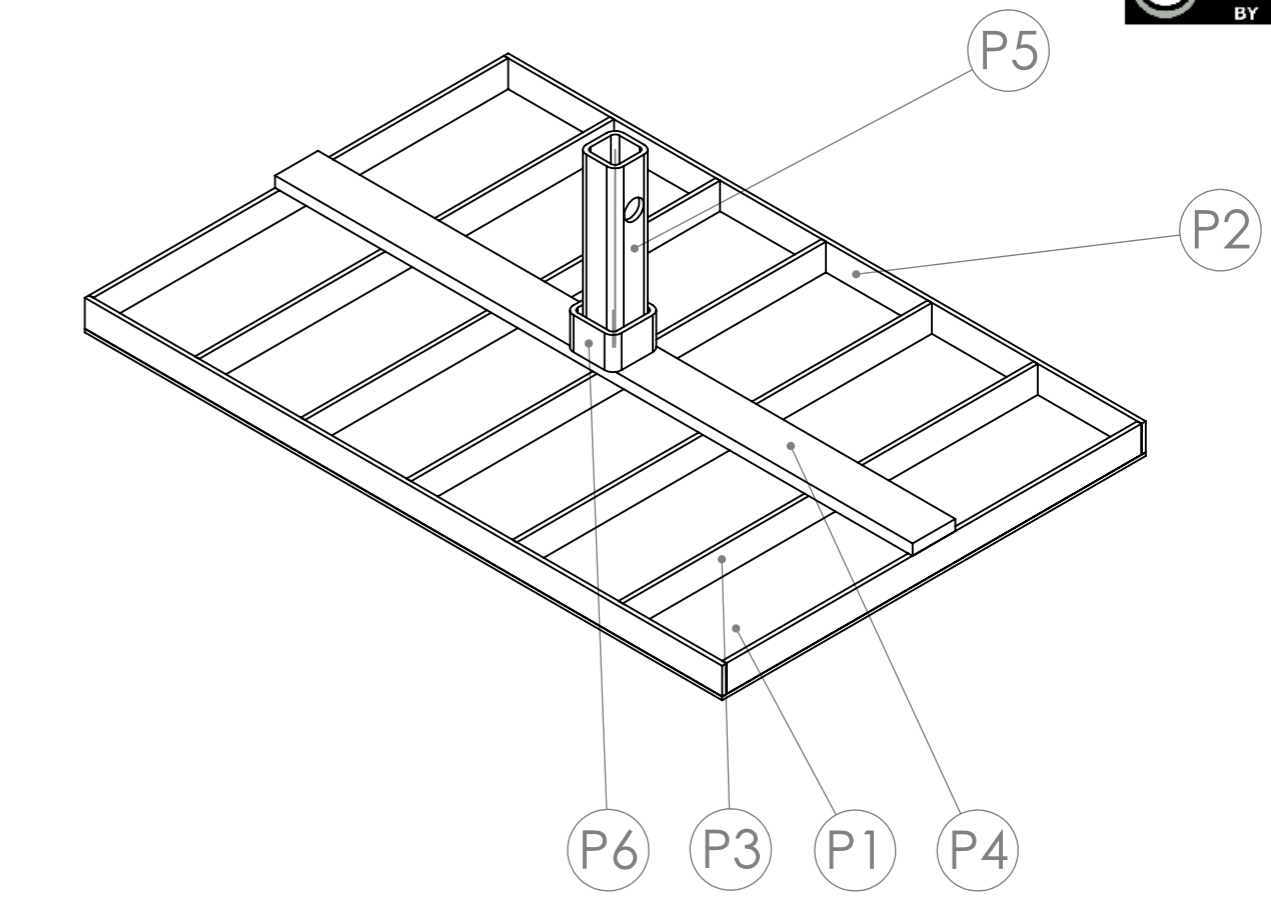
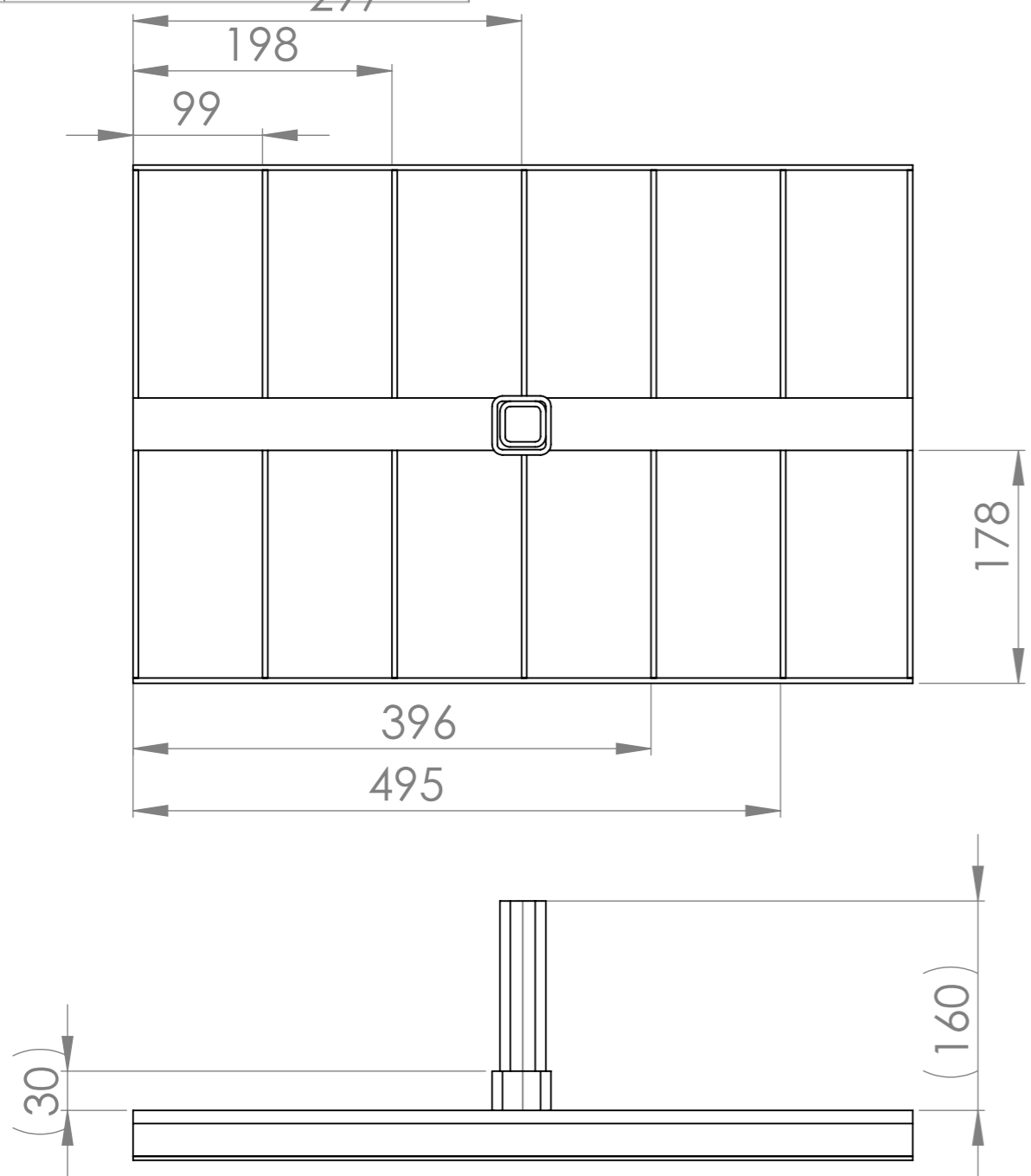

N°	Désignation	Longueur	Qté
P1	Tôle 3mm 596x396		1
P2	Fer plat 25 x 4	596	2
P3	Fer plat 25 x 4	388	7
P4	Fer plat 40 x 10	596	1
P5	tube carré 35 x 4	160	1
P6	tube carré 45 x 4	30	1

Version	2.2	Qté	1
Date	20/05/2015		
Outil	Presse à Typha		
Pièce	Pm - moule panneau		

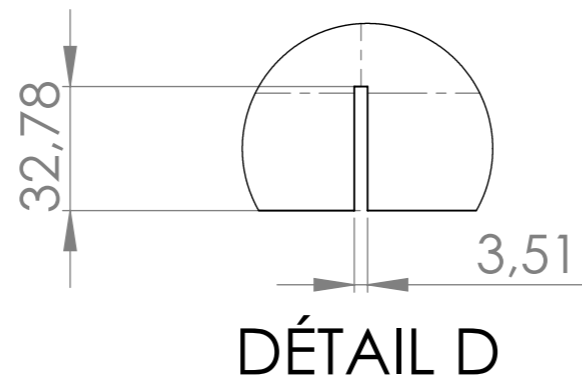
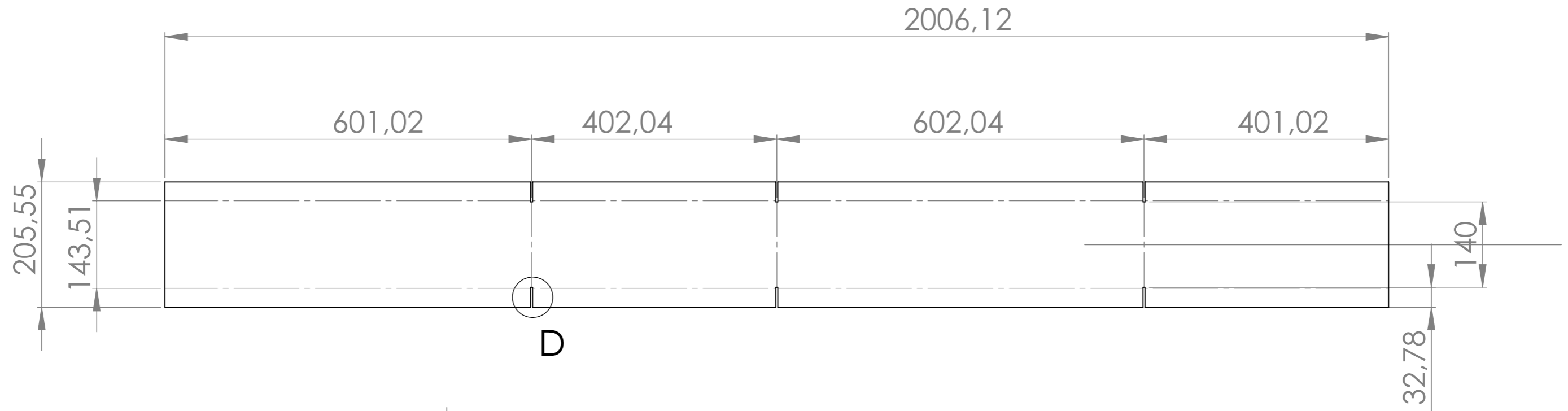
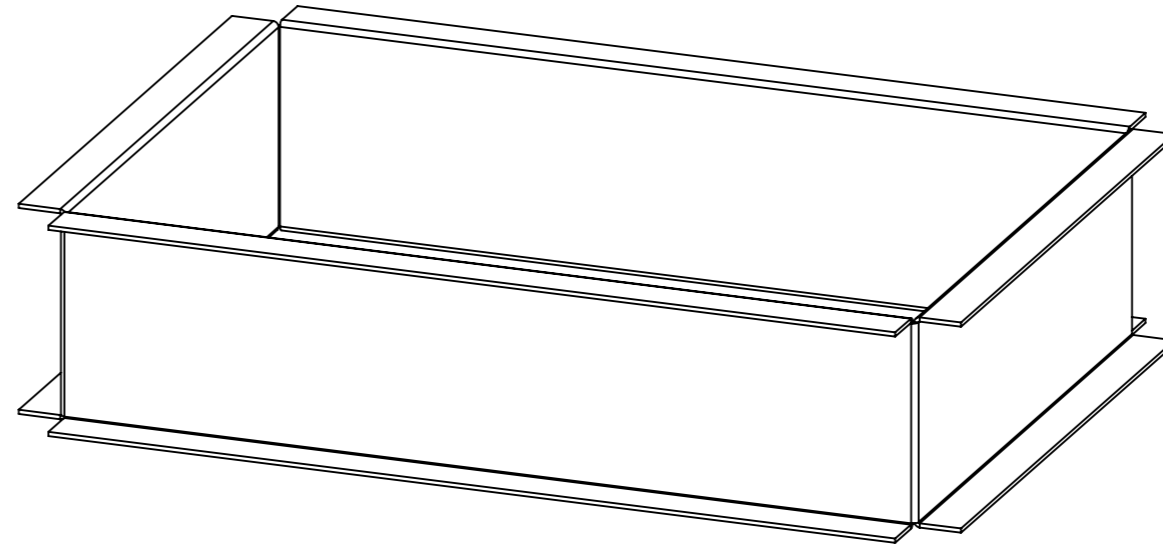

Version	2.2	Qté	1
Date	20/05/2015		
Outil	Presse à Typha		
Pièce	Eclaté		



N°	Désignation	Qté
1	AA - Socle stockage mélange	1
2	AB - Table presse	1
3	AC - Table démoulage	1
4	AD - Potence Presse	1
5	AE - Plateau stockage mélange	1
6	Ecrou M14	6
7	Vis Hexagonale M14 x 100	4
8	Vis Hexagonale M12 x 60	5
9	Ecrou M12	12
10	Vis Hexagonale M14 x 150	2
11	B - Bras levier presse	1
12	C - Support de compression	1
13	BG - Plateau compression grosse brique	1
14	D - Support Démoulage	1
15	tube carré 35 x 4	1
16	Vis hexagonale M12 x 30	2
17	Vis Hexagonale M16 x 160	1
18	Ecrou M16 (NON AUTOBLOQUANT)	1
19	Goupille épingle d'axe, 15x70 Ø4	2
20	étiré rond Ø16	1
21	rondelle Ø int 14 / Ø ext 30 / ep 2	16
22	Vis hexagonale M12 x 80	5
23	rondelle Ø int 17 / Ø ext 40 / ep 3	2
24	vis hexagonale M10 x 100	1
25	Ecrou M10	1

