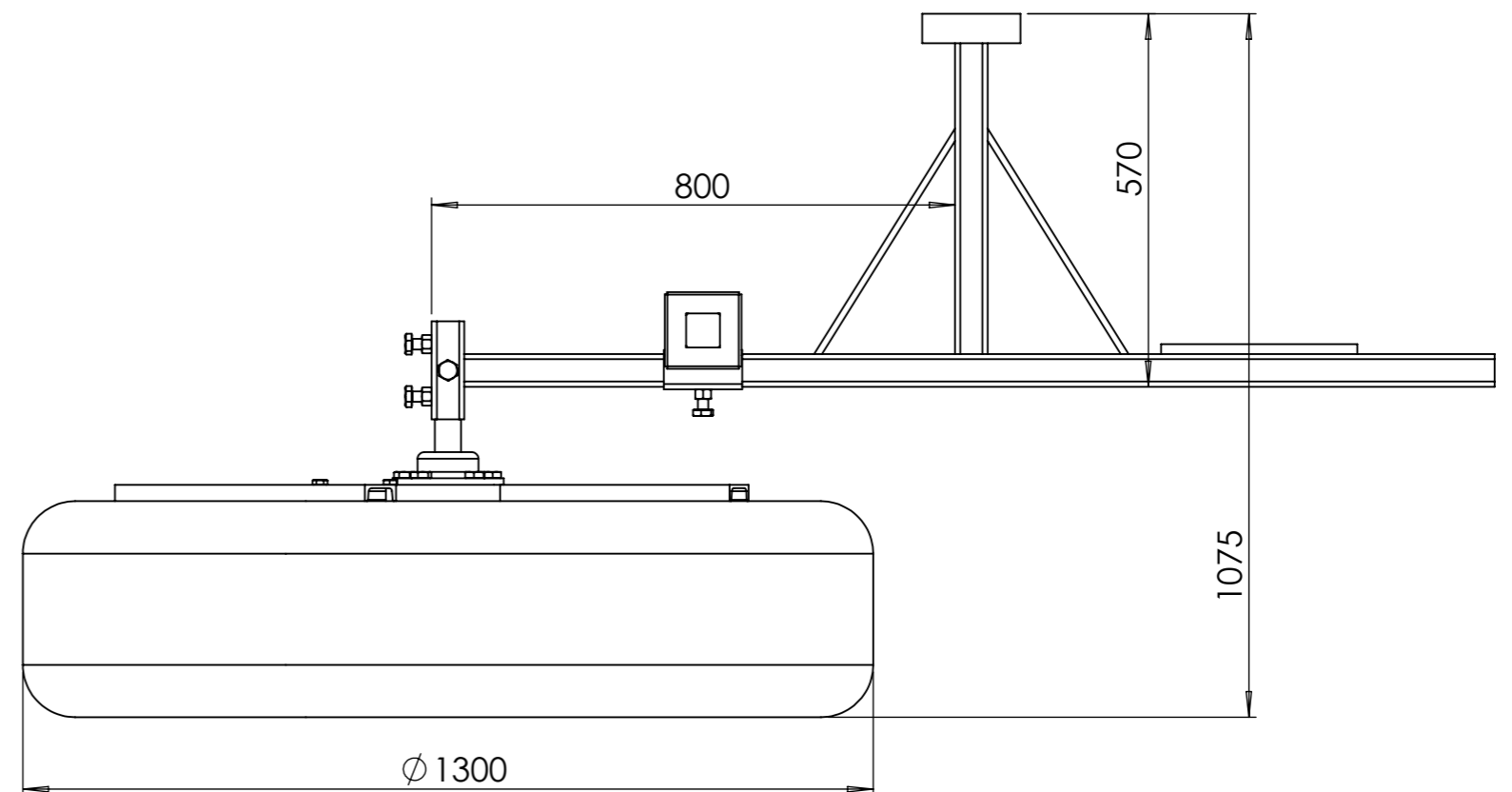
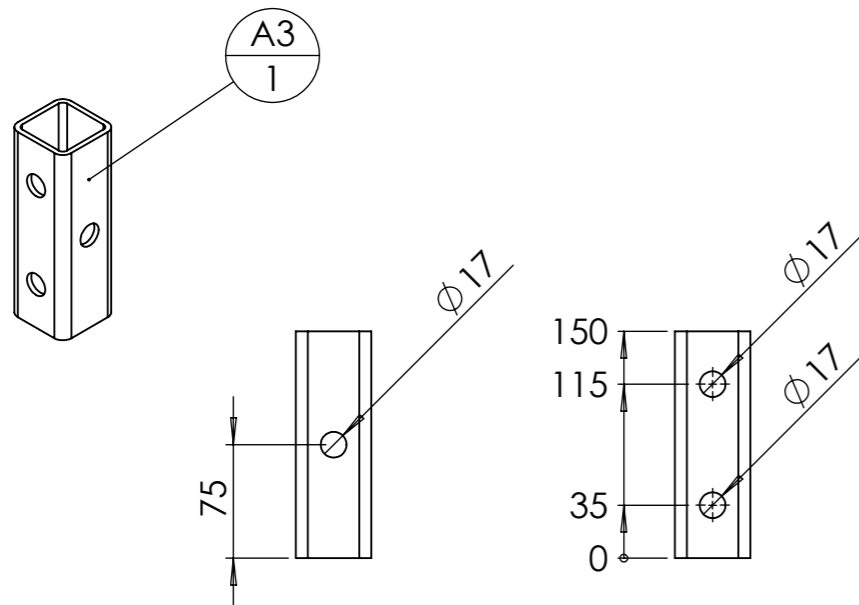
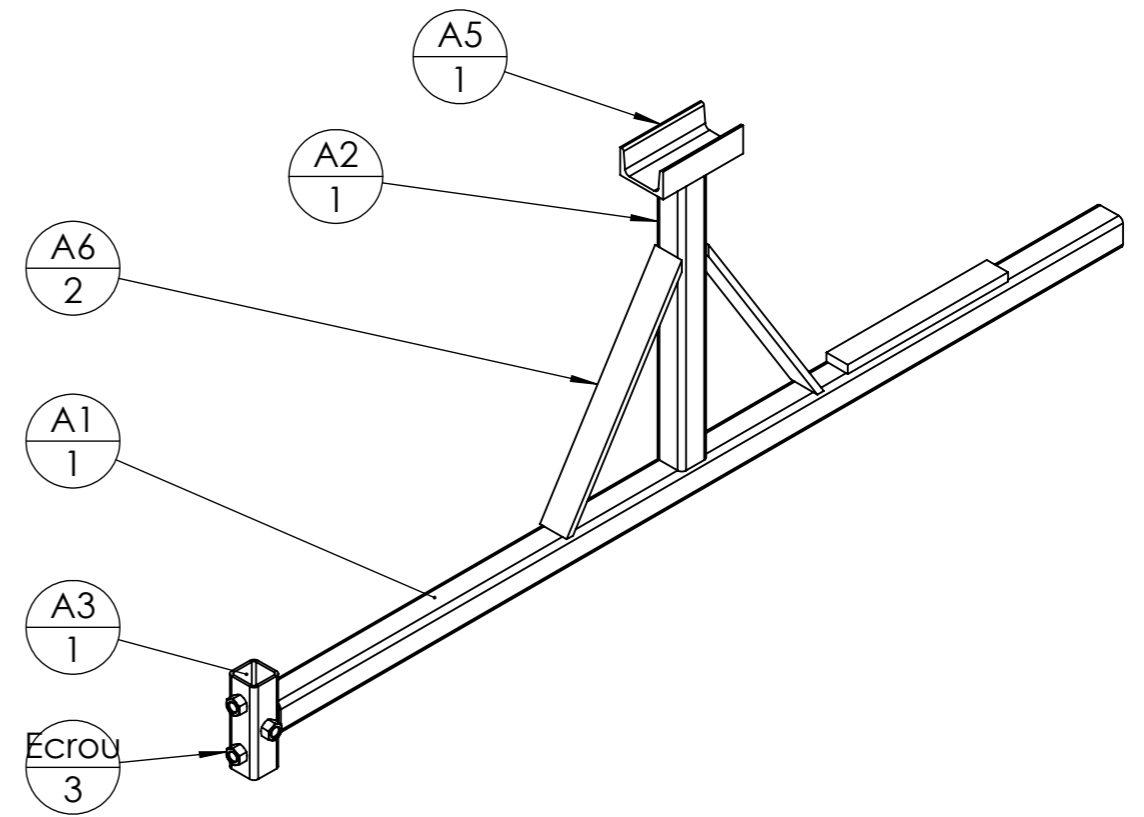
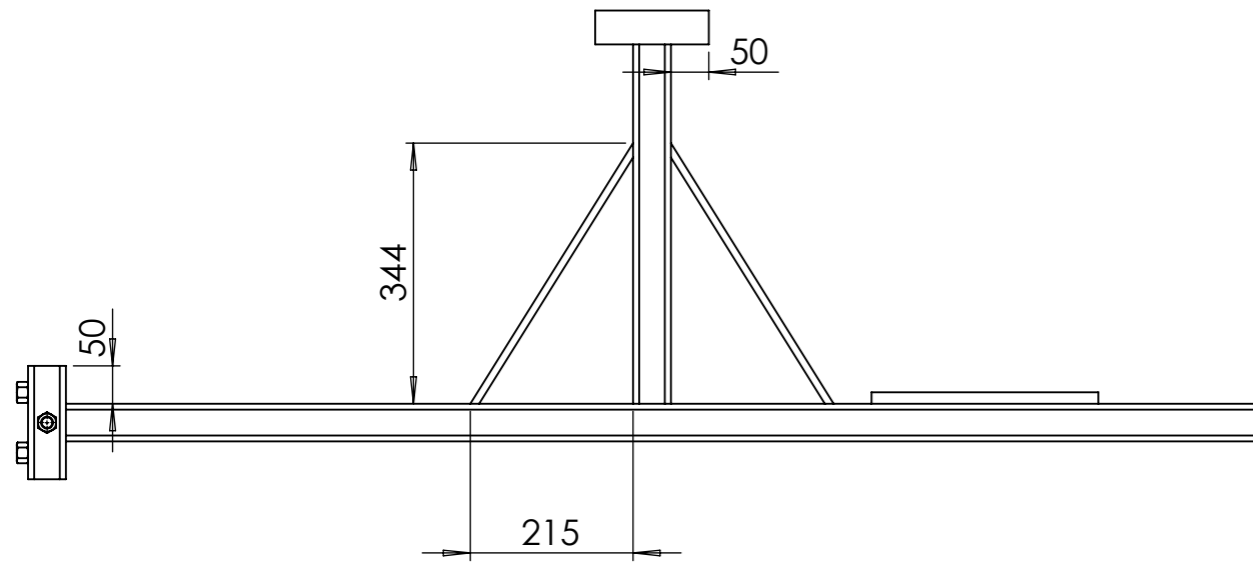

Table de nomenclature(restructuré)						
repère	Désignation	ANGLE1	ANGLE2	p	LONGUEUR	Quantité
A1	tube carré 50 x 4	0.00	0.00		1575	1
A2	tube carré 50 x 4	0.00	0.00		475	1
A3	tube carré 50 x 4	0.00	0.00	3x Ø17 ;	150	1
A5	UPN 80 x 45	0.00	0.00		150	1
A6	fer plat 50 x 10	57.99	32.01		406	2
B1	Fer U 50 x 25 x 5	0	18	1x Ø17 ; 1x Ø15 ;	532	5
Ecrou	Ecrou M14 autofreiné					10
Ecrou	Ecrou M16 brut					4
Essieu	Fusée d'essieu					1
Pneu	Pneu tracteur					1
A6	Fer plat 40 x 15	0.00	0.00		300	1
Vis Hexagonale	Vis hexagonale M16 x 35					9
Vis Hexagonale	Vis hexagonale M14 x 60					5
Rondelle	Rondelle Ø14 série LLU					5
C1	tube carré 60 x 4	0.00	0.00		400	1
C2	tube carré 60 x 4	0.00	0.00	Ø17	120	1
C3	Fer plat 50 x 5	30.00	30.00		110	8





ID	Description	Longueur	Qté
A3	tube carré 50 x 4	150	1
A1	tube carré 50 x 4	1575	1
A2	tube carré 50 x 4	475	1
A6	fer plat 50 x 10	406	2
A5	UPN 80 x 45	150	1
Ecrou	Ecrou M16 brut		3
A6	Fer plat 40 x 15	300	1

Outil	Repousse-Fourrage				
Date	18/02/2021	Version	1.0		page n° 3 / 5
Feuille	Etoile B				

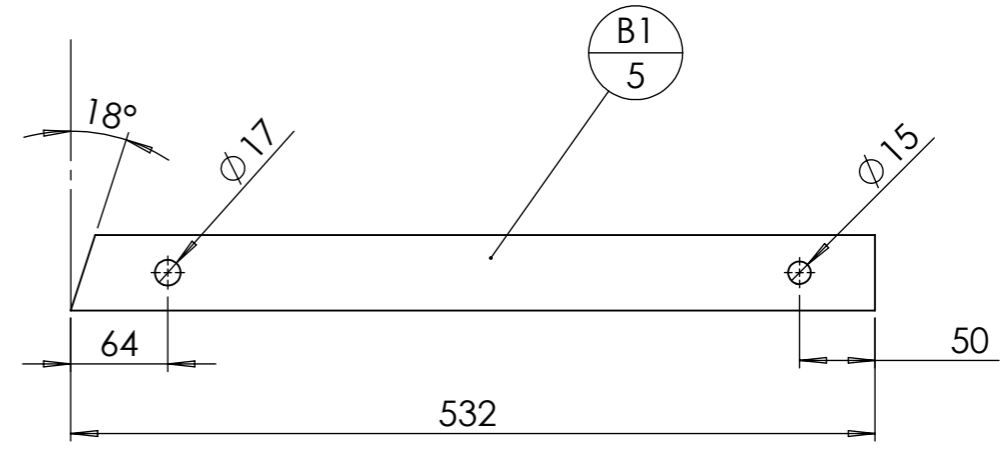
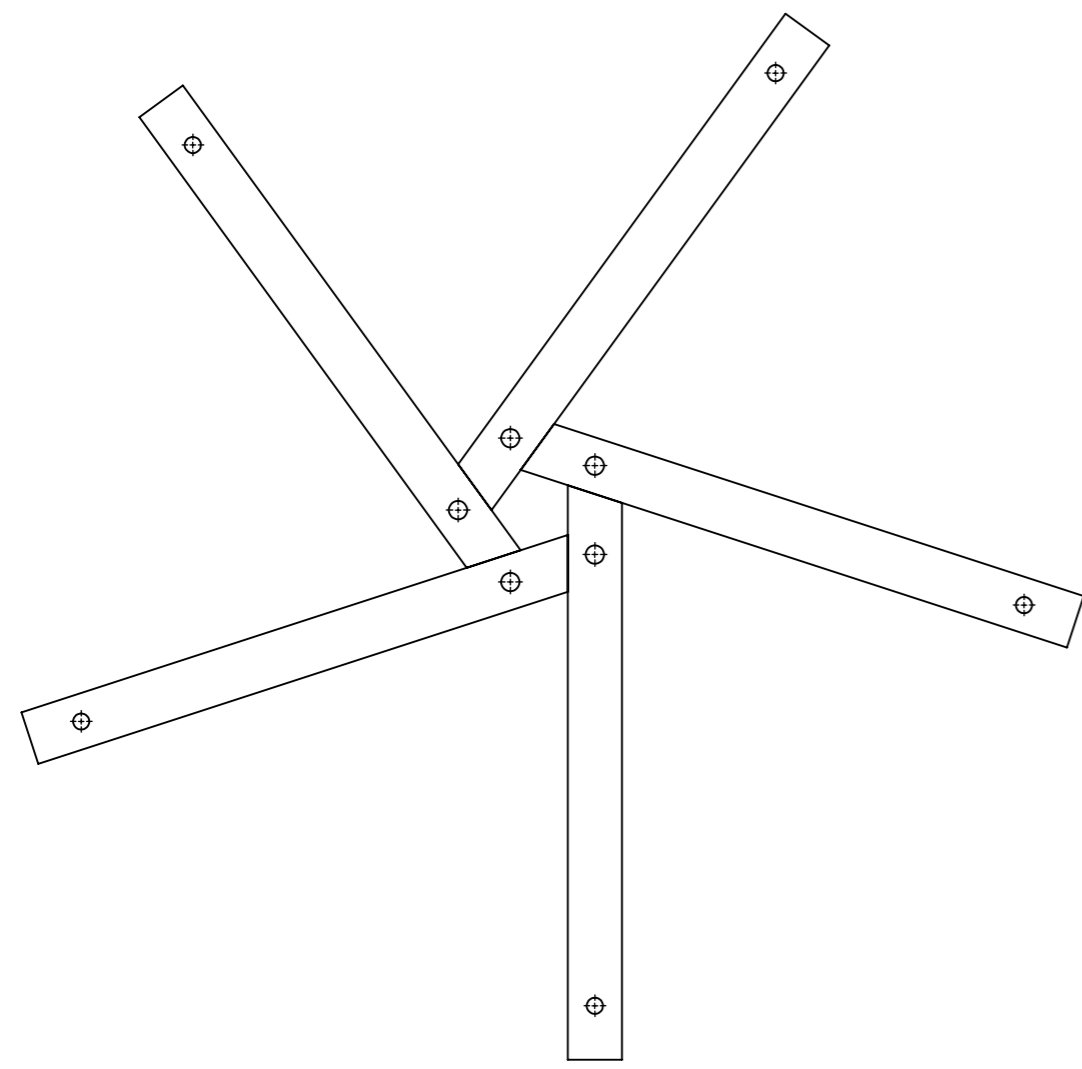
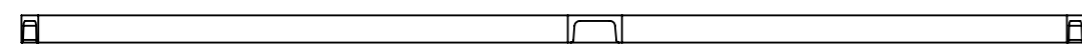
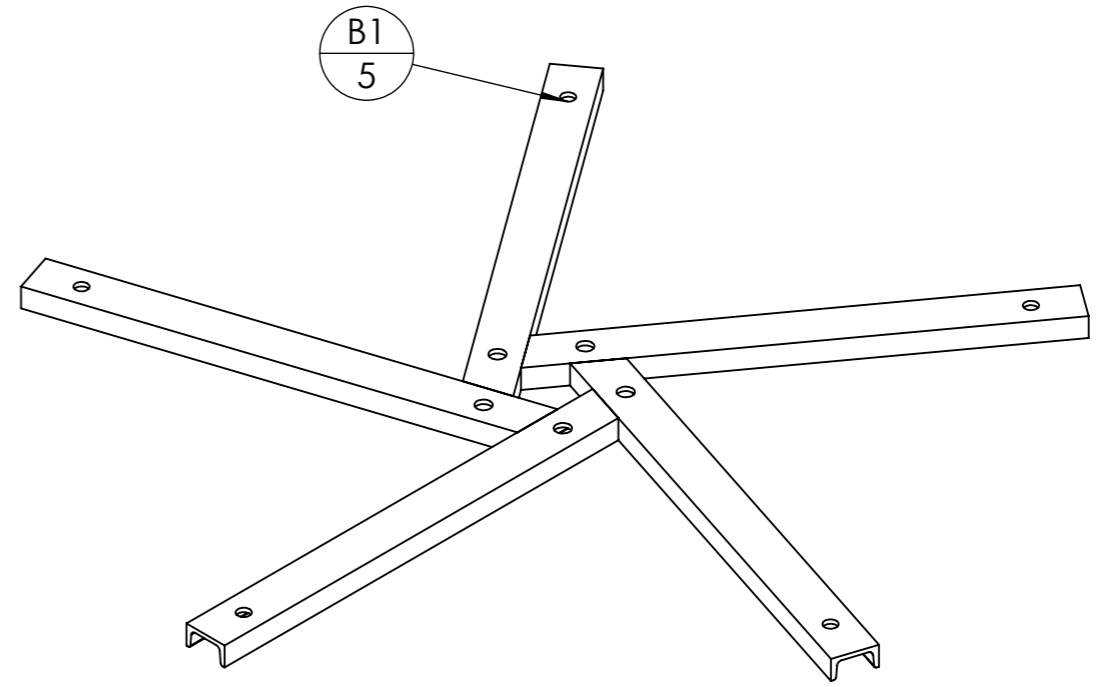

ID	Description	Longueur	Qté
B1	Fer U 50 x 25 x 5	532	5

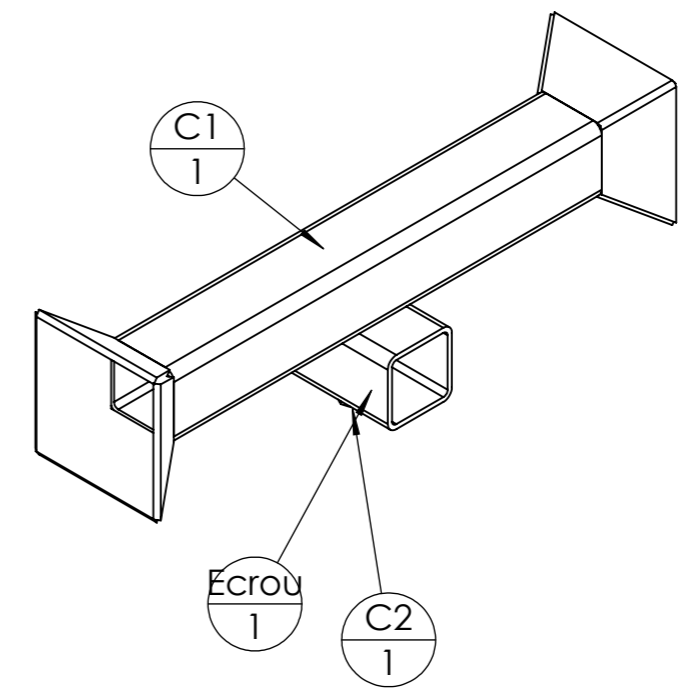
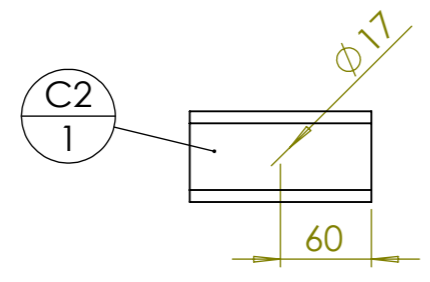
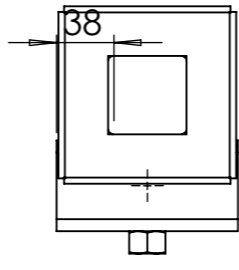
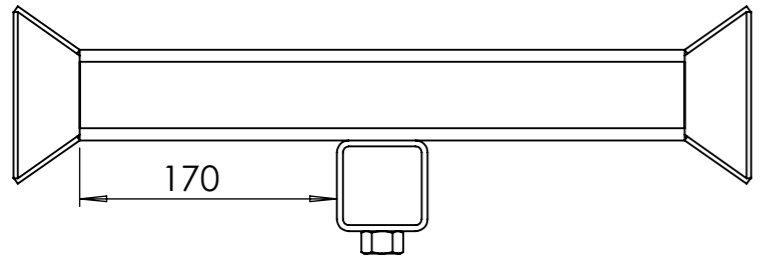

ID	Description	Longueur	Qté
C1	tube carré 60 x 4	400	1
C2	tube carré 60 x 4	120	1
Ecrou	Ecrou M16 brut		1
C3	Fer plat 50 x 5	110	8

Outil	Repousse-Fourrage				
Date	18/02/2021	Version	1.0		page n° 5 / 5
Feuille	Feuille 1				

