

Outil	Module9m <sup>2</sup>			<b>L'atelier paysan</b>	
Date	07/09/2020	Version	1.2		page n° 1 / 11
Feuille	cotes generales + pannes				

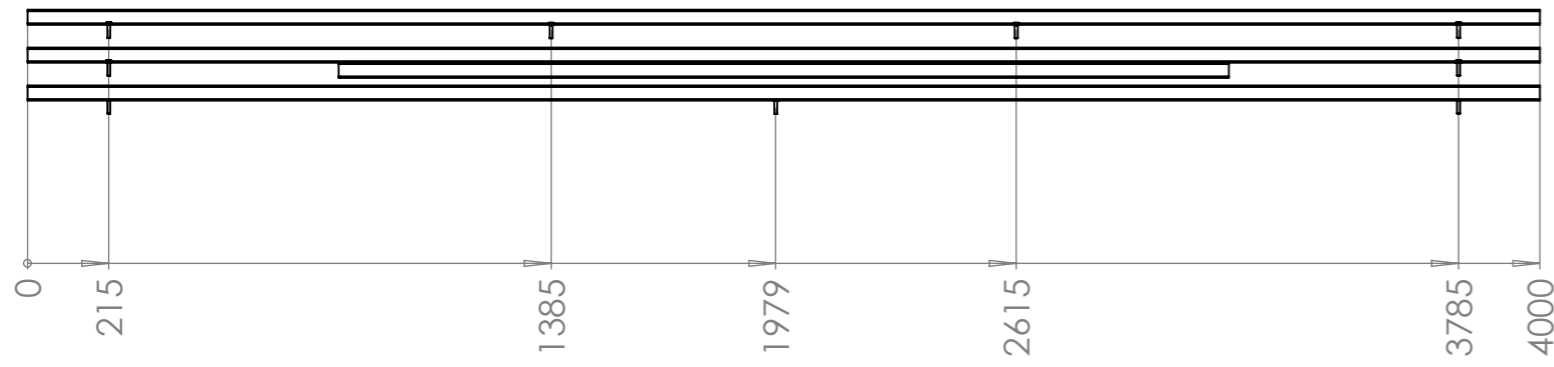

Ⓟ A

Ⓢ B

Ⓠ C

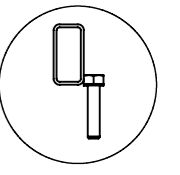
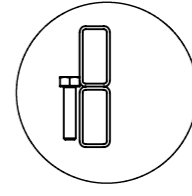
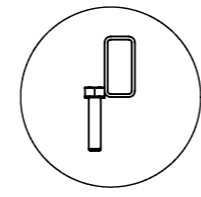

DÉTAIL A  
ECHELLE 1 : 5

DÉTAIL B  
ECHELLE 1 : 5

DÉTAIL C  
ECHELLE 1 : 5

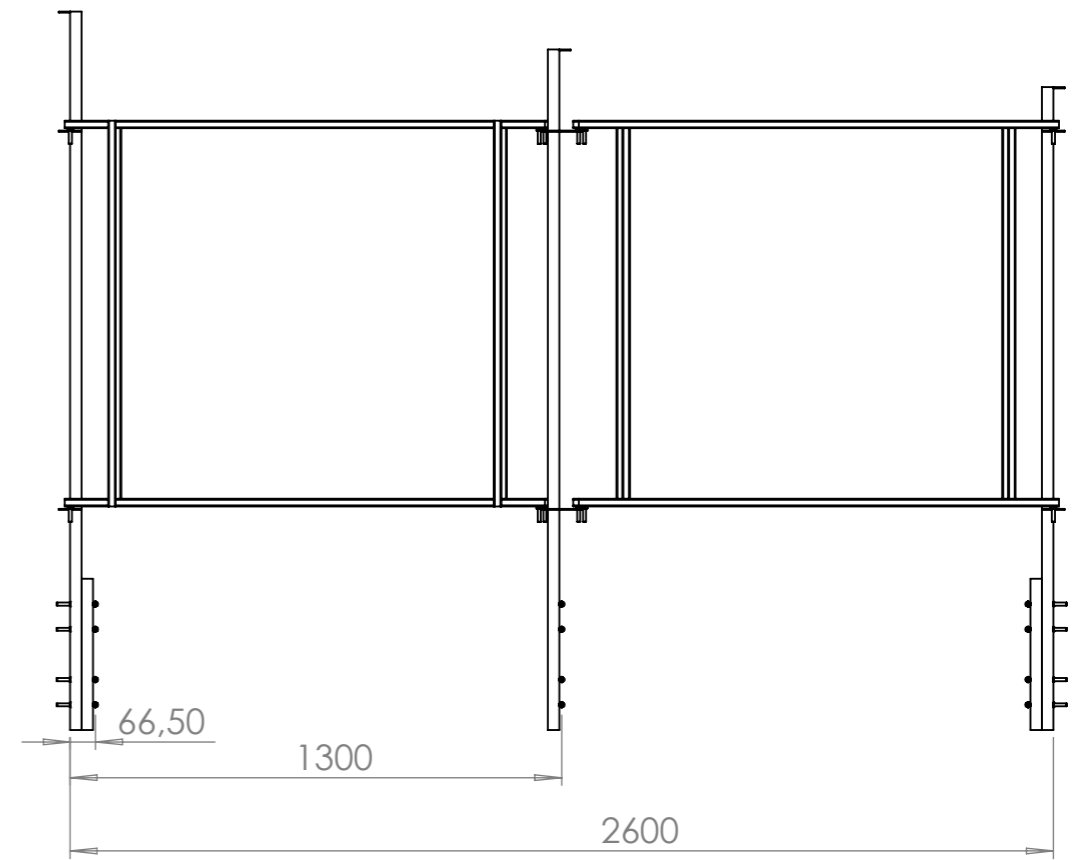
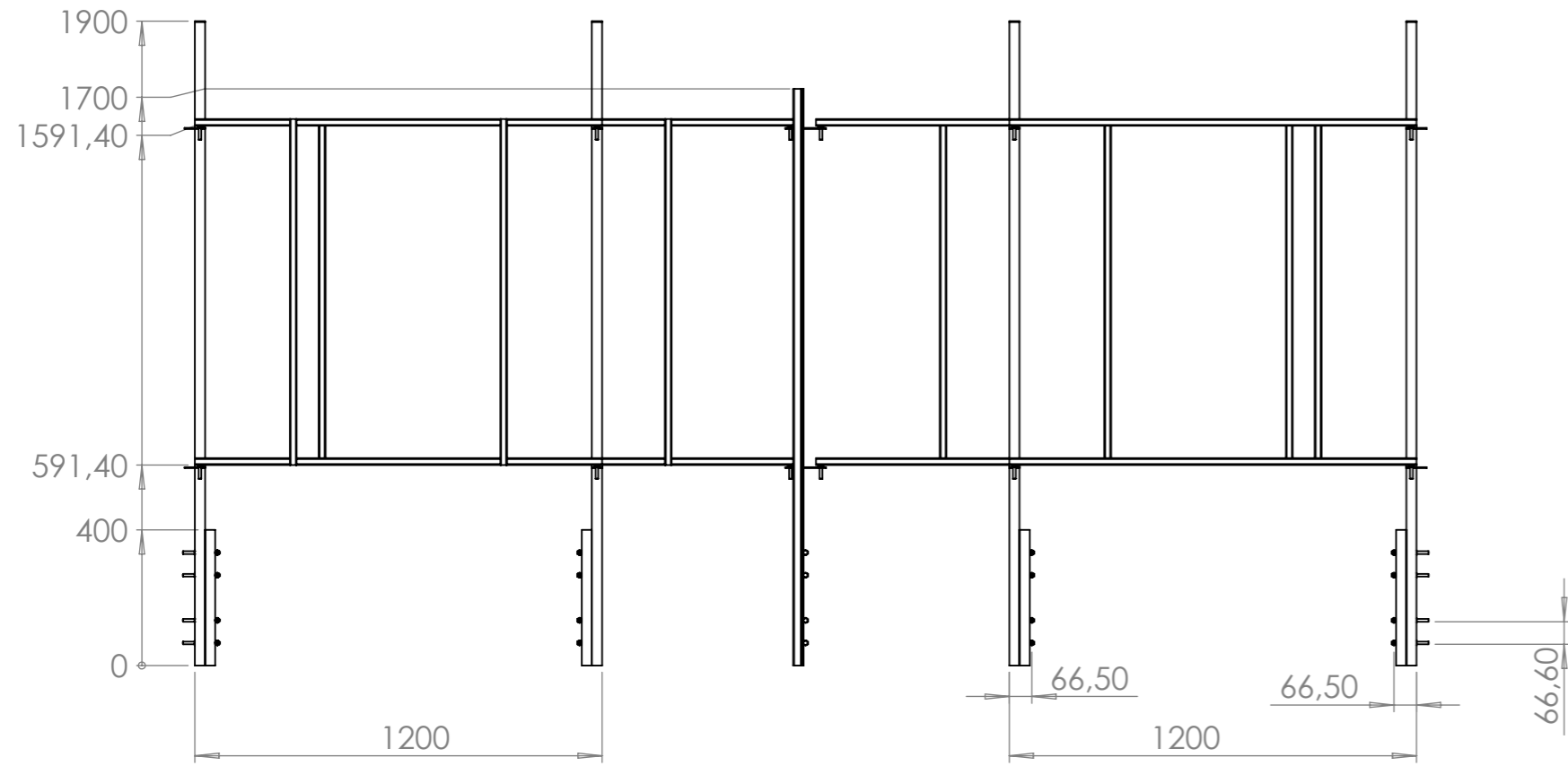

Outil	Module9m <sup>2</sup>		
Date	07/09/2020	Version	1.2
	page n° 2 / 11		
Feuille	vue en plan		

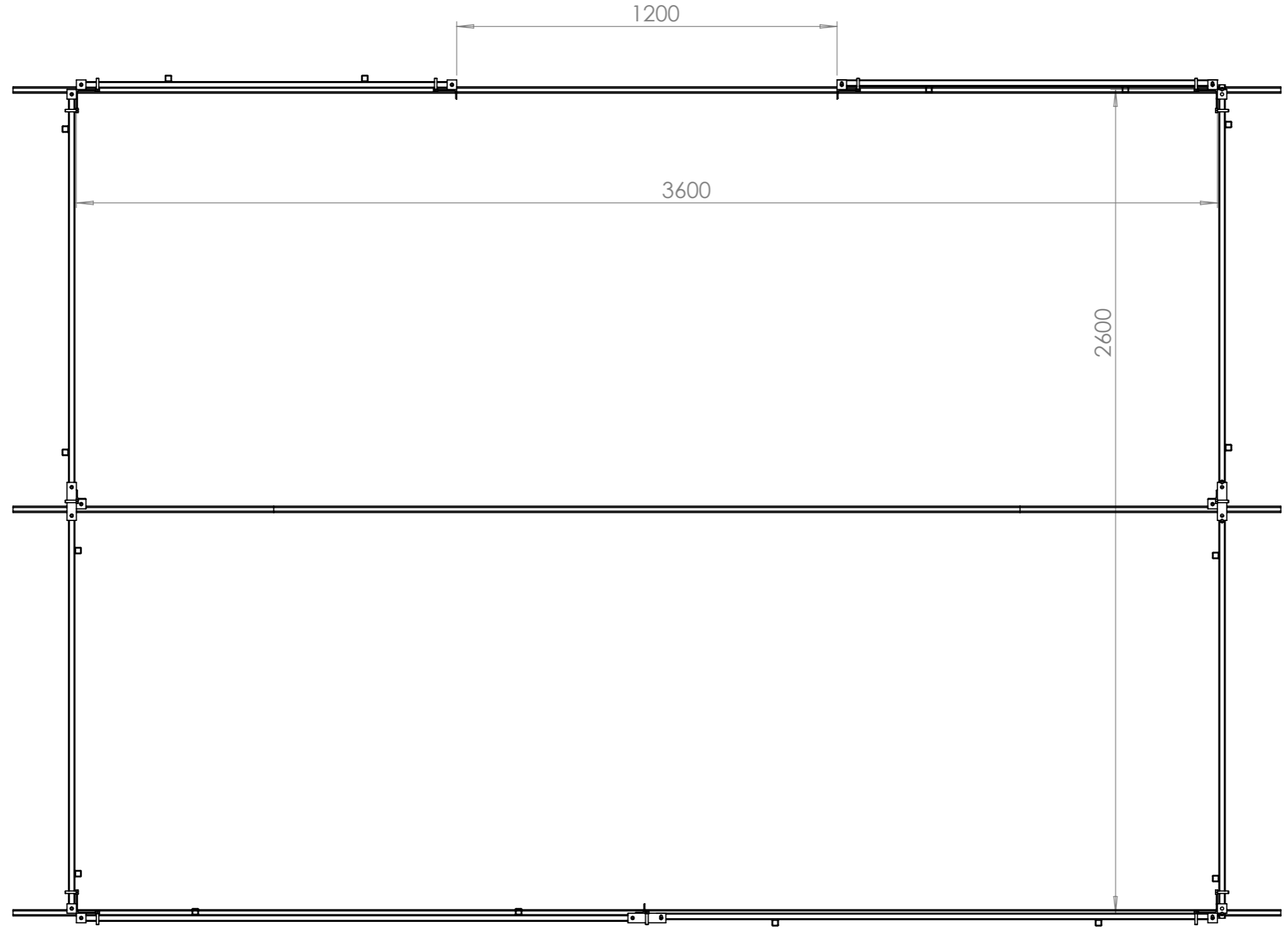

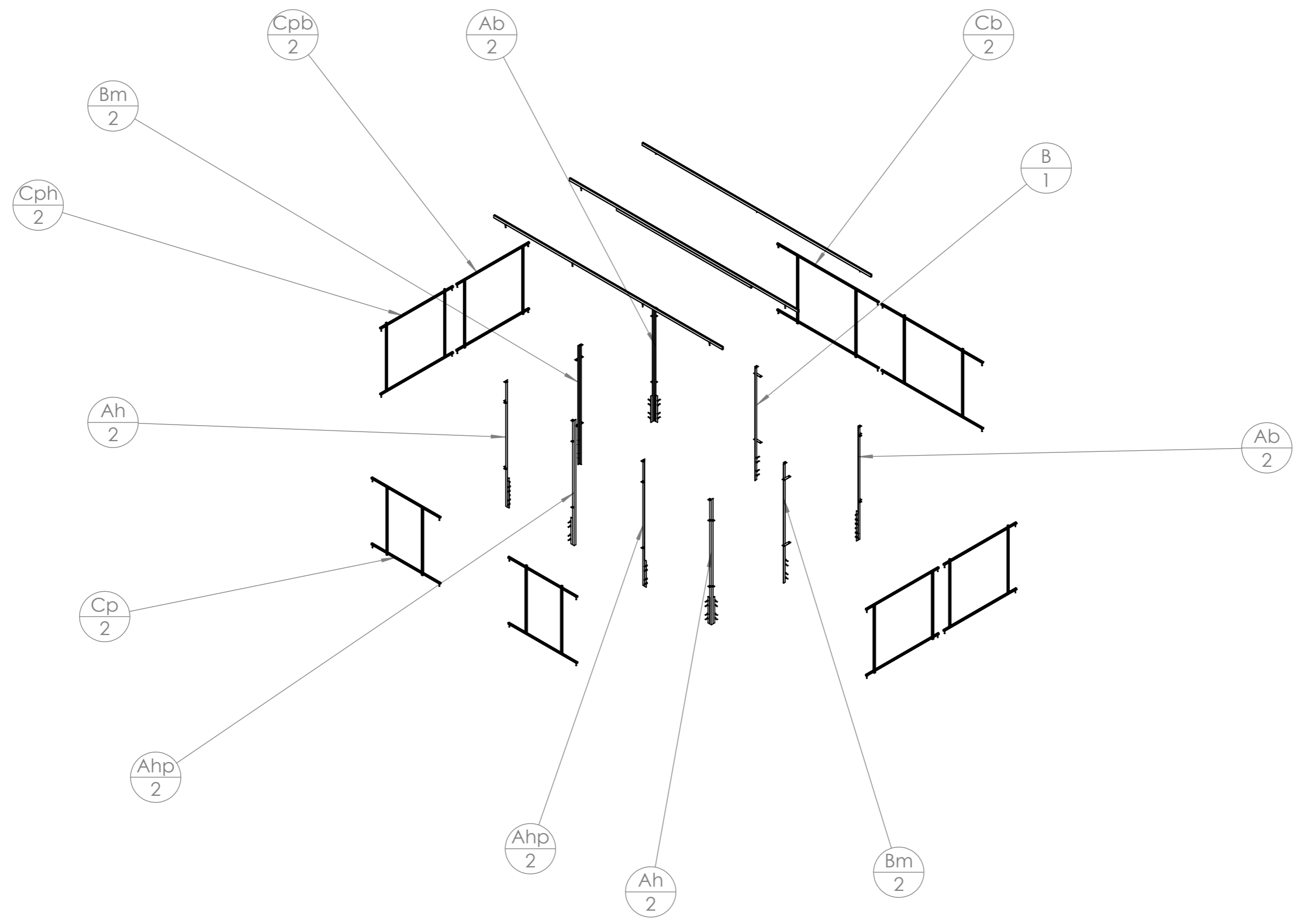

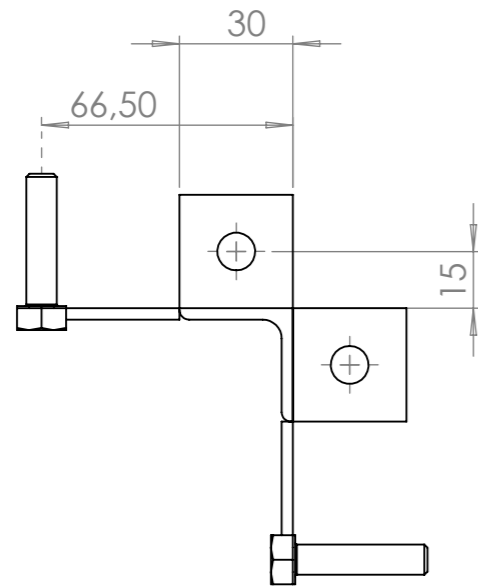

Fabriquer deux elements symetriques

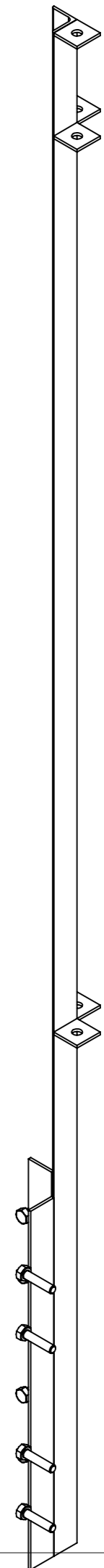
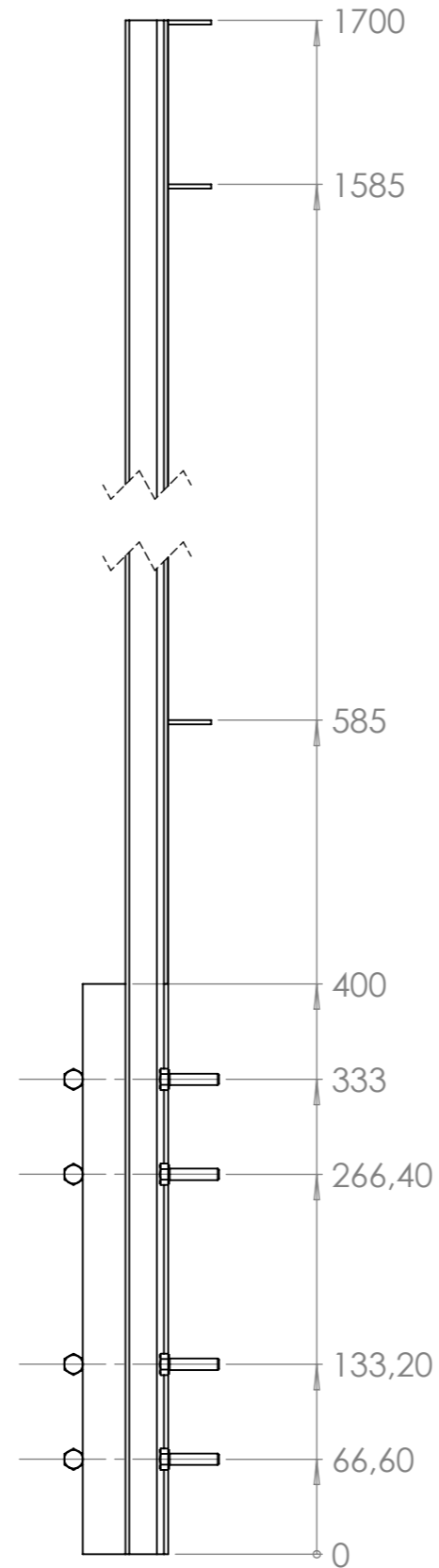
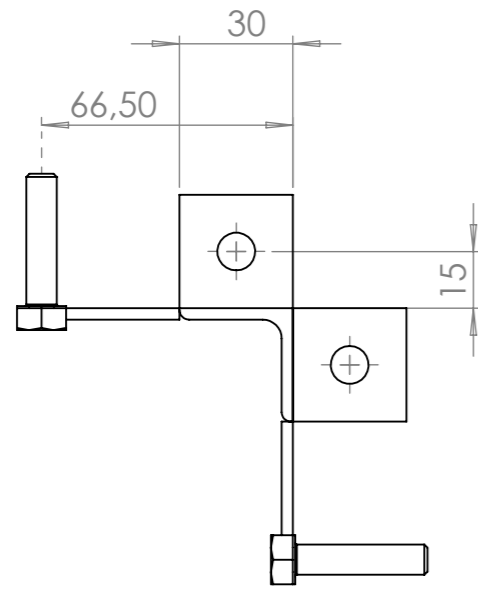
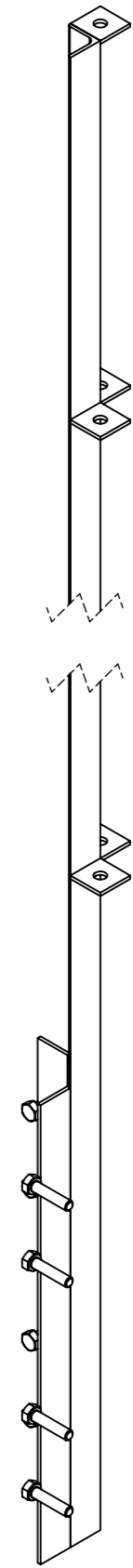
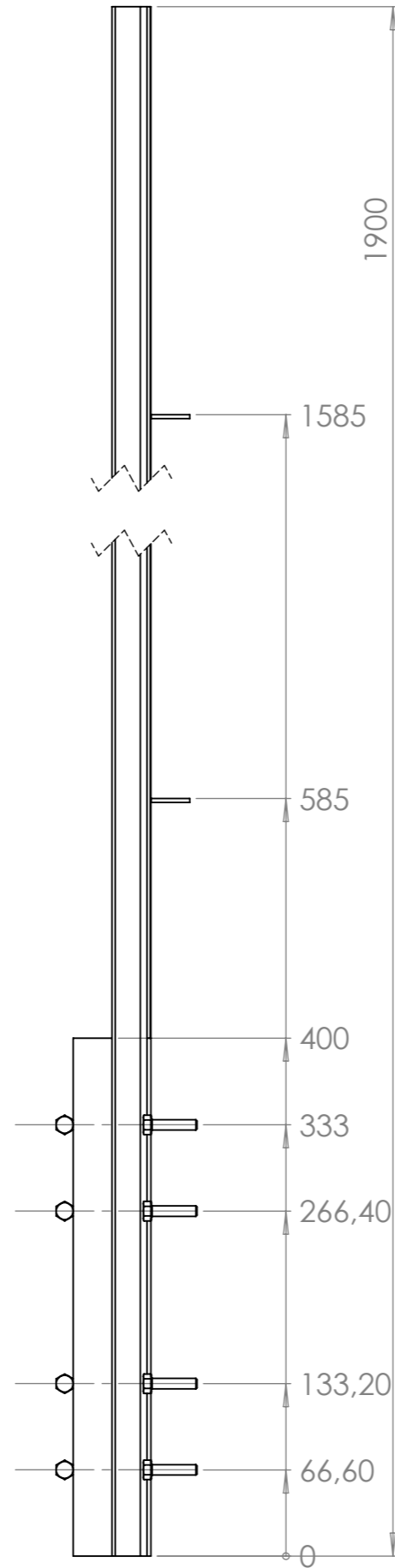

Table de nomenclature(restructuré)

rep	Désignation	ANGLE1	ANGLE2	p	Long.	Qté
A1b	Cornière 30 x 3	0.00	0.00		1700	1
A2b	Fer plat 30 x 3	0.00	0.00		400	2
A3	Vis hexagonale M8 x 35					8
A4	Fer plat 30 x 3	0.00	0.00		30	5



Fabriquer deux elements symetriques



rep	Désignation	ANGLE1	ANGLE2	p	Long.	Qté
A1h	Cornière 30 x 3	0.00	0.00		1900	1
A2h	Fer plat 30 x 3	0.00	0.00		400	2
A3	Vis hexagonale M8 x 35					8
A4	Fer plat 30 x 3	0.00	0.00		30	5

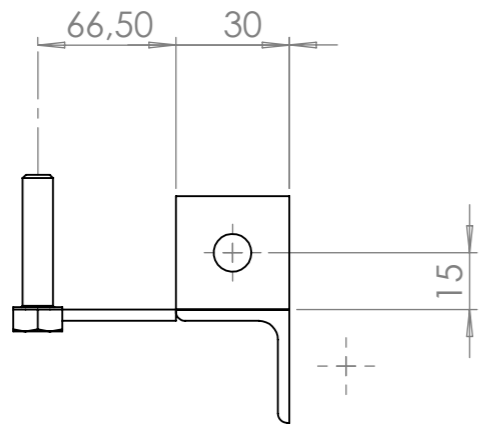

Fabriquer deux elements symetriques

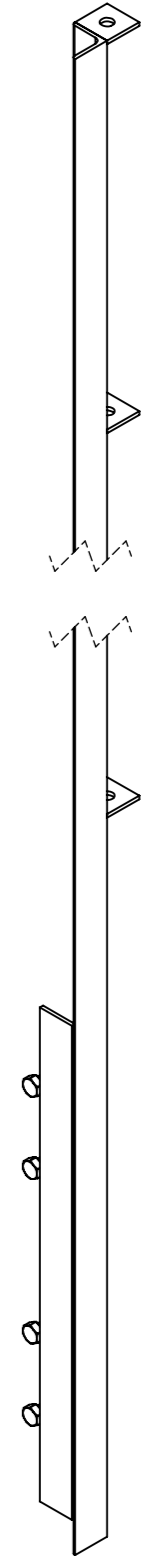
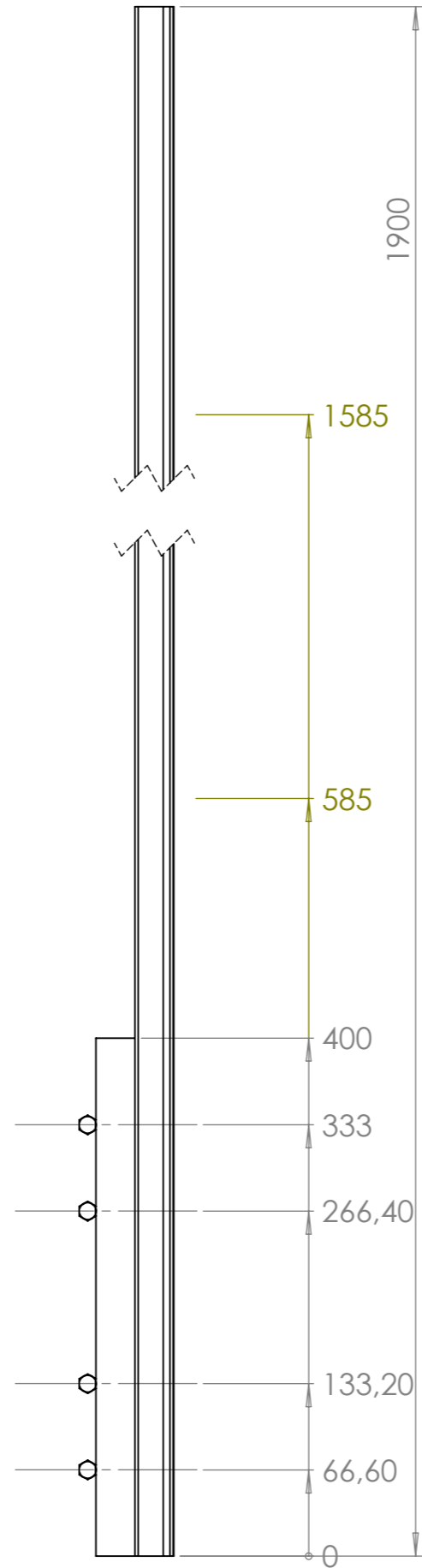

rep	Désignation	ANGLE1	ANGLE2	p	Long.	Qté
A1hp	Cornière 30 x 3	0.00	0.00		1900	1
A2hp	Fer plat 30 x 3	0.00	0.00		400	1
A3	Vis hexagonale M8 x 35					4
A4	Fer plat 30 x 3	0.00	0.00		30	3

Outil	Module9m <sup>2</sup>			<b>L'atelier paysan</b>	
Date	07/09/2020	Version	1.2		page n° 7 / 11
Feuille	Bm				

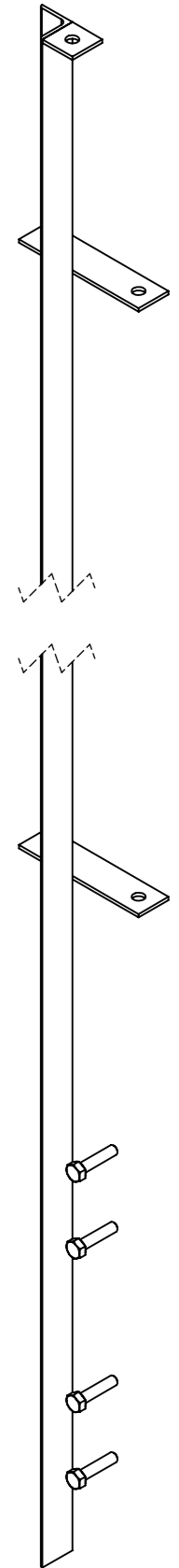
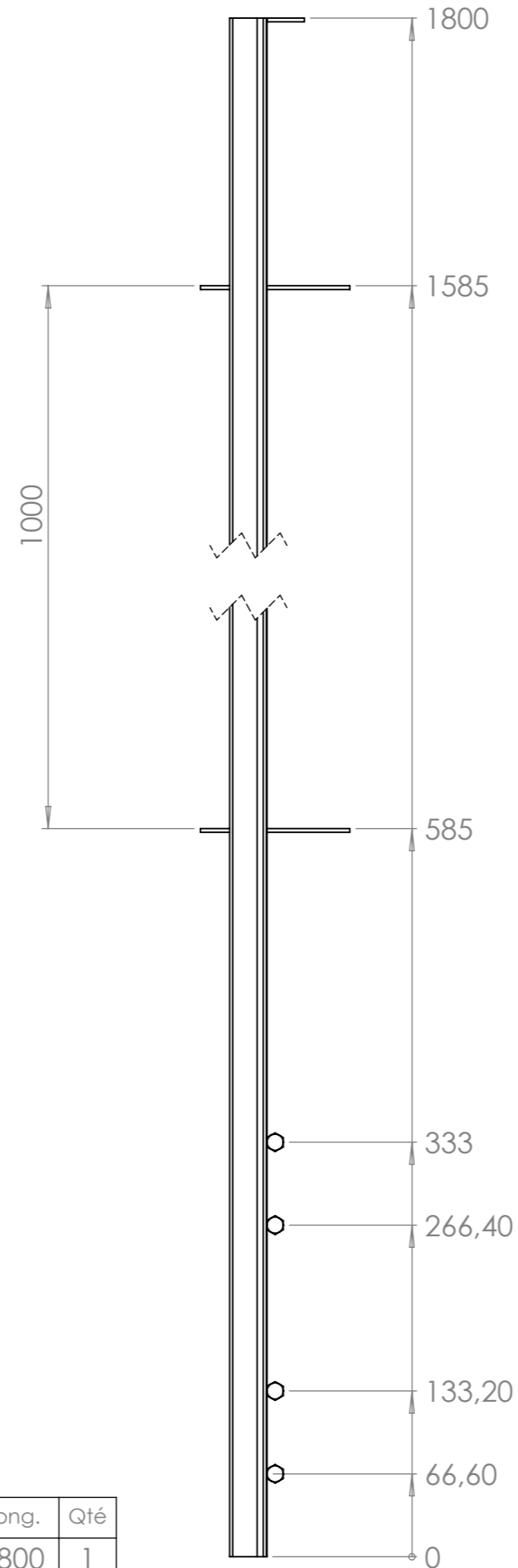

Fabriquer deux elements symetriques

rep	Désignation	ANGLE1	ANGLE2	p	Long.	Qté
B1m	Cornière 30 x 3	0.00	0.00		1800	1
B	Vis hexagonale M8 x 35					4
B	Fer plat 30 x 3	0.00	0.00		120	2
B	Fer plat 30 x 3	0.00	0.00		30	1

Outil	Module9m <sup>2</sup>				
Date	07/09/2020	Version	1.2		page n° 8 / 11
Feuille	Bbas				



Fabriquer un unique element

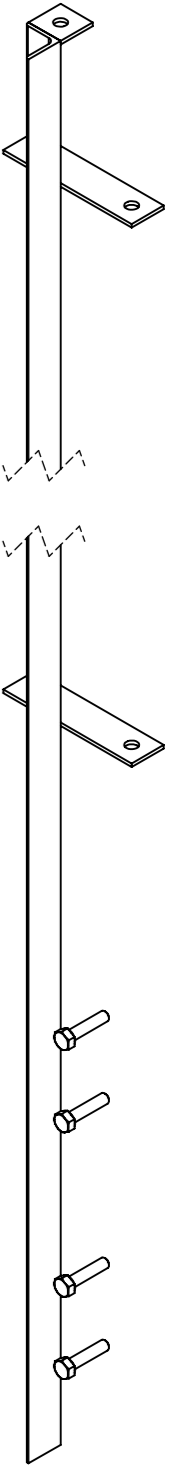
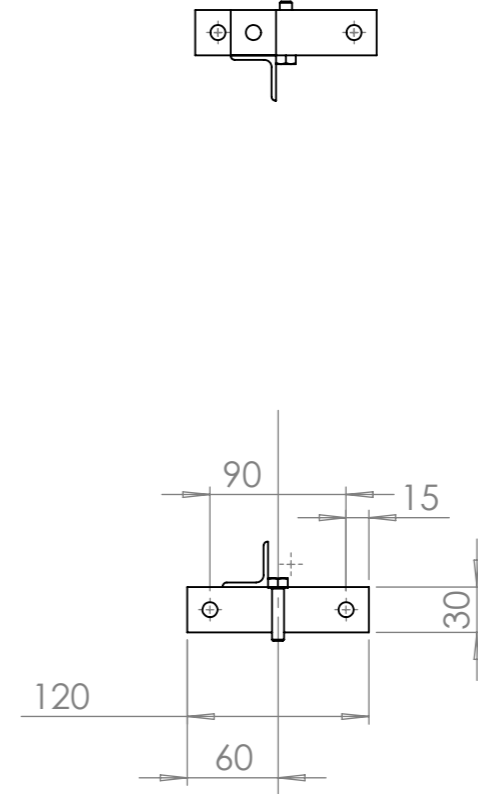
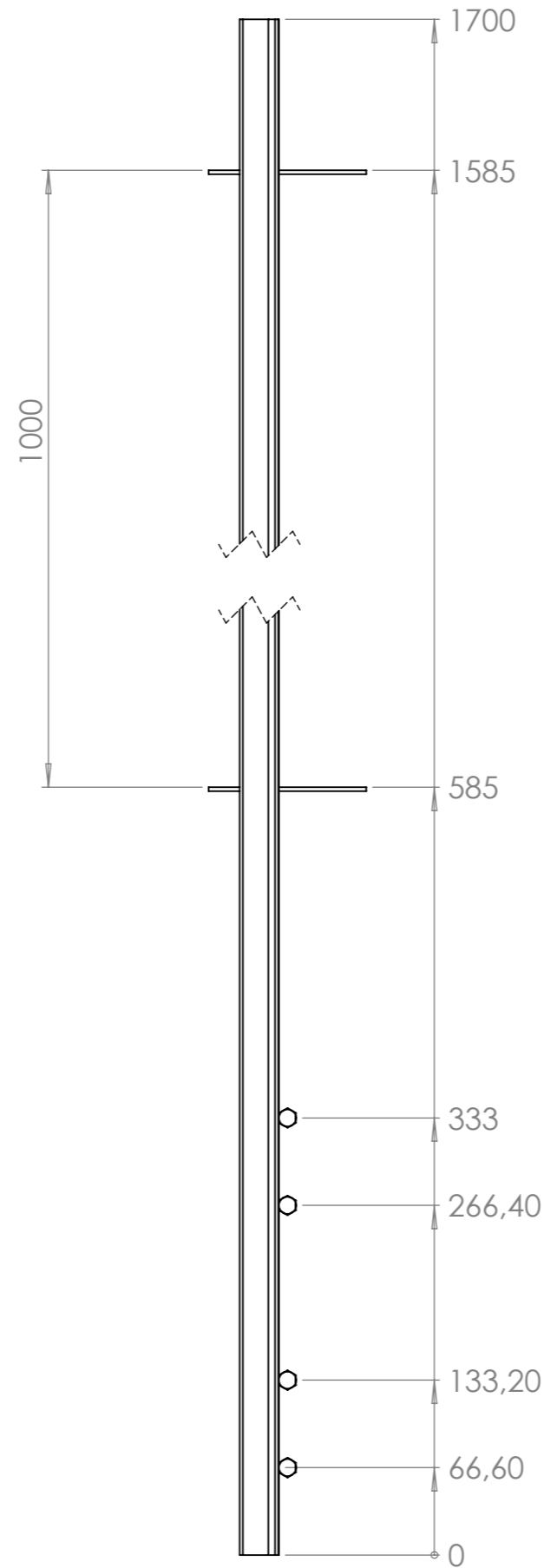

rep	Désignation	ANGLE1	ANGLE2	p	Long.	Qté
B1b	Cornière 30 x 3	0.00	0.00		1700	1
B	Vis hexagonale M8 x 35					4
B	Fer plat 30 x 3	0.00	0.00		120	2
B	Fer plat 30 x 3	0.00	0.00		30	1

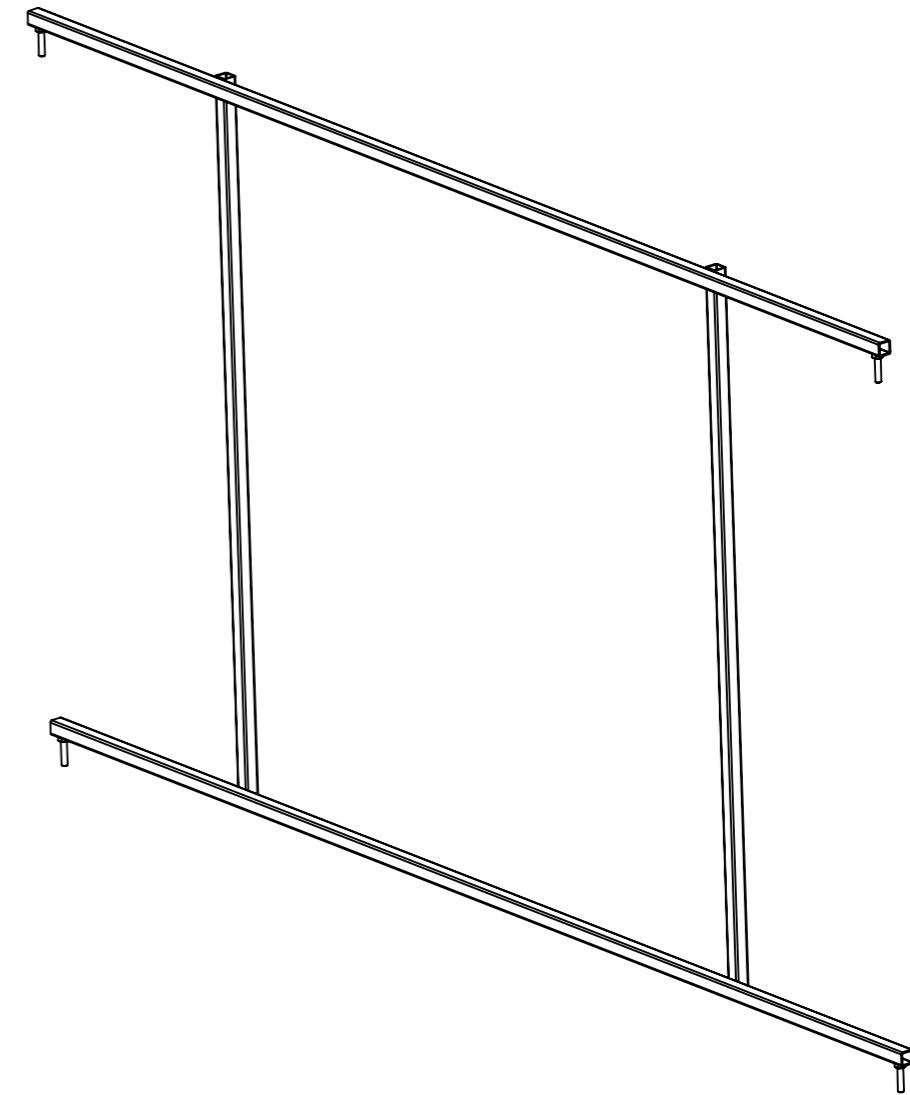
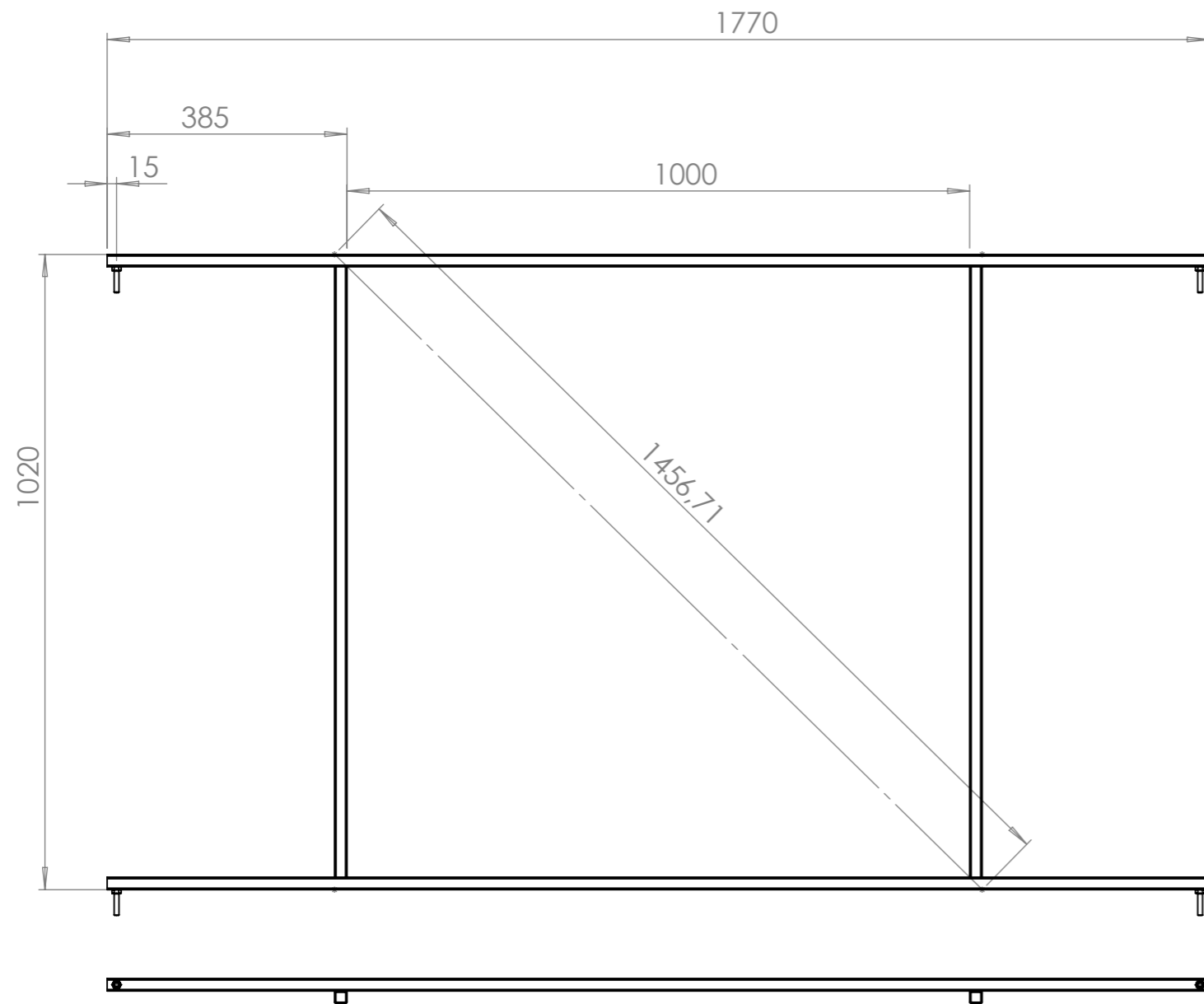

Fabriquer deux elements identiques

rep	Désignation	ANGLE1	ANGLE2	p	Long.	Qté
C1b	Tube carré 20 x 2	0.00	0.00		1770	2
C2b	Tube carré 20 x 2	0.00	0.00		1020	2
C	Vis hexagonale M8 x 35					4

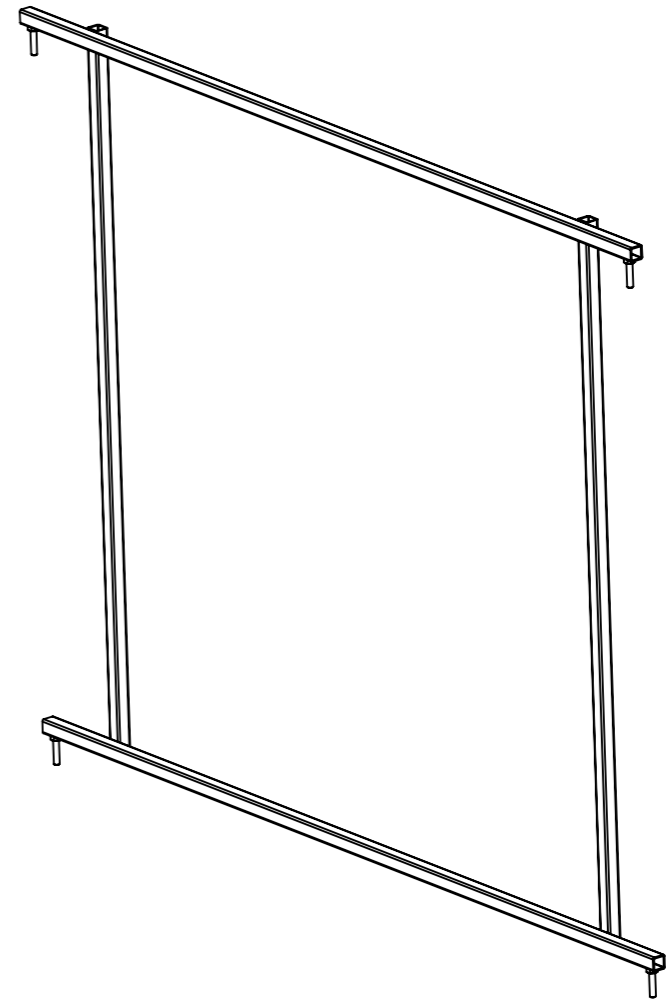
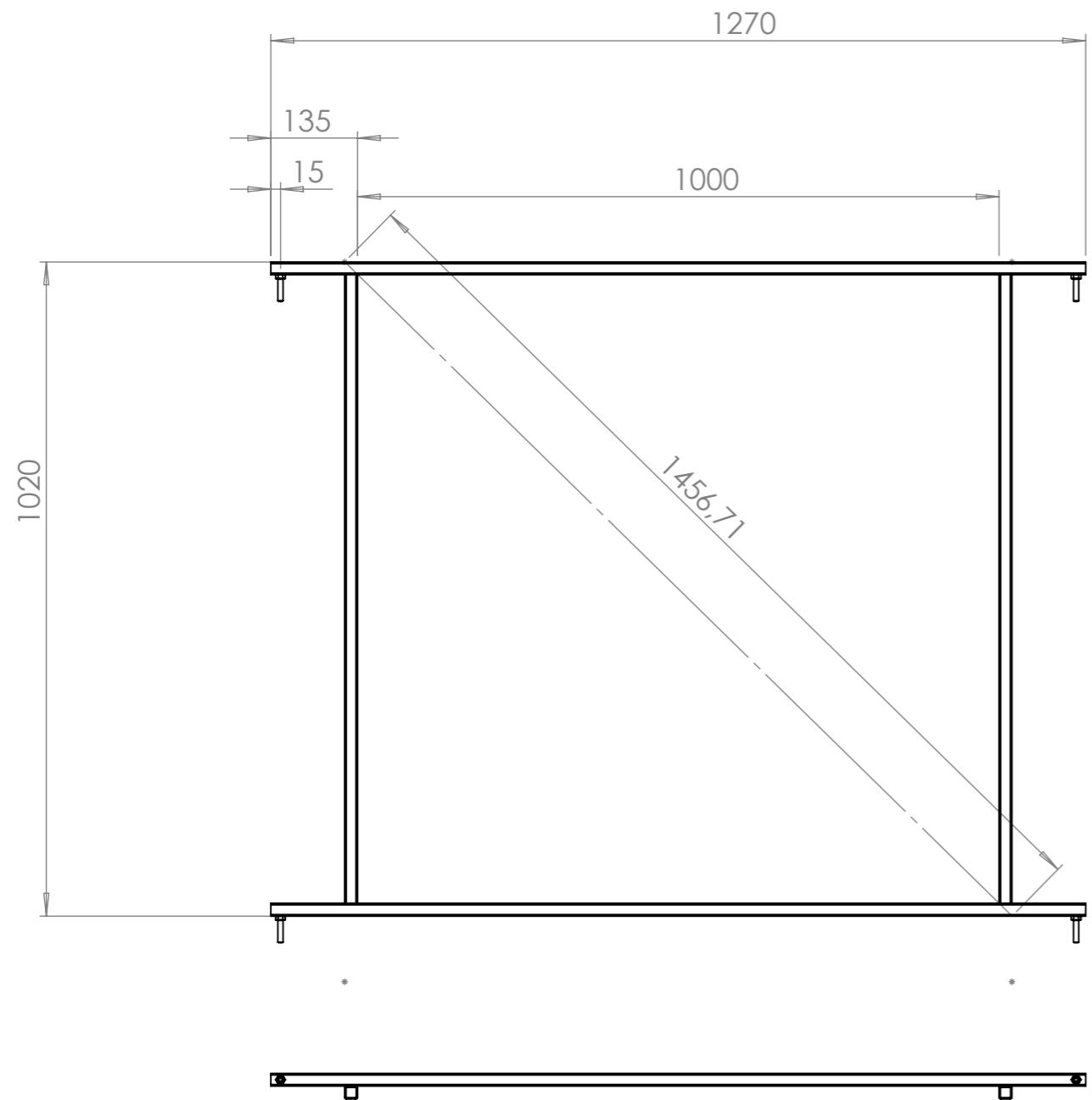

Fabriquer quatre elements symetriques

rep	Désignation	ANGLE1	ANGLE2	p	Long.	Qté
C1pb	Tube carré 20 x 2	0.00	0.00		1270	2
C2pb	Tube carré 20 x 2	0.00	0.00		1020	2
C	Vis hexagonale M8 x 35					4

Outil	Module9m <sup>2</sup>			<b>L'atelier paysan</b>	
Date	07/09/2020	Version	1.2		page n° 11 / 11
Feuille	Cp				

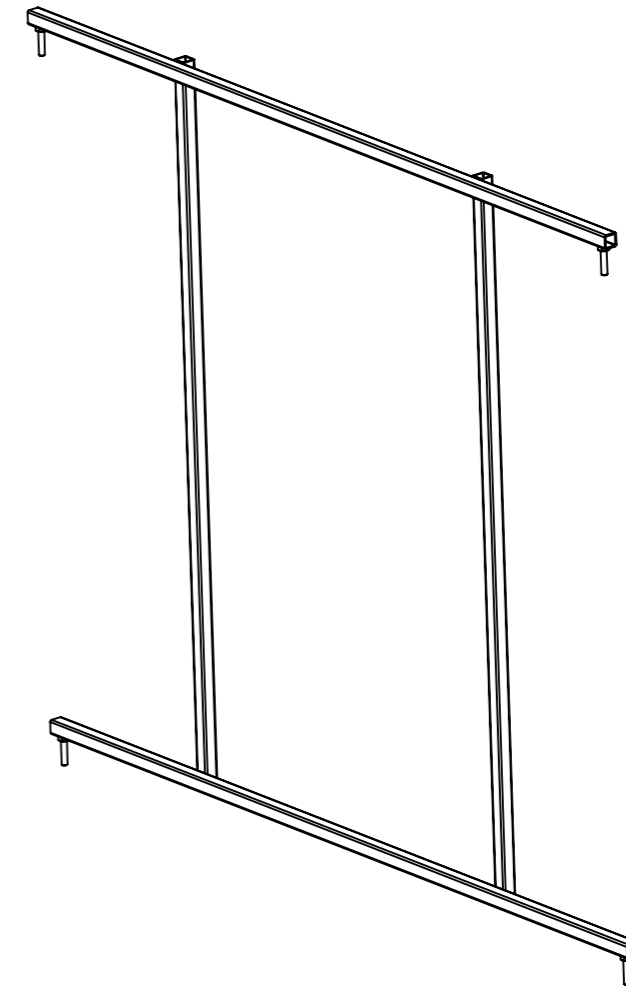
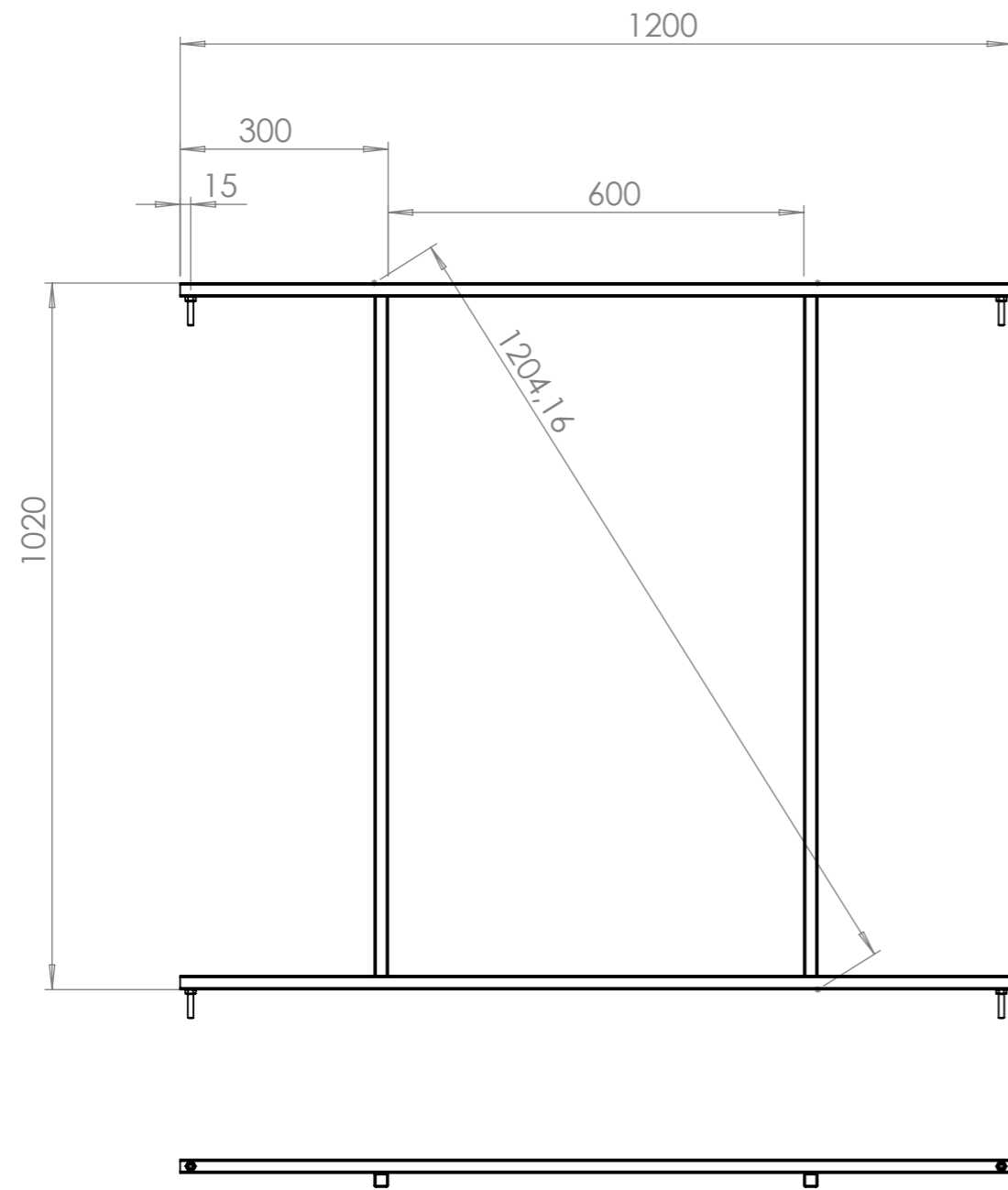

Fabriquer deux elements identiques

rep	Désignation	ANGLE1	ANGLE2	p	Long.	Qté
C1pb	Tube carré 20 x 2	0.00	0.00		1270	2
C2pb	Tube carré 20 x 2	0.00	0.00		1020	2
C	Vis hexagonale M8 x 35					4