

rouleau arrière<Brut d'usinage>

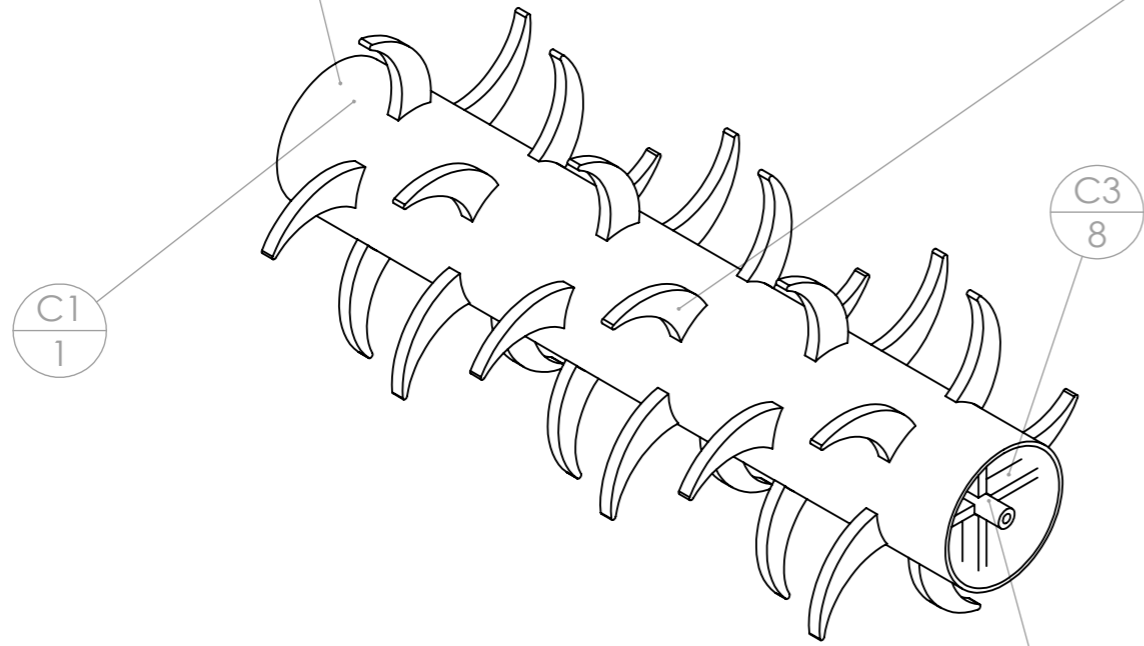

| repère | Désignation | LONGUEUR | Quantité |
|--------|---------------------------|----------|----------|
| C4 | dent rouleau décompacteur | | 30 |
| C3 | Fer plat 30 x 15 | 88 | 8 |
| C1 | Tube rond 219,1 x 6,3 | 1250 | 1 |
| C2 | étiré rond Ø30 | 1260 | 1 |

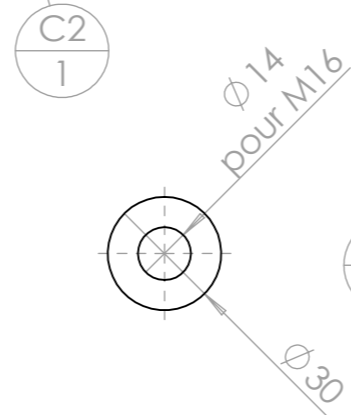
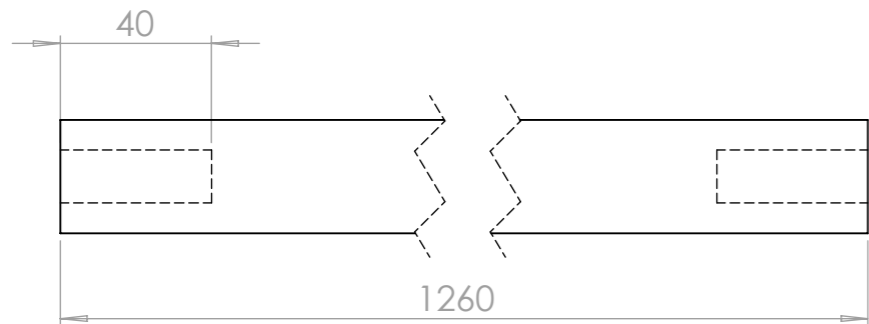

C4
30

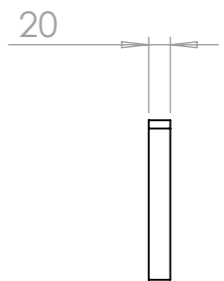
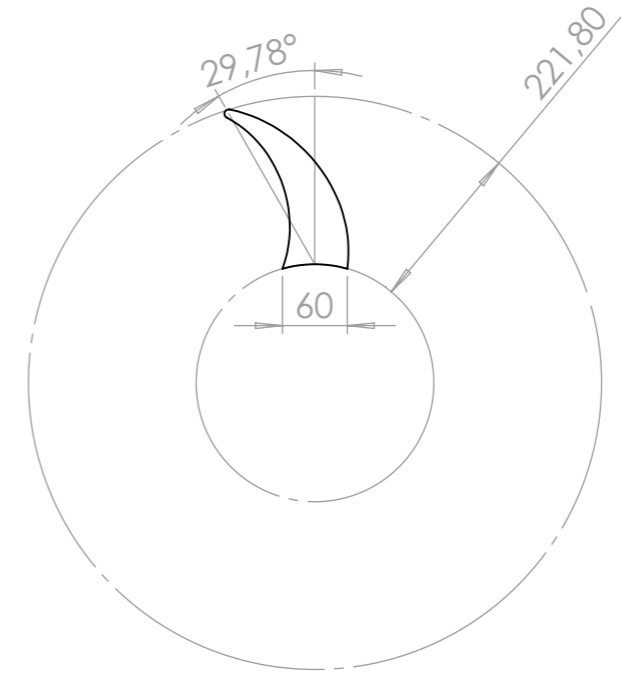

Acier S355

C4
35

rouleau avant<Brut d'usinage>

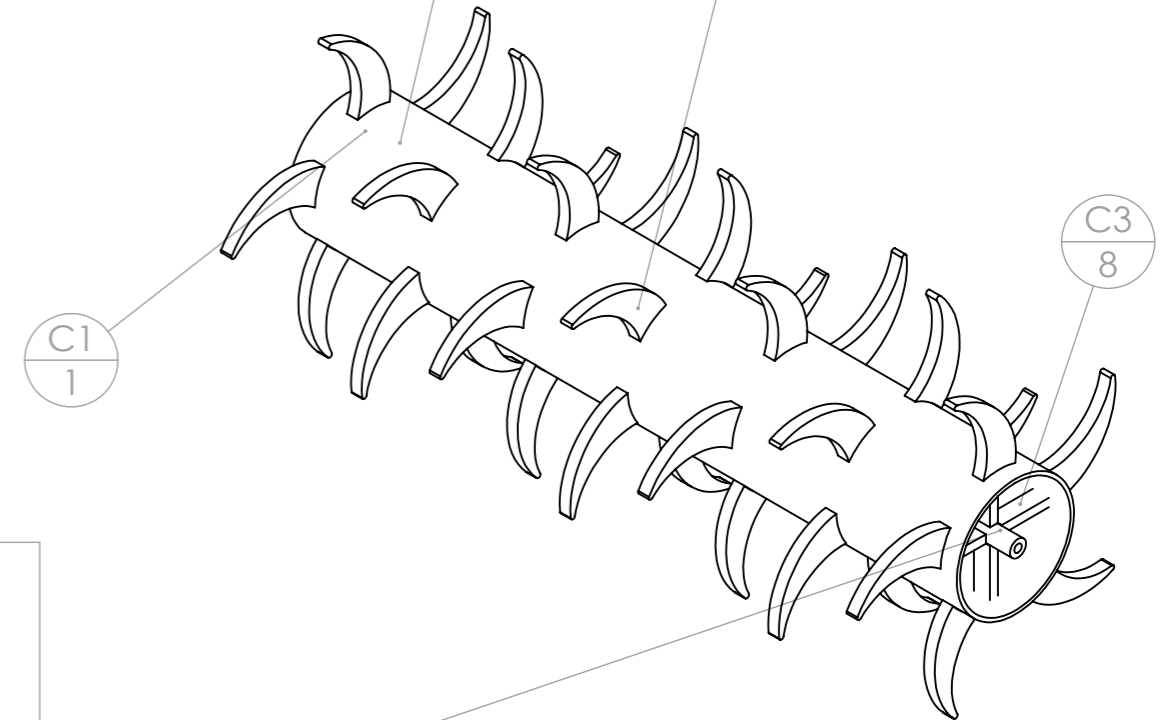

| repère | Désignation | LONGUEUR | Quantité |
|--------|---------------------------|----------|----------|
| C1 | Tube rond 219,1 x 6,3 | 1250 | 1 |
| C2 | étiré rond Ø30 | 1260 | 1 |
| C3 | Fer plat 30 x 15 | 88 | 8 |
| C4 | dent rouleau décompacteur | | 35 |